

ZX16-WM2/ZX16-WM2-SOi

Wall Mount · ZX16 Series



Product Features

- Up/Down wall sconce with mounting canopy.
- ETL outdoor wet location listed. IP65 standard.
- Machined from solid billet 6061-T6 corrosion resistant aluminum.
- Swivel stem insert allows for precision adjustment during installation.
- Unique weep hole design in hood of the up-light with minimum light leak.
- US patented integral SORAA® heat sink.

Integral SORAA® Heat Sink: US patented Thermobuster™ provides extra heat dissipation that reduces the lamp junction temperature by 77°F(25°C). Enables even the highest wattage SORAA® lamps to be used in an enclosed fixture without sacrificing its performance or life expectancy.

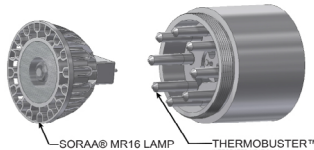

Specification

Materials: Machined from billet 6061-T6 corrosion resistant aluminum with 304 stainless steel hardware. Available in 304/316 stainless steel or 360 brass upon request.

Hood and Glare Shield: 3 available hood options to suit any application. 3 optional glare shields (short, long, angled) to complement each hood choice. See page 2 for details.

Light Source: MR16 Halogen lamp or MR16 SORAA® LED lamp. Please refer to [SORAA MR16 GU5-3](#) for lamp selection.

Voltage: 12V AC/DC. Requires remote step down transformer.

Wattage:
Max. 9W (x2) for SORAA MR16 lamp with Thermobuster.
Max. 35W (x2) for halogen MR16.

Lamp Base/Socket: Standard bi-pin socket for GU5.3/G4/GX5.3/GY6.35/GZ4.

Dimmability: MLV or ELV. Please refer to website for SORAA® MR16 dimmer compatibility. [SORAA MR16 dimmer compatibility](#).

Finish: Polyester powder coat on all aluminum materials with RoHS compliant procedures. Anodized finish is available. Stainless steel and brass models are provided with brushed surface.

Optical Accessories: Accepts up to 3 accessory pieces (hexcel louver, optical lenses, dichroic color filters, etc.). Secured in place with metal snap ring.

Mounting Accessory: Utilizes 2x 8-32 UNC machine screws (provided) to attach to a standard octagon recessed back box (provided by others).

Ordering Guide

EXAMPLE: ZX16-WM2-SOi - B - GSL - 00917 - 12V - BK - LVR - CM5
ZX16-WM2 - A - GSL - 0 - 12V - BK - LVR - CM5

| SERIES | MATERIAL | HOOD | OPTIONAL GLARE SHIELD | OPTIONAL LAMP | VOLTAGE | FINISH | OPTIONAL, SELECT UP TO 3 OPTIC ACCESSORIES | OPTIONAL MOUNTING ACCESSORIES |
|------------------------|---|----------------------|-----------------------|--|---------|---|---|---|
| | | | | | 12V | | | |
| ZX16-WM2 HALOGEN | BLANK Aluminum(Standard) NBR Natural Brass NSS Natural Stainless Steel CU Natural Copper | A A-HOOD B B-HOOD | GSL GSA GSS | 0-NONE XXXXXX SORAA® LAMP CODE (5 DIGIT SORAA CAT. NO*) | | Standard BK Black Powder Coat BZ Bronze Powder Coat WT White Powder Coat Premium ABK Anodized Black ACL Anodized Clear CC Custom Powder Coat | LVR Hexcel Louver OSL Overall Spread Lens LSL Linear Spread Lens SOL Solite Soft Focus DF Dichroic Filter | See page 2 for quick reference, or "Accessories" link for detailed specification. |
| ZX16-WM2-SOi SORAA® | | C C-HOOD | CGSL CGSA CGSS | | | | | |

*SORAA® Lamp Selection :
[SORAA MR16 GU5-3](#)

Remote Step Down Transformer (Optional).
See ["Accessories"](#) link for detailed specification.

| Model | Wattage(VA) | Primary Voltage(VAC) | Secondary Volt(VAC) | Dimming Method | Characters |
|-------|---------------------------|----------------------|---------------------------------|----------------|---|
| TXM | 20 40 60 100 150 300 | 120 or 277 | 12 | MLV | Outdoor, Wall Mount, Compact |
| TXS | 150 300 600 | 120 | Multi-tap of 12, 13, 14, 15 VAC | MLV | Outdoor, Wall mount, Stainless Steel Case |
| IGT | 50(120V only) 100 300 600 | 120 or 277 | 12 | MLV | in grade |
| TXE | 60 | 120, 230, or 277 | 12 | ELV | Needs Enclosure, 6ft working distance |

Product Drawings

NOTE: Specification and dimensions subject to change without notice.

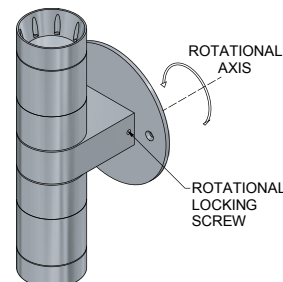
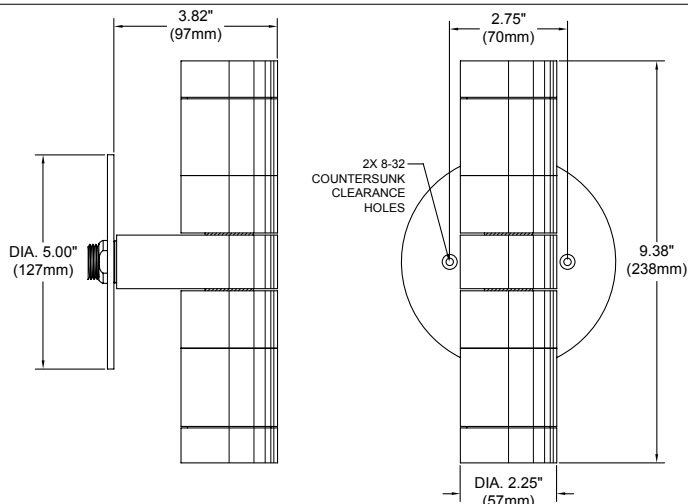

Photometry & Energy Data

All SORAA® MR16 GU5.3 base lamps can be used in this fixture.
Please refer to SORAA® website: [SORAA MR16 GU5-3](http://www.soraa.com)

Product Options & Accessories

Hood Options

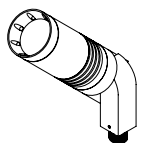

A-HOOD
Versatile hood with 8 weep holes for water drainage. Regressed lens for glare control. Suggested for general use or when fixture is aimed in an up position.

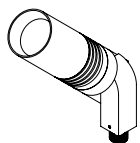

B-HOOD
Similar to A hood but without weep holes. Regressed lens for glare control. Used in an interior or down light application.

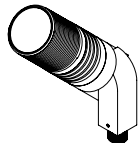

C-HOOD
Flush hood with machined threading on the outside for attachment of C-style glare shield, cleverly designed with hidden drainage channels.

Optional Glare Shield

For Use With A & B Hood
Fastened With Set Screw

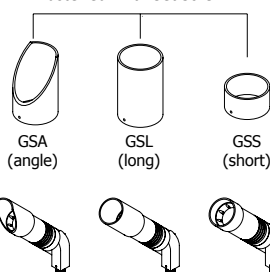

For Use With C Hood
Fastened With Locking Ring

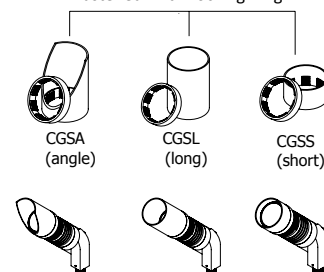

Mounting Accessories

Canopy Plate:



Fixture On CM5



CM2



CM1

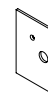

CM3



CM5

Surface Mount Box:



Fixture On CB5.1



CB3.5



CB4.0



CB4.0-SQ



CB5.1



CB5.5



CB5.5-K/O



CB5.5



CB5.5-K/O



CB5.5-K/O

Tree Mount:

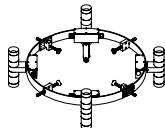

Fixture On TS-SO-26

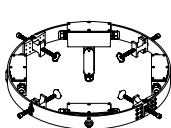

TS-SO

Notes