

References

KIM SP LED DIM0-10V

KIM SP LED DIMBT

Certificates



Class I

Dimmable:
120 - 277V

Bluetooth Dimming:
220 - 240V



Wood shade colours

- 20 Ivory White
- 21 Natural Cherry
- 22 Natural Beech
- 24 Yellow
- 25 Orange
- 26 Red
- 28 Blue
- 29 Grey
- 30 Turquoise
- 31 Chocolate
- 32 Pink

Awards



Chicago 2017



REF. KIM SP LED 20
Kim Small

Components



Diffuser
Matt satin acrylic

Wood
Birch Plywood



Metal canopy
Brushed Nickel
ø 17 cm - disc ø 23 cm

Electrical cable
Transparent
2 m drop

Steel cable
3 x 2 m drop



Box size
61 x 61 x 34 cm

Box volume
0,127 m³

Weight
Gross - 7,3 Kg
Net - 4,6 Kg

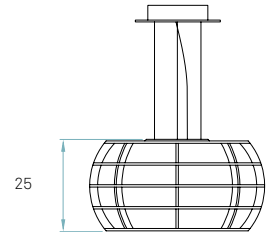

LED
 Circular Module
1 x 30 W 900mA

Energy class
 A+
LED integrated



Driver

- EFORE**
1 unit - Ref. RCL030-0700B
- EFORE**
1 unit - Ref. RCL030-0700B
+ Bluetooth Control - CASAMBI / ELT
1 unit - Ref. CBU - ASD

Driver housed in canopy.

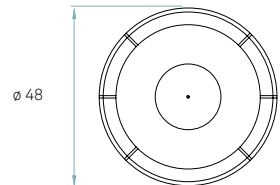

Details

Input Voltage	Luminous Flux	CRI	Watt.	CCT	Lifetime (L70)
120 - 277V / 220 - 240V	N/A	90	27 W	3000 K	40000h