

CTL802927LH

Optica Series 27W Dimmable LED Track Fixture with Horizontal Ballast

Specifications/Features

Fixture

Low wattage, eco-friendly, LED track fixture provides high lumen output with no infrared or ultraviolet radiation. Select from spot, medium and flood beam distributions. Dimming option allows illumination down to 10%. Die cast aluminum housing with horizontal driver. Precision aiming adjustment. 360°+ Horizontal rotation, 180° vertical rotation. Integral ON/OFF switch and track polarity indicator are standard. Will accept (1) LF18 lens.

Lamp

(7) LEDs, 1A constant current input; 27W/1700Lm total.
Color Temperature: 2700K (2725 ± 145)
3000K (3045 ± 175)
3500K (3465 ± 245)
4000K (3985 ± 275)

Electrical

Electronic driver: 120V AC primary and 1A secondary, 60Hz.
Input current: 0.35A max.

Warranty

This complete fixture is covered by ConTech's full five (5) year replacement guarantee after date of purchase.

Listing

cCSAus Certified to UL standards. Suitable for dry locations.

**DISCONTINUED ITEM:
LIMITED INVENTORY**
Consult Factory for Availability

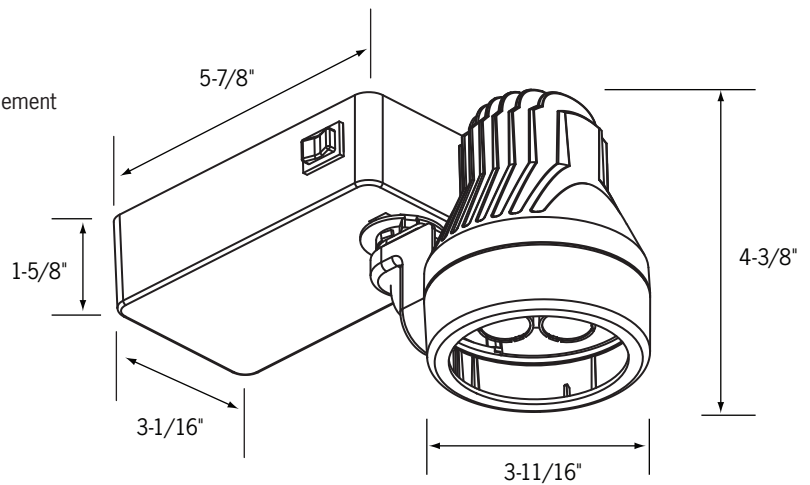

Ordering Information

Example Order: -

Fixture	Beam	Color Temp	Dimming Option	Finish	Accessories
CTL802927LH	S - Spot M - Medium F - Flood	27 - 2700K 3 - 3000K 35 - 3500K 4 - 4000K	N - No Dimming D - Dimming	B - Black P - White S - Silver	LA-35 - Black Honeycomb Louver LA-44-(B,P,S) - Egg Crate Louver LF18 - A, B, CL, G, LB, R, RO, Y, 73, LS, SL, UV 3-1/16" Dia. Tempered Glass Lenses

Color/Pattern Legend
-A (Amber), -B (Blue), -CL (Clear), -G (Green),
-LB (Light Blue), -R (Red), -RO (Rose),
-Y (Yellow), -73 (Spread Lens), -LS (Linear Spread Lens), -SL (Soft Light), -UV (Optivex UV Filter)

CTL802927LH

Optica Series 27W Dimmable LED Track Fixture with Horizontal Ballast

Photometrics

CTL802927LHS3

Designed for 50,000 Hour Lamp Life*; LM-63Test No. 80824

Light Output (Fixture Lumens): 1710
 Total Watts@120V: 26
 Lumens Per Watt: 66
 Color Rendering Index (CRI)¹: 81
 Color Temperature (CCT)²: 2992K Warm White
 Spectral Power Distribution Chart³
 LM-79 Test No. 80836

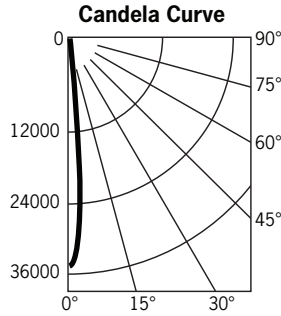
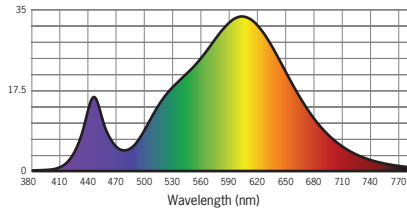

FROM 0	CANDELA	LUMENS
0	34569	
5	20594	1330
15	924	294
25	78	40
35	34	23
45	16	13
55	9	8
65	2	2
75	1	1
85	0	0
95	0	

DISTANCE (FT.)	FOOTCANDELES (FC)	BEAM DIAMETER (FT.)
6'	960.3	1.2
8'	540.1	1.6
10'	345.7	2.0
12'	240.1	2.4
14'	176.4	2.7
16'	135.0	3.1

Beam Distribution: 11°
 Spacing Criterion: 0.19

CTL802927LHM3

Designed for 50,000 Hour Lamp Life*; LM-63Test No. 80825

Light Output (Fixture Lumens): 1731
 Total Watts@120V: 27
 Lumens Per Watt: 65
 Color Rendering Index (CRI)¹: 80
 Color Temperature (CCT)²: 3029K Warm White
 Spectral Power Distribution Chart³
 LM-79 Test No. 80837

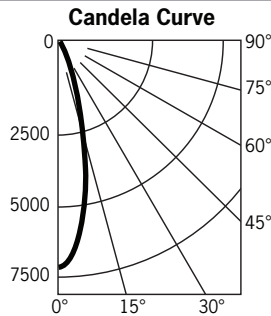
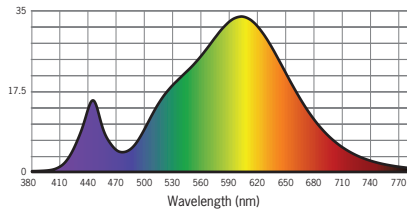

FROM 0	CANDELA	LUMENS
0	6982	
5	6256	542
15	2780	760
25	605	302
35	105	74
45	36	29
55	16	15
65	4	5
75	2	2
85	2	2
95	0	

DISTANCE (FT.)	FOOTCANDELES (FC)	BEAM DIAMETER (FT.)
6'	193.9	2.6
8'	109.1	3.5
10'	69.8	4.3
12'	48.5	5.2
14'	35.6	6.1
16'	27.3	7.0

Beam Distribution: 26°
 Spacing Criterion: 0.43

CTL802927LHF3

Designed for 50,000 Hour Lamp Life*; LM-63Test No. 80826

Light Output (Fixture Lumens): 1494
 Total Watts@120V: 26
 Lumens Per Watt: 58
 Color Rendering Index (CRI)¹: 82
 Color Temperature (CCT)²: 3066K Warm White
 Spectral Power Distribution Chart³
 LM-79 Test No. 80838

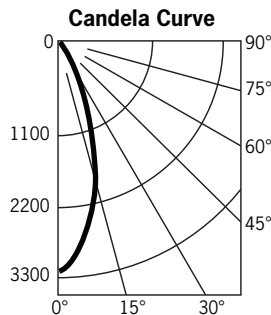
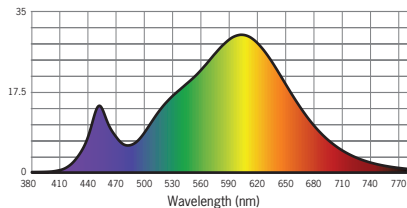

FROM 0	CANDELA	LUMENS
0	3205	
5	3027	275
15	2008	550
25	851	397
35	258	171
45	79	64
55	28	25
65	7	8
75	3	3
85	2	2
95	0	

DISTANCE (FT.)	FOOTCANDELES (FC)	BEAM DIAMETER (FT.)
6'	89.0	3.6
8'	50.1	4.8
10'	32.1	5.9
12'	22.3	7.1
14'	16.4	8.3
16'	12.5	9.5

Beam Distribution: 37°
 Spacing Criterion: 0.59

1. Accuracy of rendering colors
 2. Color appearance of light source
 3. Colors present within the light source

*Dependent on surrounding temperatures