

High Power

SEN CV 035 Indoor Fixture Guide

KKDÖ

Indoor | Surface | Max output up to 3570lm/m (1088lm/ft)



Key applications

- ✓ Ceiling
- ✓ Cove lighting
- ✓ Downlighting
- ✓ Flood lighting
- ✓ Interior
- ✓ Office lighting
- ✓ Public spaces
- ✓ Wall grazing

Key features

- ✓ Custom lengths
- ✓ Diffusion: Spotting
- ✓ Direct view
- ✓ Form factor: Large
- ✓ High lumen efficacy
- ✓ IP40
- ✓ Lensed
- ✓ Output max

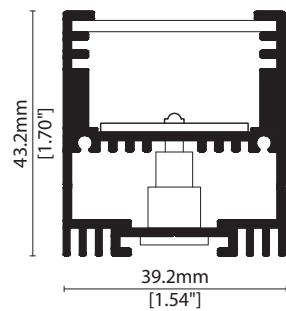

MOUNTING METHODS



KKCP-12 Lock clip



KKBK-02 Fixed bracket



KKBK-09 Mounting plate



KKBK-16 Small adjustable bracket



KKBK-17 Large adjustable bracket



KKBK-23 Low adjustable bracket



SEN CV 035 Indoor

Specification sheet



Dimension	H43.2/W39.2/L250-2000mm (H1.70/W1.54/L9.84-78.74in) 1250mm (49.21in) max for UL
PCB increment	250mm (9.84in)
LED pitch	35mm - 28LED/m (1.38in - 9LED/ft)
Chip	h-line CREE/Lumileds
Beam angle	10°/20°/30°/Spread lens (10° x 45°)/No lens
Colours	h-line White: 2700K/3000K/3500K/4000K/5000K (90CRI for 2700K/3000K)
Bin/Step	h-line 3-step MacAdam Ellipse h-line 4-step MacAdam Ellipse (5000K)
CRI	≥ 90 (2700K/3000K) ≥ 80 (3500K/4000K/5000K)
Lifetime	50,000 hours @ 25°C (50,000 hours @ 77°F)
Operating temp	T _a = -25 to 45°C (T _c max = 89.7°C) T _a = -13 to 113°F (T _c max = 164.6°F)
IP rating	IP40
Finish	Silver anodised
Cover/lens	Clear/Clear+Micro Louvre/Lens options
Mounting	Surface mounting via clips or brackets
Power feed	Sheathed hardwire tail
Control	1-10V/DMX/DALI (see visDIM range)



LED Grading Key

Exclusive Grade

h-line*	*KKDC tuned
Constant Voltage Lensed High Power LED	CCT range
3-step CCT range	
(4-step for 5000K)	

PERFORMANCE DATA @ 3000K

Power Consumption:	Supply voltage:	Supply current:
67.2 W/m (20.48 W/ft)	24V DC	2.8 A/m (0.85 A/ft)

Colour Rendering Index (CRI)

	R1	R2	R3	R4	R5	R6	R7	R8	R9	R10	R11	R12	R13	R14
h-line	94	95	92	93	93	91	95	91	77	85	92	77	94	94

	Clear Cover 10°	Clear Cover 20°	Clear Cover 30°	Clear Cover Spread Lens	Clear Cover No Lens	Clear Cover + Micro Louvre	CRI	R9	Rf	Rg
h-line	3570lm/m (1088lm/ft) 53.1lm/W	3540lm/m (1080lm/ft) 52.7lm/W	3220lm/m (980lm/ft) 48.9lm/W	3470lm/m (1057lm/ft) 51.6lm/W	2860lm/m (873lm/ft) 42.6lm/W	-60% Output when combined with Cover and Lens options	93	77	90	103

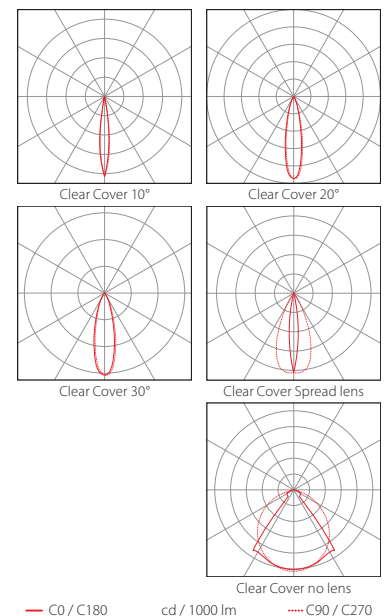
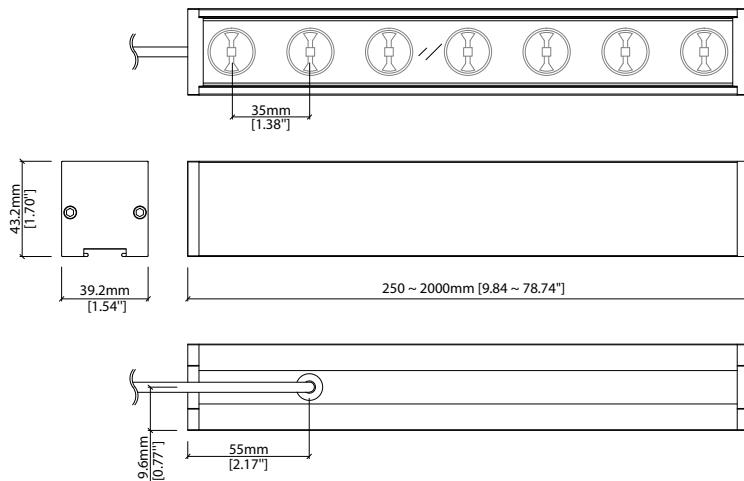

Data derived from independent UKAS/IESNA LM-79-08 accredited testing of production samples.



SEN CV 035 Indoor Code Table



FIXTURE

Model	Finish	Cover ¹	Grade ²	LED	Colour	Length Availability ³	IP	Cable Length	Power Feed ⁴	Cable Exit ⁵	Lens	Input					
SEN CV Indoor	IS Silver Anodised	SA Clear+ Micro Louvre	B h ^{CV} h	035	2700K ⁶	27 m	IP40	1000mm 39.37"	S00B Single ø6.3mm sheath tail	RC Rear Cable Exit	XX No lens	g DC 24V					
					3000K ⁶	30							i	9.84-78.74in 9.84in increments	D00B Double ø6.3mm sheath tail	SC Side Cable Exit ⁷	10° 20° 30° Spread Lens
					3500K	35											
					4000K	40											
					5000K	50											
(Specify length code OR total run length)																	

¹ Refer to **Cover Options** on **Options** pages

² Refer to **LED Grading Key** on **Specification sheet** page

³ Refer to **Length Availability List** or enter total run length instead of length code

⁴ Refer to **Power Feed Options** on **Options** pages

⁵ Refer to **Cable Exit Options** on **Options** pages

⁶ 2700K/3000K – 90CRI

⁷ Low adjustable bracket needs side cable exit option

Code Example:

IS	-	SA	-	B	-	h ^{CV}	-	035	-	30	-	m	-	1250	-	40	-	1000	-	D00B	-	RC	-	30	-	g
SEN CV Indoor		Silver Anodised		Clear		h ^{CV}		035		3000K		1250mm		IP40		1000mm/39.37"		Double ø6.3mm sheath tail		Rear Cable Exit		30°		DC 24V		

ACCESSORIES

Mounting Accessories

KKCP-12	Lock Clip
KKBK-02	Fixed bracket
KKBK-09	Mounting plate
KKBK-16	Small adjustable bracket
KKBK-17	Large adjustable bracket
KKBK-23	Low adjustable bracket

* Refer to **Mounting accessories** on **Accessories** pages

PSU/Driver

1-10V/DALI/DMX

* Refer to **Driver/PSU Options** page for details or provide requirement and KKDC to offer the suitable option

LED ENGINE VARIANTS (LED STRIP TYPE)

Colour	Output	LED	Lumen/m	Lumen/ft	W/m	W/ft	Spec Doc	Length	Increment
Single CCT	Max	035	3570	1088	67.2	20.48	SEN CV 035 Indoor	250-2000mm (9.84-78.74in)	250mm (9.84in)

* Performance data: h-line, clear cover, 10° lens, 3000K

High Power

SEN CV 035 Indoor Length Availability List



Length Code		Fixture Length ¹		LED Strip ²		End Cap Dimension ³		Wattage (W)	Output (lm)	
Metric	Imperial(US)	Metric	Imperial(US)	Metric	Imperial(US)	Metric	Imperial(US)		3000K (Test Data)	Range Data
m0250	i0010	250mm	9.84in	240mm	9.45in	10mm	0.39in	16.80	892	344-928
m0500	i0020	500mm	19.69in	490mm	19.29in	10mm	0.39in	33.60	1784	687-1856
m0750	i0030	750mm	29.53in	740mm	29.13in	10mm	0.39in	50.40	2676	1031-2783
m1000	i0039	1000mm	39.37in	990mm	38.98in	10mm	0.39in	67.20	3568	1374-3711
m1250	i0049	1250mm	49.21in	1240mm	48.82in	10mm	0.39in	84.00	4460	1718-4639
m1500	i0059	1500mm	59.06in	1490mm	58.66in	10mm	0.39in	100.80	5352	2061-5567
m1750	i0069	1750mm	68.90in	1740mm	68.50in	10mm	0.39in	117.60	6245	2405-6494
m2000	i0079	2000mm	78.74in	1990mm	78.35in	10mm	0.39in	134.40	7137	2748-7422

¹ Actual total overall length of light fixture (LED strip + end caps + void/wire hole)

² Actual length of PCB strip

³ Actual length of 2x end caps

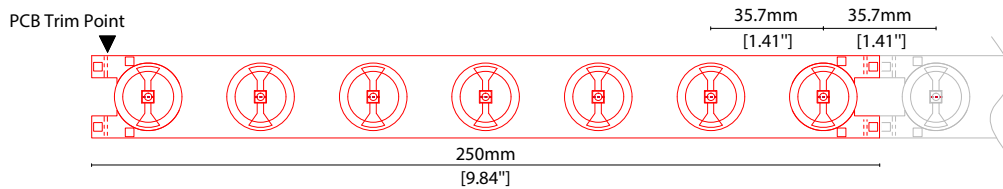
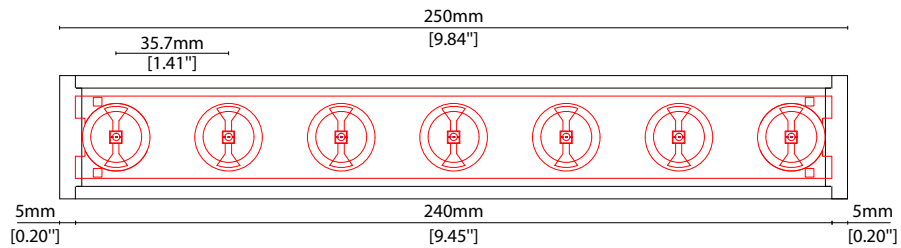



SEN CV 035 Indoor Options



COVER OPTIONS

* Options are an integral part of the fixture ordering codes. Please refer to **Code Table** pages.



B Clear

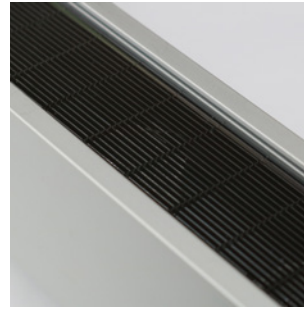
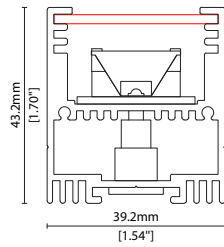

K Clear + Micro Louvre

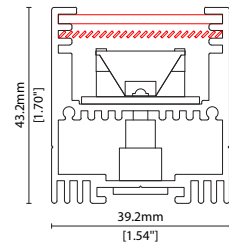

CABLE EXIT OPTIONS



RC Rear cable exit

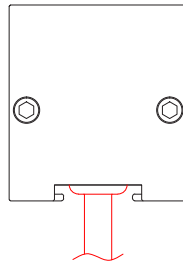

SC Side cable exit

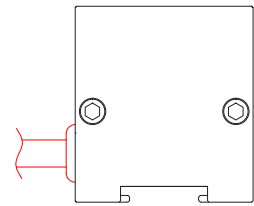



SEN CV 035 Indoor Options



POWER FEED OPTIONS

* Options are an integral part of the fixture ordering codes. Please refer to **Code Table** pages.

1000 S00B 1000mm (39.37") Single ø6.3mm sheath tail

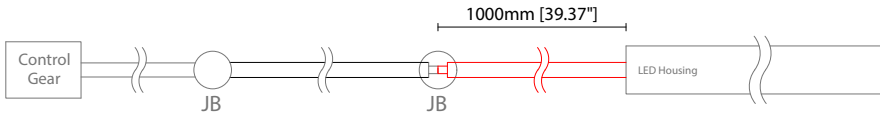

1000 D00B 1000mm (39.37") Double ø6.3mm sheath tail

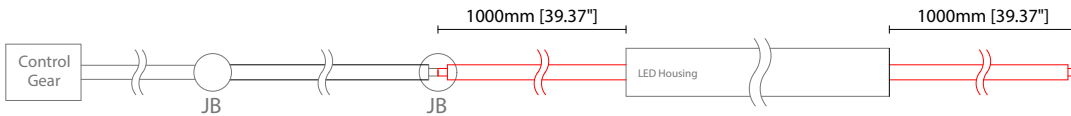

Key

Control Gear Power supply, sub-controllers & control systems
JB Junction box / cable connection

MOUNTING ACCESSORIES

Note: Accessories are to be ordered separately with corresponding code shown below.



KKCP-12

Lock clip (allow 2 per metre/40in)
S/Steel finish

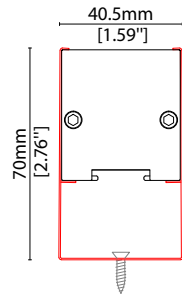

KKBK-02

Fixed bracket (allow 2 per metre/40in)
Steel finish
Pre-assembled for double tail

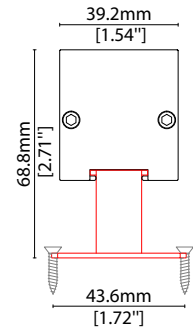

KKBK-09

Mounting plate
(allow 2 per metre/40in – factory fitted)
Silver anodised aluminium finish
Pre-assembled for double tail

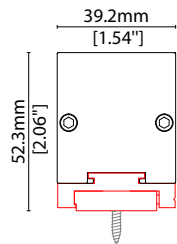

KKBK-23

Low adjustable bracket
(allow 2 per metre/40in)
Silver anodised aluminium finish
Pre-assembled for double tail

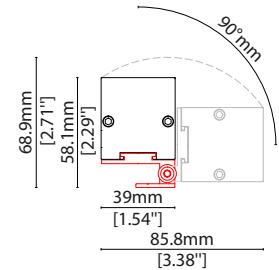

KKBK-16

Small adjustable bracket
(allow 2 per metre/40in)
Silver anodised aluminium finish
Pre-assembled for double tail

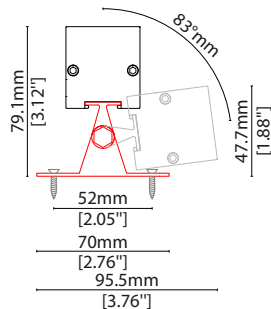

KKBK-17

Large adjustable bracket
(allow 2 per metre/40in)
Silver anodised aluminium finish
Pre-assembled for double tail

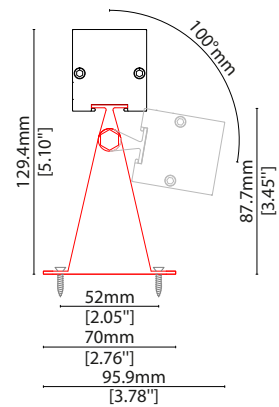

AVAILABLE PSU OPTIONS

Control Mode	PSU (Order Code)	Input Voltage AC	Output Voltage DC	Rated Output Current	Rated Power	Dim %	IP Rating
Switched	CEN-60-24	90-295V	24V	2.5A	60W	-	IP67
	HLG-60H-24	90-305V	24V	2.5A	60W	-	IP67
	HLG-100H-24	90-305V	24V	4.0A	100W	-	IP67
	HLG-150H-24	90-305V	24V	6.3A	150W	-	IP67
	HLG-240H-24	90-305V	24V	10A	240W	-	IP67
0-10V (1-10V)	PWM-40-24	90-305V	24V	1.67A	40W	100-0.15 (100-10)	IP67
	PWM-60-24	90-305V	24V	2.5A	60W	100-0.15 (100-10)	IP67
	PWM-90-24	90-305V	24V	3.67A	90W	100-0.15 (100-10)	IP67
	PWM-120-24	90-305V	24V	5.0A	120W	100-0.15 (100-10)	IP67
DALI	LIN100A1	120-277V	24V	1A per channel	100W	100-0.1	IP66/IP40
DMX RGB	LIN100A1	120-277V	24V	1.33A per channel	100W	100-0.1	IP66/IP40
DMX RGBW	LIN100A1	120-277A	24V	1A per channel	100W	100-0.1	IP66/IP40

Flicker Free Options - Combination of PSU+ sub-controller

Control Mode	PSU (Order Code)	Sub-controller (Order Code)	Input Voltage AC	Output Voltage DC	Rated Output Current	Rated Power	Dim %	IP Rating PSU/ Sub-controller
0-10V or 1-10V	CEN-60-24	KKDM-06	90-295V	24V	2.5A	60W	100-0.9	IP67/IP20
	HLG-60H-24	KKDM-06	90-295V	24V	2.5A	60W	100-0.9	IP67/IP20
	HLG-100H-24	KKDM-06	90-295V	24V	4.0A	100W	100-0.9	IP67/IP20
	HLG-150H-24	KKDM-06	90-295V	24V	6.3A	150W	100-0.9	IP67/IP20
	HLG-240H-24	KKDM-06	90-295V	24V	10.0A	240W	100-0.9	IP67/IP20
DALI	CEN-60-24	KKDL-02/03	90-295V	24V	2.5A	60W	100-0.1	IP67/IP20
	HLG-60H-24	KKDL-02/03	90-305V	24V	2.5A	60W	100-0.1	IP67/IP20
	HLG-100H-24	KKDL-02/03	90-305V	24V	4.0A	100W	100-0.1	IP67/IP20
	HLG-150H-24	KKDL-02/03	90-305V	24V	6.3A	150W	100-0.1	IP67/IP20
	HLG-240H-24	KKDL-02/03	90-305V	24V	10.0A	240W	100-0.1	IP67/IP20
DMX RGB	CEN-60-24	KKSC-05	90-295V	24V	2.5A	60W	100-0.9	IP67/IP20
	HLG-60H-24	KKSC-05	90-305V	24V	2.5A	60W	100-0.9	IP67/IP20
	HLG-100H-24	KKSC-05	90-305V	24V	4A	100W	100-0.9	IP67/IP20
	HLG-150H-24	KKSC-05	90-305V	24V	6.3A	150W	100-0.9	IP67/IP20
	HLG-240H-24	KKSC-05	90-305V	24V	10.0A	240W	100-0.9	IP67/IP20

¹ The items shown above cover the most frequently used specification but does not exhaust the possible options

² PSU and/or driver can be chosen from the table, or KKDC may recommend the best option upon receipt of the controls requirement and installation environment

³ Electrical shop drawing will include detailed information of PSU and relevant control drivers

⁴ Cut sheets are available on the controls section of www.kkdc.lighting or upon request