

Optical Assembly

1:2 Scale

**Pendant Stem with Round Canopy** 1:8 Scale**Wall Mounted Cantilever**

Mounting arms & hubs ordered separately

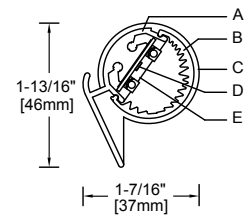
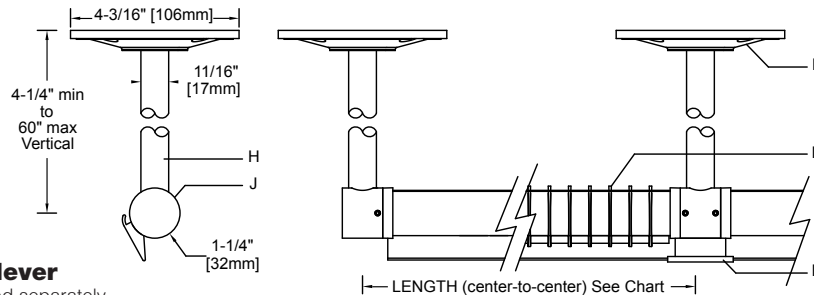
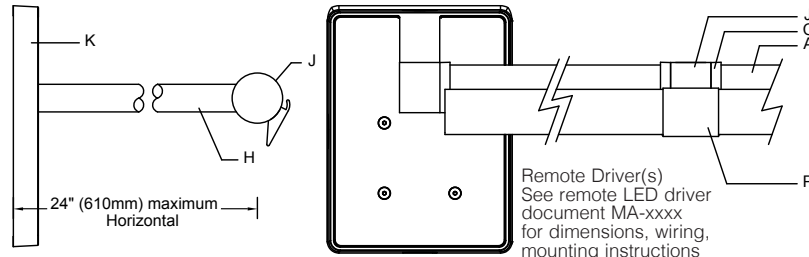

LENGTH	CENTER-CENTER
2FT	25" (635mm)
3FT	36-3/4" (933mm)
4FT	48-1/4" (1226mm)
5FT	60-1/4" (1530mm)
6FT	72-1/4" (1835mm)

Specifications

- | | | | |
|--|---|--|--|
| <p>A Extruded aluminum heat sink housing</p> <p>B Extruded semi-diffuse lens</p> <p>C Die-cast aluminum end plate</p> | <p>D Linear LED PCB with mid-power LEDs</p> <p>E Clear silicone encapsulant</p> <p>F Round j-box cover 4-3/16" diameter</p> <p>G Slip ring with set screw</p> | <p>H Rigid stem 11/16" O.D.</p> <p>J Aluminum mounting hub 1.25"</p> <p>K Wall Mounting Plate 6"H x 4.5"W</p> <p>M Optional cross baffle</p> | <p>N Extruded aluminum intermediate cover</p> |
|--|---|--|--|

Optic Assembly:

Extruded aluminum heat sink/optic housing. Exterior heat sink anodized for maximum emissivity. Precision extruded polymer refractive lens with optimal dispersion.

Finish:

Bright anodized extruded aluminum heat sink/housing with painted finish, white or black. Formed aluminum canopy, end hubs and stems painted white or black. Painted surfaces - 6 stage pretreatment and electrostatically applied thermoset polyester powder coating for a durable abrasion, fade and corrosion resistant finish. All hardware - stainless steel or nickel plated brass.

Mounting:

Required pendant or cantilever hangers -- ordered and priced separately. Surface Cantilever/pendant supplied with recessed outlet box (suitable backing structure required). Adjustable interface plate (concealed under canopy) allows for leveling of arms.

Fixture weight: 1.0 lb/ft (1.5 kg/m).

Electrical:

Luminaire furnished with 10 foot (3048mm) of low voltage cable for connection to remote driver. Electronic HPF thermally protected Class II driver mounted in weather-proof enclosure or optional indoor dry enclosure. For complete driver specifications, see website, reference document [MA-1303](#).

Standard:

CSA certified for wet locations
Dual rated IP66 and IP67
5 year warranty
Maximum ambient temperature 45°C (113°F).

**Features**

- Inconspicuous low profile - lights entire surface evenly from one edge
- Small elegant yet strong hub hangers
- Adjustable and lockable aiming
- Built-in visor provides shielding of glare

Performance

Precisely extruded acrylic lens produces an asymmetric distribution ideal for illuminating vertical surfaces evenly from top to bottom.

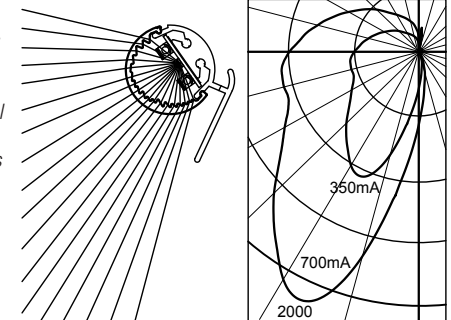

For LM79 and photometric reports, visit thelightingquotient.com

L90(10k) > 60,000 hrs.
@ 25°C per TM-21



To form a Catalog Number

S 1 5 1 - - - - - H - - - - -
 1 2 3 4 5 6 7 8 9 10

Project: _____

Type: _____

1 Source

S = Solid state (LED)

2 Style

151 = XtraSmall Outdoor Linear Adjustable

3 Length / Light Output / Power

ORDER CODE	LENGTH	LUMENS	INPUT WATTS	NUMBER OF LEDS	DRIVE CURRENT
R02G	2FT	799	7	72	175mA
R02L	2FT	1567	13	72	350mA
R02M	2FT	3037	27	72	700mA
R03G	3FT	1199	10	108	175mA
R03L	3FT	2350	20	108	350mA
R03M	3FT	4555	40	108	700mA
R04G	4FT	1598	13	144	175mA
R04L	4FT	3133	27	144	350mA
R04M	4FT	6073	53	144	700mA
R05G	5FT	1998	17	180	175mA
R05L	5FT	3916	33	180	350mA
R05M	5FT	7592	67	180	700mA
R06G	6FT	2398	20	216	175mA
R06L	6FT	4700	40	216	350mA
R06M	6FT	9110	80	216	700mA

Based on 3500K/80+ CRI. [Click here](#) for scaled performance table.**4 Mounting**

H = For use with required mounting hubs only or mounting hubs with surface or pendant/cantilever hangers — ordered and priced separately, see hubs/hangers at right.

5 Finish

02 = Semigloss white 15 = Metallic 99 = Custom or RAL, consult sales rep.*
 06 = Dark bronze* 17 = Champagne*
 07 = Silver* 18 = Copper*
 08 = Semigloss black

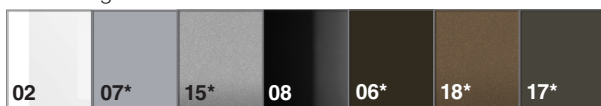

* = non-cancellable/returnable

6 Voltage

M = 120-277V Universal voltage input

K = 347V input

7 Option

00 = No options

0B = Cross baffle, provides shielding

0D = Indoor/dry location remote driver

BD = Cross baffle and indoor/dry location remote driver

8 Destination Requirement

0 = UL listed or CSA certified for U.S.

J = UL listed or CSA certified for Canada

9 Color Temperature / CRI

830 = 3000K, 80+ CRI

835 = 3500K, 80+ CRI

840 = 4000K, 80+ CRI

Note: Additional CCT and CRI options are available; consult factory.

RGB = RGBW (Red, Green, Blue, 3500K White, for use with DMX driver only)

Tunable White - Consult factory.

**10 Dimming****

00 = Non-dimming

TD = ERP forward phase or reverse phase (120V only), dimming range 100-10% power, compatible controls by others

ZX = 0-10V analog dimming 120-277V input, dimming range 100%-5%, 0-10V controls by others

EL = eldoLED SOLOdrive 120-277V input, dimming range 100%-0.1%, 0-10V controls by others.

ED = eldoLED SOLOdrive 120-277V input, dimming range 100%-0.1%, DALI controls by others.

DM = For RGBW only, eldoLED LINEARdrive 120-227V input, DMX controls by others

**Dimming range refers to % power input, % light output will vary.

Refer to Driver Information document [MA-1303](#)**Required Mounting Hangers**

HGA or HGC (hubs with hangers) are required — ordered and priced separately. Order two hangers and one HGE end of row kit (pair of end caps) for each individually mounted luminaire or each row. For a continuous row, order one hanger for each additional luminaire in the row. Example: three rows of four housings requires 3 end cap kits and (15) HGA or HGC hangers. **Note: Recessed outlet box by others or splice box style hanger required at each mounted location for electrical connections.**

HOL Hub only for use with 3/8" NPT rigid conduit by others

HGA Surface hanger with round mounting/splice box options

HGC Cantilever hanger with rectangular mounting splice box options - 24" maximum length (horizontal)

HGF Pendant hanger with round mounting/splice box options - 60" maximum length (vertical)

HGE End of row kit (two end caps)

Accessories**RGBW Controls**

ADW0000 = Accessory DimWheel DMX wall box controller. Mounts into standard switch box by others. Single-button controller allows control of dimming level, color and has pre-programmed show modes. Show sequences can also be designed and uploaded to DimWheel using free software by eldoLED.

**Example****S151-R06M-H-02-M-0D-0-835-ZX**

S151 XtraSmall outdoor linear adjustable asymmetric with remote driver. Extruded aluminum heat sink/housing, nominal 6ft (1830mm) long, 700mA, semi-gloss white finish, 120-277V electronic dimming driver with indoor/dry location enclosure, dims to 1%, 0-10V dimming controls by others, CSA certified for wet location, 3500K, 80+CRI.

The external shapes of the housings are trademarks of Sylvan R. Shemitz Designs, LLC dba **The Lighting Quotient**, makers of **elliptipar**, **tambient** and **fragtir**.

Certain products illustrated may be covered by applicable patents and patents pending. These specifications supersede all prior publications and are subject to change without notice. Copyright © 2021 Sylvan R. Shemitz Designs, LLC, all rights reserved.



elliptipar from The Lighting Quotient

114 Boston Post Road, West Haven, Connecticut 06516, USA

Voice 203.931.4455 • Fax 203.931.4464 • thelightingquotient.com

Ordering information for HUBS with HANGERS and SPLICE BOXES:

Order two hangers and one **HGE end of row kit** (two end caps, ordering info in hubs, below) for each individually mounted luminaire or each row. For a continuous row, order a hanger for each additional luminaire in the row. Example: one row of four reflectors requires five hangers and one HFE kit.

HG | | | | **0** = Hub mounting hangers

Length in inches (see below for maximum pendant and cantilever lengths), or enter "00" for HDA and HDB hangers

Finish: **02** semigloss white, **99** custom RAL or computer matched color to be specified, contact sales representative

0 = no splice box
1 = splice box

A = Surface hanger (standard length is 4-1/4")
C = Cantilever hanger (24" maximum length)
F = Pendant hanger (60" maximum length)

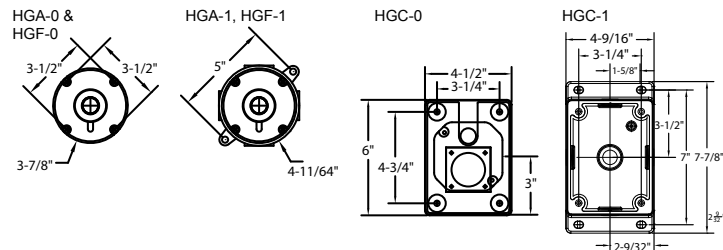
**Ordering information for HUBS without stems or mounting plates:**

For use with 1/2" rigid conduit or fittings (supplied by others). Order two hubs and one **HGE end of row kit** (two end caps) for each individually mounted luminaire or each row. For a continuous row, order one hub for each additional luminaire in the row. Example: a row of six reflectors requires seven hubs and one HGE end of row kit.

HOL | | | **000** = Mounting hub only (each)

Finish: **02** semigloss white, **06** dark bronze, **07** silver, **08** semigloss black, **17** champagne, **18** copper

HOL hub in intermediate position without end caps

HGE | | | **000** = End of row kit (two end caps)

Finish: **02** semigloss white, **06** dark bronze, **07** silver, **08** semigloss black, **17** champagne, **18** copper

HGE end of row caps cover outer ends of hubs

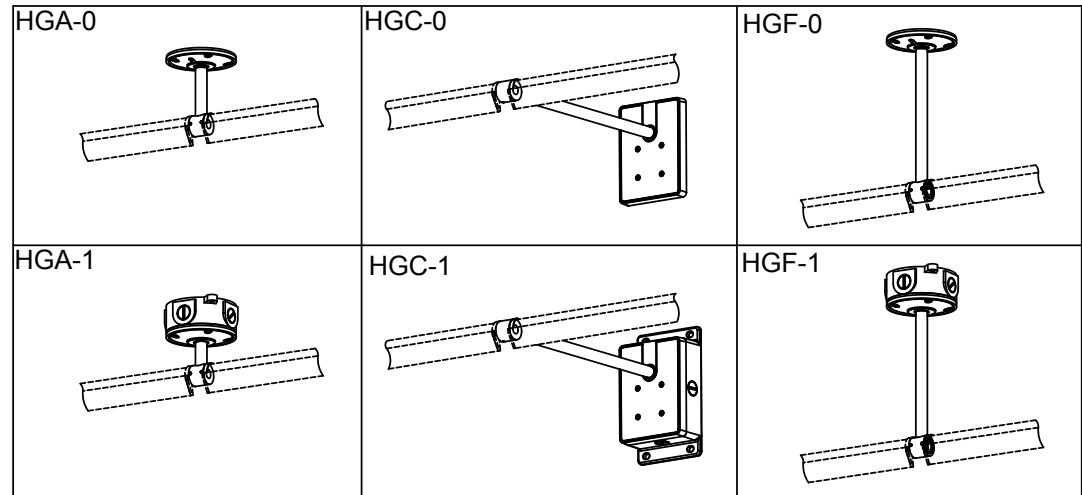
HUBS with HANGERS and SPLICE BOXES: Lighting the Vertical Plane**HUBS with HANGERS and SPLICE BOXES: Lighting the Ceiling****Example 1:**

12 Foot Row with (3) 4ft S151 fixtures and (4) 18 inch Wall Wash Cantilevers, surface conduit feed at first hanger. Order (3) S151-R04_ fixtures, (1) HGC-1 surface hanger with splice box, (3) HGC-0 surface hangers and (1) HGE end kit.

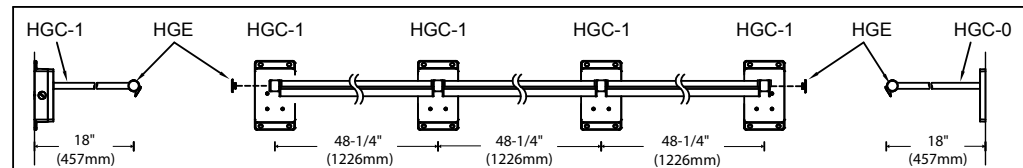
**Example 2:**

12 Foot Row with (3) 4ft S151 fixtures and (4) 18 inch Wall Wash Cantilevers, recessed outlet box feed at second hanger. Order (3) S151-R04_ fixtures, (1) HGC-1 surface hanger with splice box, (3) HGC-0 surface hangers and (1) HGE end kit.

