

CATALOG #: _____

TYPE: _____

PROJECT: _____

NEW CONSTRUCTION AND REMODEL

FEATURES

- Deliver scalable, data-driven smart buildings with Platformatics PoE-enabled fixtures and controls



SPECIFICATIONS

- HOUSING** – Die-cast aluminum trim housing with forged aluminum heat sink. Galvanized steel splice compartment with driver mounting plate/enclosure. Swing-out mounting arms field adjust for ceiling thickness from 1/2" – 2-1/4".
- OPEN REFLECTOR** – Low-iridescent anodized aluminum.
- LENSED TRIM** – Die-cast aluminum frame with micro-prismatic, acrylic lens.
- ELECTRICAL** – High-performance Class 2 LED array. Modular quick-connect plug for easy field-connection of LED light assembly to driver. Reported L70>50,000 hours. Low-voltage DC fixture, to be fed by Class 2 power supply. Tunable White products use LEDs of multiple CCTs and may produce a perceptibly different shade of white from single-CCT products at the same CCT. All CCTs are within 3 MacAdam ellipses.
- MOUNTING** – Recessed. 20 ga. galvanized steel mounting pan for new construction or IC-rated enclosure. Remodel kit option includes receiver bracket hardware. Minimum 24" O.C. marked spacing required for P35 and P49 lumen packages.
- LISTINGS** –
 - cCSAus conforms to UL STD 1598; Certified to CAN/CSA STD C22.2 No. 250.0 for dry and damp locations. LED light assembly conforms to UL 2108 for remote installation.
 - Suitable for wet location under covered ceiling when specified with WET/CC option.
 - IC-rated for direct contact with insulation when specified with I Mounting Type.
 - City of Chicago Environmental Air approved when specified with CP option.
 - Complies with ASTM-E283 when specified with ATH option.
 - RoHS compliant.
 - Complies with the Buy American Act and other federal regulations. Request certification at hew.com/baa.
- WARRANTY** – 5-year limited warranty, see hew.com/warranty.

SYSTEM REQUIREMENTS

- PoE-ready luminaires are connected to building power systems through network integration and require other components for complete PoE lighting system.
- For additional PoE info, see hew.com/poe.
- Consult factory for design support.



ORDERING EXAMPLE: 4DS - P22/835 - OPTIONS - POE PR - LW - OF - WH - TRIM OPTIONS - N - F1
 HOUSING TRIM MOUNT.

HOUSING

SERIES	LUMENS ^[1]	CRI	CCT	OPTIONS	CONTROL ^[2]
4DS	P11 1,100lm	8 80	27 2700K	ATH Airtight construction ^[6]	POE PR Power over Ethernet, Platformatics-ready
	P22 2,200lm	9 90 ^[4]	30 3000K	CP Chicago plenum (CCEA) ^[7]	
	P35 3,500lm		35 3500K		
	P49 4,900lm ^[3]		40 4000K		
			50 5000K		
			TW Tunable white (80 CRI, 2700K–5000K) ^[5]		

TRIM ^[8]

TRIM TYPE	DISTRIBUTION ^[9]	FLANGE TYPE	REFLECTOR FINISH	TRIM OPTIONS
L Flush lens	W Wide	OF 1/2" standard flange	Open trim types	MWT Textured white trim flange ^[15]
O Open reflector	55° Open	SF 1/4" mud-in flange ^[14]	CS Clear semi-specular anodize	IP IP65 rated trim ^[16]
R Regressed lens	60° Flush		SG Satin-glow anodize	AD Diffuse acrylic lens ^[17]
A Angled lens ^[10]	60° Regressed		GD Gold anodize	PD Diffuse 1/8" polycarbonate lens ^[18]
	M Medium ^[11]		CG Champagne gold anodize	WET/CC Wet location, covered ceiling listed ^[19]
	45° Open		PW Pewter anodize	AM Anti-microbial ^[20]
	35° Flush		SPC Clear specular anodize	
	35° Regressed		RG Rose gold anodize	
	N Narrow ^[12]		Lens trim types	
	40° Open		CS Clear semi-specular powder coat	
	25° Flush		WH White texture powder coat	
	25° Regressed		BL Black texture powder coat	
	WW Wall wash ^[13]		MB Black texture splay with white flange ^[21]	

MOUNTING

MOUNTING TYPE ^[22]

- N Open pan for new construction
- I IC-rated enclosure for new construction ^[24]
- R Remodel kit ^[25]

MOUNTING HARDWARE ^[23]

- F1 Integral 2-position fixed pan bracket, universal bar hanger included ^[26]
- BA1 Adjustable butterfly pan bracket, bar hanger not included ^[27]
- CA1 Adjustable caterpillar pan bracket, universal bar hanger included ^[28]

NOTES

- Static white lumen output based on L trim type, W distribution and WH finish, 80 CRI, 3000K for single CCT and 4000K for TW. Actual lumens may vary +/-5%, see page 2 for FIXTURE PERFORMANCE DATA.
- See page 5 for NODE CONNECTION DETAILS. For additional PoE info, see hew.com/poe.
- N Mounting Type only.
- Extended lead times may apply. Consult factory for availability. Not available with Tunable White.
- P11 and P22 lumen packages only.
- I Mounting Type required.
- I Mounting Type required. P11 lumen package only.
- Trim ships separately.
- Beam angle based on CS or WH reflector finish.
- Available with WW Distribution only.
- Not available with P49.
- Not available with P49.
- O and A Trim Types only.
- For use with mud-in plaster construction only, supplied with mud flange installation kit. See page 3 for FLANGE TYPE DETAILS. Not available with ATH or IP options.
- Not available with WH Reflector Finish or L Trim Type.
- L and R trim types only.
- Not available with O trim type. W and WW distributions only.
- Not available with O trim type. W and WW distributions only.
- Not available with O Trim Type. Not available with PD trim option.
- WH and BL Reflector Finishes only.
- R Trim Type only. Not available with MWT.
- Mounting hardware required (N and I only), ordered separately, see MOUNTING HARDWARE ordering info. See page 4 for MOUNTING TYPE DETAILS.
- Additional mounting hardware options available. See page 5 for MOUNTING HARDWARE DETAILS.
- P11 lumen package only.
- Also used in new construction sheetrock ceilings. Pan-less installation. P11 and P22 lumen packages only.
- N and I Mounting Types only. I Mounting requires external brackets.
- N Mounting Type only.
- N Mounting Type only.

FIXTURE PERFORMANCE DATA

STANDARD

OPEN REFLECTOR TRIM TYPE

	DISTRIBUTION	DELIVERED LUMENS	WATTAGE	EFFICACY (lm/W)
P11	W	1101	12.3	89.9
	M	1215	12.3	99.2
	N	1241	12.3	101.3
P22	W	2067	25.0	82.7
	M	2281	25.0	91.2
	N	2331	25.0	93.3
P35	W	3221	37.5	85.9
	M	3510	37.5	93.6
	N	3417	37.5	91.1
P49	W	4543	50.0	90.9
	M	-	-	-
	N	-	-	-

TUNABLE WHITE

OPEN REFLECTOR TRIM TYPE

	DISTRIBUTION	DELIVERED LUMENS	WATTAGE	EFFICACY (lm/W)
P11	W	956	12.3	78.1
	M	1051	12.3	85.8
	N	1074	12.3	87.7
P22	W	1944	25.0	77.8
	M	2118	25.0	84.7
	N	2062	25.0	82.5
P35	W	-	-	-
	M	-	-	-
	N	-	-	-
P49	W	-	-	-
	M	-	-	-
	N	-	-	-

FLUSH LENS TRIM TYPE

	DISTRIBUTION	DELIVERED LUMENS	WATTAGE	EFFICACY (lm/W)
P11	W	1193	12.3	97.4
	M	1310	12.3	107.0
	N	1330	12.3	108.6
P22	W	2239	25.0	89.6
	M	2469	25.0	98.8
	N	2495	25.0	99.8
P35	W	3488	37.5	93.0
	M	3799	37.5	101.3
	N	3657	37.5	97.5
P49	W	4919	50.0	98.4
	M	-	-	-
	N	-	-	-

FLUSH LENS TRIM TYPE

	DISTRIBUTION	DELIVERED LUMENS	WATTAGE	EFFICACY (lm/W)
P11	W	1031	12.3	84.2
	M	1138	12.3	92.9
	N	1150	12.3	93.8
P22	W	2105	25.0	84.2
	M	2293	25.0	91.7
	N	2207	25.0	88.3
P35	W	-	-	-
	M	-	-	-
	N	-	-	-
P49	W	-	-	-
	M	-	-	-
	N	-	-	-

REGRESSED LENS TRIM TYPE

	DISTRIBUTION	DELIVERED LUMENS	WATTAGE	EFFICACY (lm/W)
P11	W	1147	12.3	93.6
	M	1292	12.3	105.4
	N	1310	12.3	107.0
P22	W	2151	25.0	86.0
	M	2425	25.0	97.0
	N	2469	25.0	98.8
P35	W	3352	37.5	89.4
	M	3732	37.5	99.5
	N	3619	37.5	96.5
P49	W	4727	50.0	94.5
	M	-	-	-
	N	-	-	-

REGRESSED LENS TRIM TYPE

	DISTRIBUTION	DELIVERED LUMENS	WATTAGE	EFFICACY (lm/W)
P11	W	991	12.3	80.9
	M	1117	12.3	91.2
	N	1138	12.3	92.9
P22	W	2023	25.0	80.9
	M	2252	25.0	90.1
	N	2184	25.0	87.4
P35	W	-	-	-
	M	-	-	-
	N	-	-	-
P49	W	-	-	-
	M	-	-	-
	N	-	-	-

MULTIPLIER TABLES

	COLOR TEMPERATURE		
	CCT	LUMENS	
		STANDARD	TUNABLE WHITE
80 CRI	2700K	0.92	0.83
	3000K	0.98	1.00
	3500K	1.00	0.99
	4000K	1.01	1.00
	5000K	1.02	0.98
90 CRI	2700K	0.76	-
	3000K	0.79	-
	3500K	0.82	-
	4000K	0.84	-
	5000K	0.88	-

OPEN REFLECTOR FINISH		
CATALOG NUMBER	REFLECTOR FINISH	CONVERSION FACTOR
CS	Clear semi-specular	1.00
SG	Satin-glow	0.92
GD	Gold	0.93
CG	Champagne Gold	0.96
PW	Pewter	0.86
SPC	Specular	1.02
RG	Rose Gold	0.88
WH	White, textured	0.89
BL	Black, textured	0.79

TRIM	
CATALOG NUMBER	CONVERSION FACTOR
AD	0.85
PD	0.85

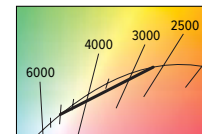

- Photometrics tested in accordance with IESNA LM-79. Results shown are based on 25°C ambient temperature.
- Standard results based on 3500K/80 CRI, actual lumens may vary +/-5%
- Tunable white results based on 4000K/80 CRI, actual lumens may vary +/-5%
- Use multiplier tables to calculate additional options.



4DS PoE | tunable **WHITE** 4.5" Downlight – Square

PHOTOMETRY

4DS-P22/835-POE PR-LW-OF-WH Total Luminaire Output: 2239 lumens; 25.0 Watts | Efficacy: 89.6 lm/W | 80 CRI; 3500K CCT

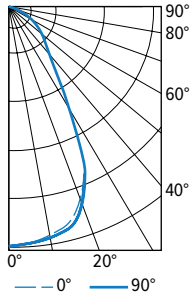

CANDLEPOWER DISTRIBUTION	VERTICAL ANGLE	HORIZONTAL ANGLE			ZONAL LUMENS
		0°	45°	90°	
	0	1665	1665	1665	
	5	1650	1650	1651	157
	15	1556	1579	1589	442
	25	1208	1367	1211	575
	35	547	831	536	421
	45	346	375	343	281
	55	209	215	208	193
	65	110	107	108	111
	75	46	45	46	50
	85	5	4	6	9
	90	0	0	0	

LUMEN SUMMARY	ZONE	LUMENS	% FIXTURE
	0 - 30	1173	52
	0 - 40	1594	71
	0 - 60	2069	92
	0 - 90	2239	100
	0 - 180	2239	100

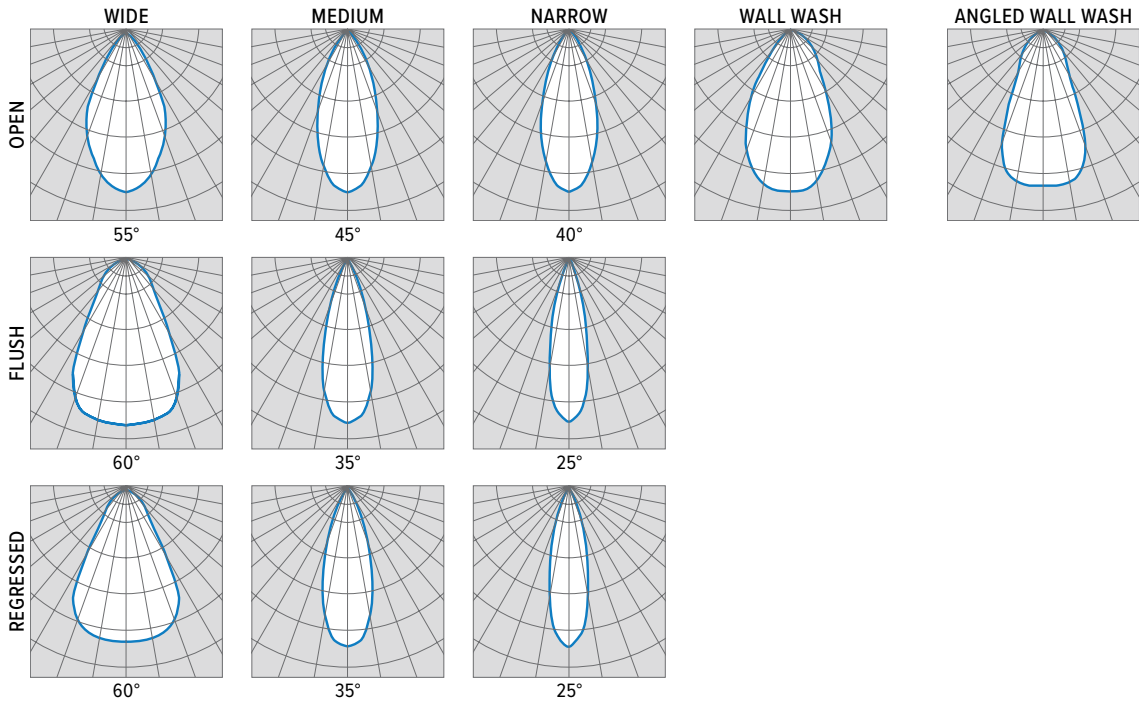

TRIM TYPE DETAILS

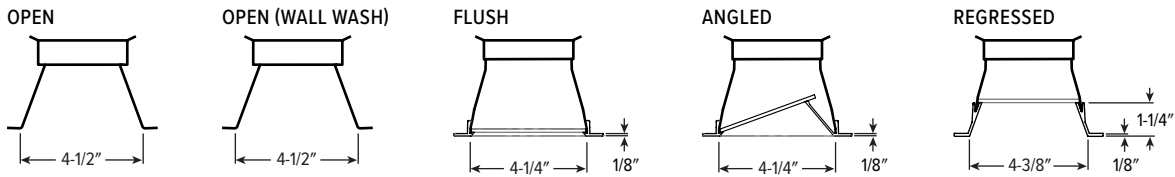

FLANGE TYPE DETAILS

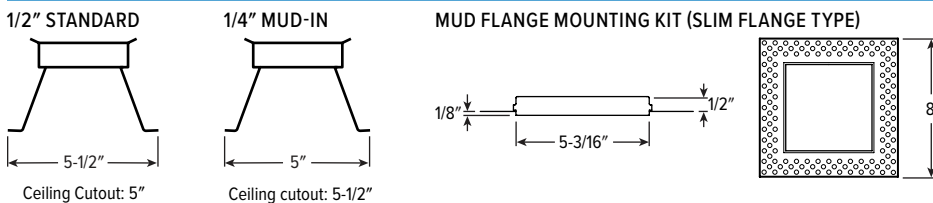

4DS PoE | tunable **WHITE** 4.5" Downlight – Square

REFLECTOR FINISH DETAILS

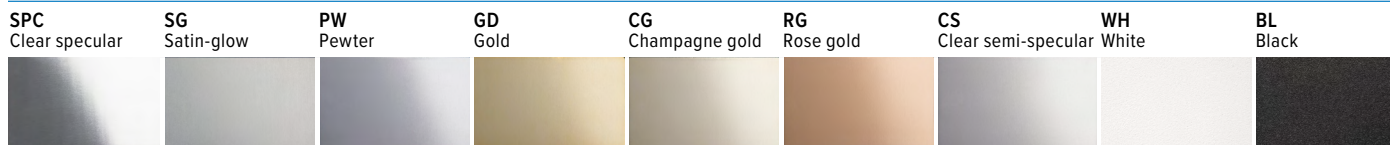

MOUNTING TYPE DETAILS

NEW CONSTRUCTION

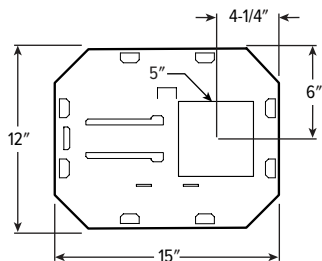

IC-RATED

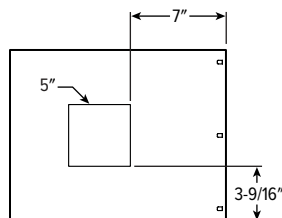
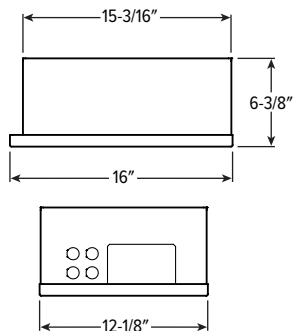

REMODEL

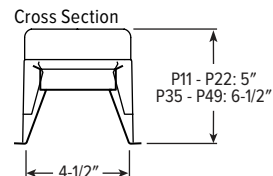

Receiver Bracket

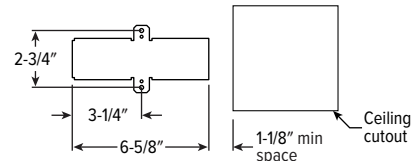

Driver and Junction Box

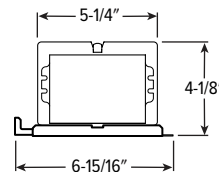

APERTURE ADAPTOR ORDERING INFO

ORDERING EXAMPLE: 4DR - GR - 0575 - WHT				
SERIES	CATALOG NUMBER	CEILING CUTOUT	FINISH	
4AR 6AR	GR	Specify ceiling cutout in 1/8" increments. Example: 5.75" = 0575	CS Clear semi-specular powder coat	
4DR 6DR			WH White texture powder coat	
4DS 6DS			BL Black texture powder coat	
4PR 6PR			See Kit Components for application limits.	
4PS 6PS 8DR				

For use with remodel downlights. Additional finishes available, consult factory.
For limitations and instructions, see hew.com/aperture-adaptor.pdf



4DS PoE | tunable WHITE 4.5" Downlight – Square

MOUNTING HARDWARE DETAILS

F1 Integral 2-position fixed pan bracket, universal bar hanger included

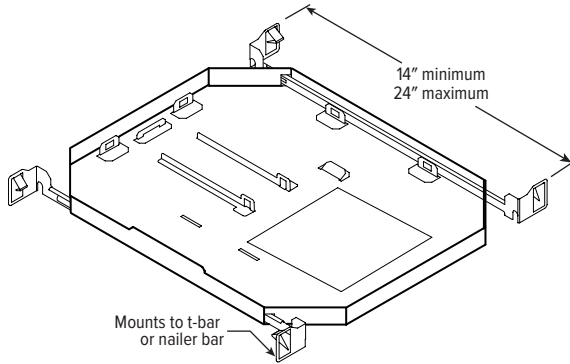

BA1 Adjustable butterfly pan bracket, bar hanger not included (N Mounting Type only)

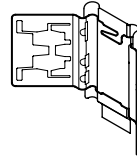

CA1 Adjustable caterpillar pan bracket, universal bar hanger included (N Mounting Type only)

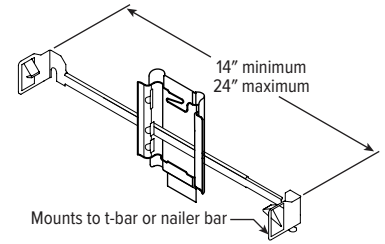

BA2 Adjustable butterfly pan bracket, heavy-duty universal bar hanger included (N Mounting Type only)

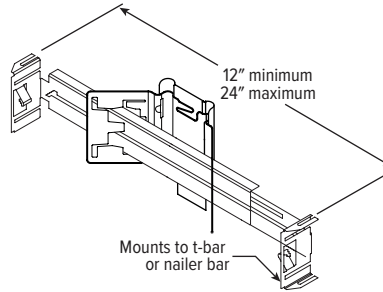

CA2 Adjustable caterpillar pan bracket, t-bar hanger included (N Mounting Type only)

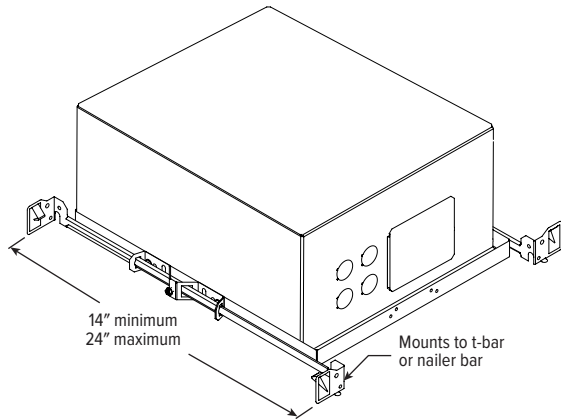
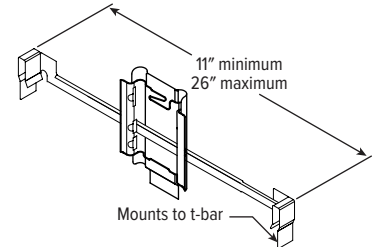

F1 with I Mounting Type

NODE CONNECTION DETAILS

Includes 24" cable with 4-position mating connector for Platformatics POE-LN2 node. See node spec sheet for details: platformatics.com/product/poe-ln2

