

CATALOG #: _____

TYPE: _____

PROJECT: _____

FEATURES

- Create rich, vibrant designs with lasting visual impact using the full visible light spectrum
- 4 inch aperture is unobtrusive in small scale spaces
- Square shape accentuates architectural styles
- Open reflector with 7 finishes to complement any interior style
- Die cast trim choices include flush, regressed or angled lens
- Spring clip retention system eliminates trim sag
- Contemporary design provides glare-free illumination for a soft ceiling appearance

ORDERING EXAMPLE: 4DS - L16/9TC - OPTIONS - DIM - 120 - LW - OF - WH - TRIM OPTIONS - N - F1
 HOUSING TRIM MOUNT.

HOUSING

SERIES	LUMENS ^[1]	COLOR	OPTIONS	CONTROL ^[2]	VOLTAGE
4DS	L11 1,100lm L16 1,600lm	9TC Tunable color (90 CRI, 1650K-8000K)	F Fuse kit	DALI DALI Type 8 enabled DIM (1) 0-10V signal to control dimming; (1) 0-10V signal to control either CCT or select up to five preset colors DMX DMX enabled LUT Lutron Ecosystem enabled ^[3] WS Wattstopper DLM enabled ^[4]	120 120V 277 277V

SPECIFICATIONS

- HOUSING – Die-cast aluminum trim housing with forged aluminum heat sink. Galvanized steel housing/splice compartment with driver mounting plate. Swing-out mounting arms adjust for ceiling thickness from 1/2" - 2-1/4".
- OPEN REFLECTOR – Low-iridescent anodized aluminum with top diffuser.
- LENSED TRIM – Die-cast aluminum frame with micro-prismatic, acrylic lens.
- ELECTRICAL – Five color, mid-power ERP-Lumenetix araya5 LED modules and contols. On board thermal and optical feedback ensure color consistency of <2 step MacAdam ellipse (SDCM) and reported L70>50,000 hours. In-line spectral capture and storage results in consistent CRI and CCT across all arrays.
- MOUNTING – Recessed. 20 ga. galvanized steel mounting pan for new construction. Minimum 24" O.C. marked spacing required for L16.
- LISTINGS –
 - cCSAus conforms to UL STD 1598; Certified to CAN/CSA STD C22.2 No. 250.0 for dry and damp locations.
 - Suitable for wet location under covered ceiling when specified with WET/CC option.
 - RoHS compliant.
- WARRANTY – 5-year limited warranty, see hew.com/warranty.

TRIM^[5]

TRIM TYPE	DISTRIBUTION ^[6]	FLANGE TYPE	REFLECTOR FINISH	TRIM OPTIONS
L Flush lens	W Wide	OF 1/2" standard flange	Open trim types	MWT Textured white trim flange ^[11]
O Open reflector	55° Open	SF 1/4" mud-in flange ^[9]	CS Clear semi-specular anodize	IP IP65 rated trim ^[12]
R Regressed lens	60° Flush		SG Satin-glow anodize	AD Diffuse acrylic lens ^[13]
A Angled lens ^[7]	60° Regressed		GD Gold anodize	PD Diffuse 1/8" polycarbonate lens ^[14]
	WW Wall wash ^[8]		CG Champagne gold anodize	WET/CC Wet location, covered ceiling listed ^[15]
			PW Pewter anodize	AM Anti-microbial ^[16]
			SPC Clear specular anodize	
			RG Rose gold anodize	
			Lens trim types	
			CS Clear semi-specular powder coat	
			WH White texture powder coat	
			BL Black texture powder coat	
			MB Black texture splay with white flange ^[10]	

MOUNTING

MOUNTING TYPE ^[17]	MOUNTING HARDWARE
N Housing/mounting pan for new construction only	F1 Factory-installed 2-position fixed pan bracket, universal bar hanger included ^[18]

SYSTEM REQUIREMENTS

- Fixtures are shipped with factory default settings, iOS mobile app required for proper commissioning.
- For additional info, see APPLICATION NOTES at erp-power.com/design-resources/technical-documentation.

NOTES

- 1 Lumen output based on L trim type, W distribution and WH finish, 4000K/90CRI. Actual lumens may vary +/-5%, see page 2 for FIXTURE PERFORMANCE DATA.
- 2 See page 4 for CONTROL DETAILS.
- 3 CCT control only.
- 4 CCT control only.
- 5 Trim ships separately
- 6 Beam angle based on CS or WH reflector finish.
- 7 Available with WW distribution only.
- 8 O and A Trim Types only.
- 9 For use with mud-in plaster construction only, supplied with mud flange installation kit. See page 3 for FLANGE TYPE DETAILS. Not available with IP option.
- 10 R Trim Type only. Not available with MWT.

- 11 Not available with WH Reflector Finish or L Trim Type.
- 12 L and R trim types only.
- 13 Not available with O trim type.
- 14 Not available with O trim type.
- 15 Not available with O Trim Type. Not available with PD trim option.
- 16 WH and BL Reflector Finishes only.
- 17 Mounting hardware required, ordered separately, see MOUNTING HARDWARE ordering info. See page 4 for MOUNTING TYPE DETAILS.
- 18 Universal bar hanger ships uninstalled. See page 4 for MOUNTING HARDWARE DETAILS.



4DS tunable COLOR

4.5" Downlight – Square

FIXTURE PERFORMANCE DATA

OPEN REFLECTOR TRIM TYPE

	COLOR	DIST.	DELIVERED LUMENS	WATTAGE	EFFICACY (lm/W)
L11	4000K	W	1021	24.0	42.5
	RED		108	4.1	26.3
	BLUE		48	6.9	7.0
	GREEN		345	10.8	31.9
L16	4000K	W	1561	40.1	38.9
	RED		165	6.8	24.3
	BLUE		74	11.5	6.4
	GREEN		528	18.0	29.3

FLUSH LENS TRIM TYPE

	COLOR	DIST.	DELIVERED LUMENS	WATTAGE	EFFICACY (lm/W)
L11	4000K	W	1106	24.0	46.1
	RED		117	4.1	28.5
	BLUE		52	6.9	7.5
	GREEN		374	10.8	34.6
L16	4000K	W	1691	40.1	42.2
	RED		179	6.8	26.3
	BLUE		80	11.5	7.0
	GREEN		572	18.0	31.8

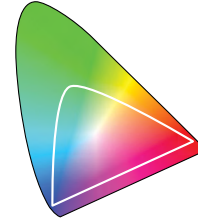

REGRESSED LENS TRIM TYPE

	COLOR	DIST.	DELIVERED LUMENS	WATTAGE	EFFICACY (lm/W)
L11	4000K	W	1062	24.0	44.3
	RED		112	4.1	27.3
	BLUE		50	6.9	7.2
	GREEN		359	10.8	33.2
L16	4000K	W	1625	40.1	40.5
	RED		172	6.8	25.3
	BLUE		77	11.5	6.7
	GREEN		549	18.0	30.5

MULTIPLIER TABLES

WHITE CONVERSION FACTOR		
CCT	LUMENS	WATTS
2000K	0.54	0.50
2700K	0.81	0.69
3000K	0.91	0.79
3500K	0.93	0.91
4000K	1.00	1.00
5000K	0.83	0.84
6000K	0.64	0.67
8000K	0.48	0.57

OPEN REFLECTOR FINISH		
CATALOG NUMBER	REFLECTOR FINISH	CONVERSION FACTOR
CS	Clear semi-specular	1.00
SG	Satin-glow	0.92
GD	Gold	0.93
CG	Champagne Gold	0.96
PW	Pewter	0.86
SPC	Specular	1.02
RG	Rose Gold	0.88

TRIM	
CATALOG NUMBER	CONVERSION FACTOR
AD	0.85
PD	0.85

- Photometrics tested in accordance with IESNA LM-79. Results shown are based on 25°C ambient temperature.
- Wattage shown is based on 120V input.
- Actual lumens may vary +/-5%
- Use multiplier tables to calculate additional options.

PHOTOMETRY

4DS-L16/9TC-DIM-120-LW-OF-WH Total Luminaire Output: 1691 lumens; 40.1 Watts | Efficacy: 42.2 lm/W | 97.6 CRI; 3905K CCT

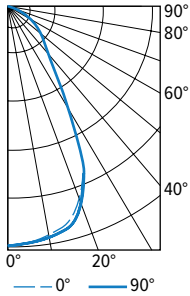

VERTICAL ANGLE	HORIZONTAL ANGLE			ZONAL LUMENS
	0°	45°	90°	
0	1258	1258	1258	
5	1246	1246	1247	118
15	1175	1192	1200	334
25	912	1033	915	434
35	413	628	405	318
45	261	283	259	213
55	158	162	157	146
65	83	81	81	84
75	35	34	35	38
85	4	3	5	7
90	0	0	0	

LUMEN SUMMARY	ZONE	LUMENS	% FIXTURE
	0 - 30	886	52
	0 - 40	1204	71
	0 - 60	1563	92
	0 - 90	1691	100
	0 - 180	1691	100



4DS tunable COLOR 4.5" Downlight – Square

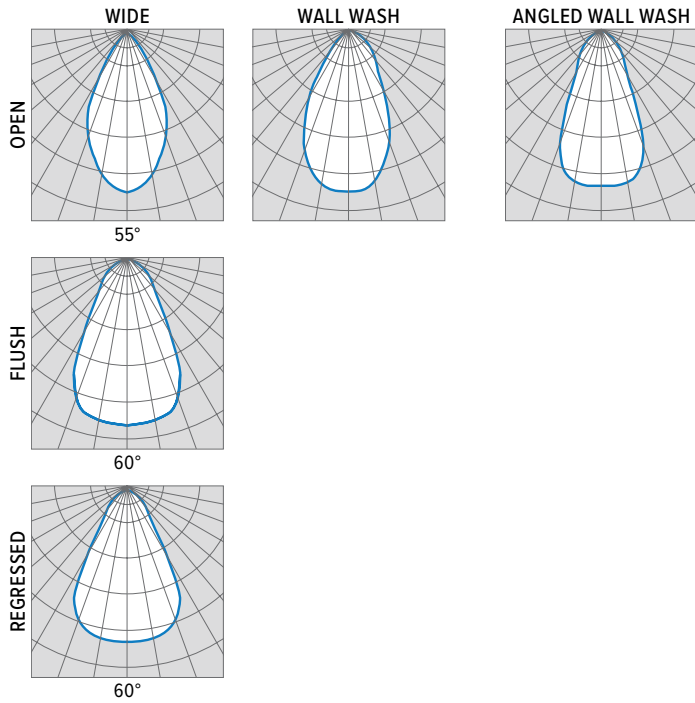

TRIM TYPE DETAILS

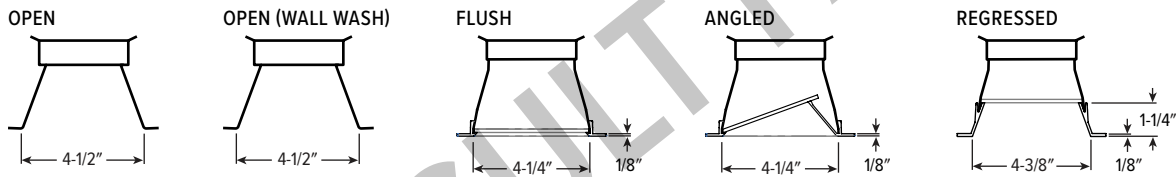

FLANGE TYPE DETAILS

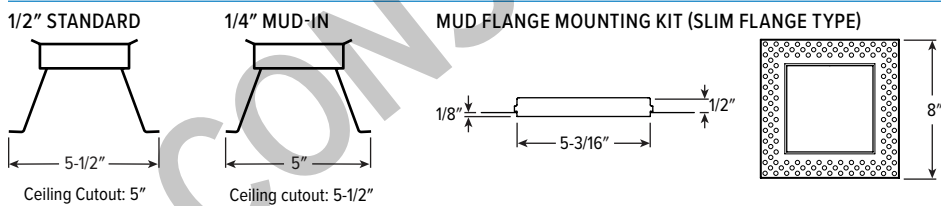

FINISH DETAILS

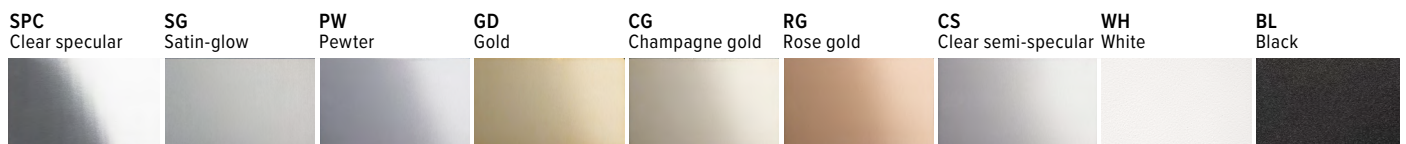

4DS tunable COLOR 4.5" Downlight – Square

CONTROL DETAILS



PROTOCOL	(1) DIMMING ^[1]	(2) CCT	(3) SATURATION	(4) HUE
0-10V DIM ^[4]	1%	1650 - 8000K	^[2]	^[2]
DALI TYPE 8	0.1%	1650 - 8000K	—	—
LUTRON ECOSYSTEM ^[3]	0.1%	1650 - 8000K	—	—
WATTSTOPPER DLM ^[3]	0.1%	1650 - 8000K	—	—
DMX512-A-RDM ^[3]	0.1%	1650 - 8000K	1 - 100%	1 - 60°

- ¹ 100 – 0.1% dimming is available when connected to 0.1% dimming capable digital controls. 100 – 1% dimming is available with analog 0 – 10V control.
- ² Two 0 – 10V lines can be used to control DIM and CCT independently, or program Scenes – in any combination of DIM, CCT, HUE and SAT – and recall them with five 0 - 10V presets.
- ³ May be limited to 1% dimming by controller; see control system specification for details.
- ⁴ 1 – 10V signal dims module to approximately 1%. In-line power relay required to achieve 0% output.

MOUNTING TYPE DETAILS

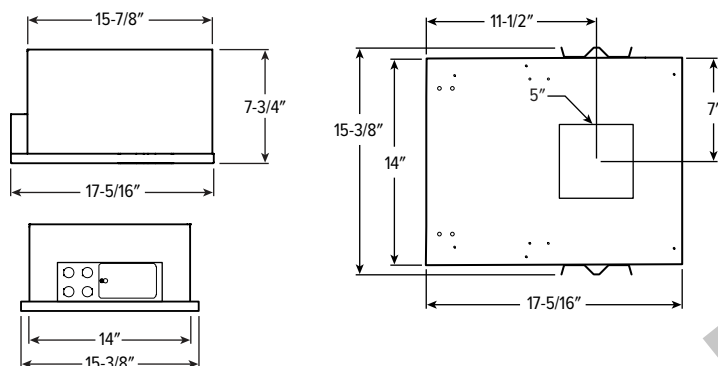

MOUNTING HARDWARE DETAILS

F1 Factory-installed 2-position fixed pan bracket, universal bar hanger included, ships uninstalled

