

- Integral ballast assembly in fixture for easy installation
- Available with highly efficient LEDs
- Lightweight aluminum composite upper reflector minimizes pole stress

- Stainless steel vertical struts
- Round or square upper reflectors available
- Reflector tilts and locks at 0, 15 or 30 degrees
- Powder coat finish in 13 standard colors with a polymer primer sealer



INDF

ORDERING CODE



1. LUMINAIRE

*Slips over a 5"/127mm O.D. pole.
INDF (Fixed head)*

2. REFLECTOR - UPPER (30 inch upper reflector)

RD (Round) SQ (Square)

3. LAMP/BALLAST

LED (30 LEDs, 33 watts, Warm white (3000K), Neutral white (4000K), Bright white (5000K), 120 thru 277 volt)
30LED-WW (Warm white)
30LED-NW (Neutral white)
30LED-BW (Bright white)

4. COLOR

Standard Color

- WH Arctic White
- BL Black
- BLT Matte Black
- DB Dark Bronze
- DGN Dark Green
- TT Titanium
- WDB Weathered Bronze
- MDB Bronze Metallic
- VBV Verde Blue
- CRT Corten
- MAL Matte Aluminum
- MG Medium Grey
- AGN Antique Green
- LG Light Grey

Premium Color

- SHK Shamrock
- SPP Salt and Pepper
- SFM Seafoam
- WCP Weathered Copper
- RAL RAL 4 digit Color
- CUSTOM Custom Color

5. OPTIONS

- CDC (Center deflector cone for round reflector. Provides a wider light distribution)
- SR (Two aluminum rings attached to the fixture. Factory installed. INDA only)
- CFH (Color filter holder attached to the fixture. Factory installed. INDA only)

SCP (Sensor Control Programmable) pole accessory is available to provide occupancy detection for outdoor applications meeting California Title 24. For complete spec sheet and ordering information, visit www.aal.net/products/sensor_control_programmable/

6. MOUNTING

WALL MOUNT

WMA (10 lbs. EPA: 0.68)

POLE MOUNT

PMAT (Twin pole mount arm, slips over a 4"/100mm O.D. pole or tenon, 14 lbs. EPA: 0.83)

[Visit www.aal.net](http://www.aal.net) for Arms, Poles & Accessories Specification Guide

SPECIFICATIONS

UPPER REFLECTOR

The upper reflector shall be a light weight aluminum composite. The reflector shall be finished in a white, fluoropolymer finish. The reflector shall be attached to the cast aluminum pivot joints and secured with four stainless steel bolts. Two cast aluminum, adjustable knuckles shall connect the reflector assembly to the vertical, stainless steel struts. The struts are #304 stainless steel with a minimum .250" wall thickness. The struts shall have threaded connections for attachment to the upper reflector and the lamp module.

REFLECTOR ADJUSTMENT

The Indirect upper reflector can be tilted 15 or 30 degrees for an asymmetrical light distribution. The locking clamp design ensures a consistent tilt angle on all fixtures. The Indirect model INDA has an adjustable lamp head to focus the light beam onto the center of the shade, when the shade is tilted. This improves efficiency and minimizes any stray light beyond the reflector.

LAMP MODULE

The reflector shall be enclosed in cast aluminum housing. The front cover is secured with four cap screws for relamping and internal access. The front glass element is clear, tempered glass. The front cover and electrical module are sealed with memory retentive, molded silicone gaskets.

See next page

JOB	_____
TYPE	_____
NOTES	_____



JOB	_____
TYPE	_____
NOTES	_____

ELECTRICAL MODULE

The driver assembly is mounted on a prewired plate with a quick disconnect plug.

CONTROLS

SCP shall have an integral surge protection device with a current rating of 10,000 Amps using the industry standard 8/20uSec wave and surge rating of 372J

Sensor not intended for use with additional photo-control, wireless control or dimming systems.

FINISH

Fixture finish consists of a five stage pretreatment regimen with a polymer primer sealer, oven dry off and top coated with a thermoset super TGIC polyester powder coat finish. The finish shall meet the AAMA 605.2 performance specification which includes passing a 3000 hour salt spray test for corrosion resistance.

The reflector shall be painted white. The vertical struts are stainless steel. All other fixture parts shall be finished in the same specified color.

CERTIFICATION

The fixture shall be listed with ETL and U.L. for outdoor, wet location use, UL1598 and Canadian CSA Std. C22.2 NO.250.

EPA: INDA or INDF

- round upper reflector/ 0° tilt: 3.65
- square upper reflector/ 0° tilt: 4.40
- round upper reflector/ 30° tilt: 6.52
- square upper reflector/ 30° tilt: 6.62

WARRANTY / TERMS AND CONDITIONS OF SALE

Download: <http://www.hubbelling.com/resources/warranty/>

AAL reserves the right to change product specifications without notice.

DIMENSION

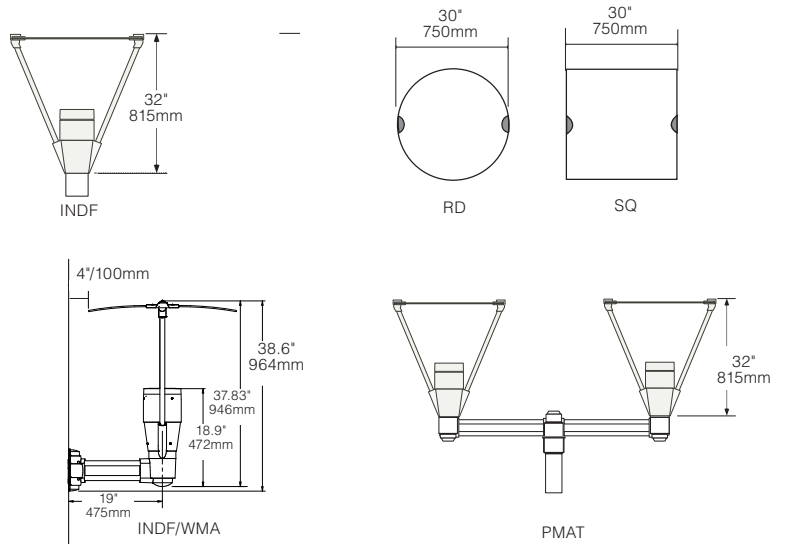

INDF

WT: 31.5 lbs

EPA:

INDF-SQ Sail:

0° = 0.93

15° = 2.50

30° = 4.24

INDF-RD Sail:

0° = .69

15° = 2.12

30° = 3.51