

# WMA4– Period Wall Mount Arm

TYPE



WMA4

1. ARM

2. COLOR

## 1. ARM

WMA4 (Weight: 12 lbs.)

## 2. COLOR

WH Arctic White  
 BL Black  
 BLT Matte Black  
 DB Dark Bronze  
 DGN Dark Green  
 TT Titanium  
 WDB Weathered Bronze

MDB Bronze Metallic  
 VBU Verde Blue  
 CRT Corten  
 MAL Matte Aluminum  
 MG Medium Grey  
 AGN Antique Green  
 LG Light Grey  
 RAL Premium Color  
 CUSTOM \*\* Contact Factory

## DIMENSIONS

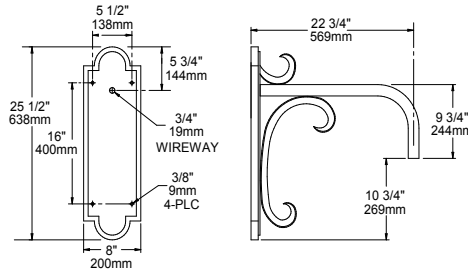

Note: Back plate is welded to the arm.

WMA4

## SPECIFICATIONS

The arm shall be of one piece unitized aluminum construction, fully welded and assembled. The back plate shall be one piece cast aluminum. The arm shall be prewired with a quick connector for easy installation.

The arm shall have a cast aluminum fitter welded to the top of the arm(s) for attaching the fixture. The fixture shall be mounted with three stainless steel bolts through the top of the arm fitter into the fixture. The attachment point shall have a silicone pad for sealing the fixture to arm connection.

Mounting hardware and J-box by others.

JOB \_\_\_\_\_  
 TYPE \_\_\_\_\_  
 NOTES \_\_\_\_\_  
 \_\_\_\_\_



ARCHITECTURAL AREA LIGHTING  
 16555 East Gale Ave. | City of Industry | CA 91745  
 P 626.968.5666 | F 626.369.2695 | www.aal.net  
 Copyright © 2012 | REV 6.12