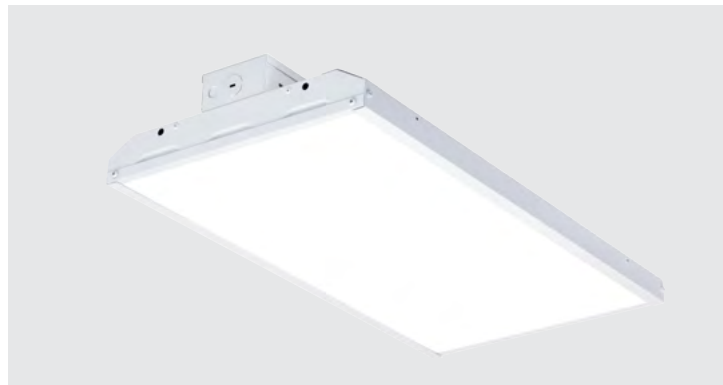

FEATURES

- Lumen packages range from 11,000 to 27,000 lumens in a 2ft housing
- Frosted acrylic lens
- LED light engine provides nominal efficacies of 130 lm/w
- 0-10V dimming to 10%
- -20°C up to 50°C ambient operation; see table for details
- Universal voltage standard (120-277V); 347V, 480V optional
- 80+ CRI
- 6kV surge protection
- Long life LEDs with projected life over 122,000 hours at L70

**RELATED PRODUCTS**

Peloton

LLHV

CRN

SPECIFICATIONS**CONSTRUCTION**

- Painted after fabrication full body steel housing constructed for shipment and job site durability. Channel includes top and side knockouts for simple and accessible wiring

OPTICS

- Optical grade PMMA with diffusion for distribution control and glare reduction

INSTALLATION

- V-hook and chain hanger are standard with each luminaire. Additional mounting options include surface mounting with the use of tong brackets and a single point stem (pendant) mount; refer to Accessories table for details

ELECTRICAL

- Efficient LED light engine (nominal 130 lm/w) with long life (122,000 hours, calculated) LEDs. Driver is 6kV surge protected and available in 120-277V standard or 347V, 480V. 0-10V standard with dimming range of 100% to 10%.

CERTIFICATIONS

- All luminaires are built to UL1598 standards, and bear appropriate cULus labels for damp location
- DLC® (DesignLights Consortium) Premium Qualified. Please refer to the DLC website for specific product qualifications at www.designlights.org

WARRANTY

- 5 year warranty
- See [HLI Standard Warranty](#) for additional information

STOCK GUIDE

Catalog Number	Description	Lumens	Watts	LM/W	Qty on Pallet	Fluorescent Replacement
CHB2-40LX-FA-EDU	2' LED High Bay, 4000K, 0-10V dimming, 120-277V	11,380	87.7	130	44	4-lamp HLT8, 2-lamp T5HO
CHB2-50LX-FA-EDU	2' LED High Bay, 5000K, 0-10V dimming, 120-277V	11,483	87.7	131	44	
CHB2-40ML-FA-EDU	2' LED High Bay, 4000K, 0-10V dimming, 120-277V	17,013	132.6	128	44	6-lamp T8
CHB2-50ML-FA-EDU	2' LED High Bay, 5000K, 0-10V dimming, 120-277V	17,105	131.7	130	44	
CHB2-40MH-FA-EDU	2' LED High Bay, 4000K, 0-10V dimming, 120-277V	21,949	172.7	127	44	6-lamp HLT8, 4-lamp T5HO
CHB2-50MH-FA-EDU	2' LED High Bay, 5000K, 0-10V dimming, 120-277V	22,038	172.4	128	44	
CHB2-40MV-FA-EDU	2' LED High Bay, 4000K, 0-10V dimming, 120-277V	27,343	211.9	129	22	8-lamp HLT8, 6-lamp T5HO
CHB2-50MV-FA-EDU	2' LED High Bay, 5000K, 0-10V dimming, 120-277V	27,522	212.9	129	22	

KEY DATA

Lumen Range	11,380–27,522
Wattage Range	87.7–212.9
Efficacy Range (LPW)	128–131
Reported Life (Hours)	L70/60,000
Input Current (mA)	.31–1.77

ORDERING GUIDE

Example: CHB2-40ML-FA-EDU

CATALOG #

CHB	2			FA	ED		
Model	Size	Color Temp	Lumen Output	Lens	Driver	Voltage	Options
CHB Linear High Bay	2' 2'	40 4000K 50 5000K	LX Low Extra High Lumen (11,000) ML Medium Low Lumen (17,000) MH Medium High Lumen (22,000) MV Medium Very High Lumen (27,000)	FA Frosted Acrylic	ED 0-10V Dimming	U 120-277V 347 347V 480 480V	ELL14 Emergency Battery Pack, 1700lm ¹ OS1360 Factory-Installed End Mount PIR Occupancy Sensor, On-Off & Time Delay. 1:1 Mounting Height to Coverage Ratio ¹ ODS1360 Factory Installed End Mount Microwave Occupancy/Daylight Sensor, Dimming. 1:1 Mounting Height to Coverage Ratio ¹ C6TL152 6' cord and Twist-Lock® Plug, 277V, 15A ² C6TL202 6' cord with Twist-Lock® Plug, 277V, 20A ² F3C6 3-conductor cord, 6ft F4C6 4-conductor cord, 6ft ³ F5C6 5-conductor cord, 6ft F6C6 6-conductor cord, 6ft ³ F3C15 3-conductor cord, 15ft F4C15 4-conductor cord, 15ft ³ F5C15 5-conductor cord, 15ft F6C15 6-conductor cord, 15ft ³ C3P151 3-conductor cord, 6ft straight blade plug, 120V, 15A

Accessories (Order Separately)

CHB-WG-N	Wire Guard Kit, Narrow, for LX, ML, and MH models
CHB-WG-W	Wire Guard Kit, Wide, for MV model
CHB-SMK-N	Surface Mount Kit, Narrow, for LX, ML, and MH models ⁴
CHB-SMK-W	Surface Mount Kit, Wide, for MV model ¹
CHB-PMK-SM	Pendant Mount Kit, Small, for LX model
CHB-PMK-LG	Pendant Mount Kit, Large, for ML, MH, and MV models
LWSQM5	Aircraft Cable, 5' (pair)
LWSQM10	Aircraft Cable, 10' (pair)
HBMS-REMOTE	Dimming Sensor Commissioning Remote Control

Notes:

- 1 Not available with 347V or 480V
- 2 Only for use with 277V; select "U" voltage option
- 3 Available with ELL14 only
- 4 Not compatible with 347V/480V ML or MH model

MAX AMBIENT OPERATING TEMPERATURE**Max Ambient Operating Temperature (without EM pack)**

Voltage	Lumen Output	Nominal Lumens	Mounted 2' from Ceiling	Surface Mount
120-277V	LX	11,000	50°C	50°C
	ML	17,000	50°C	50°C
	MH	22,000	50°C	50°C
	MV	27,000	50°C	50°C
347-480V	LX	11,000	50°C	50°C
	ML	17,000	55°C	25°C
	MH	22,000	50°C	25°C
	MV	27,000	50°C	25°C

DIMENSIONS

LX MODEL

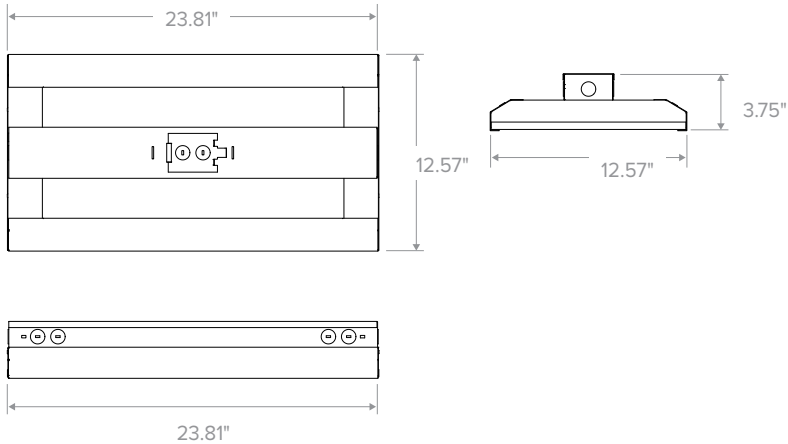

ML, MH MODELS

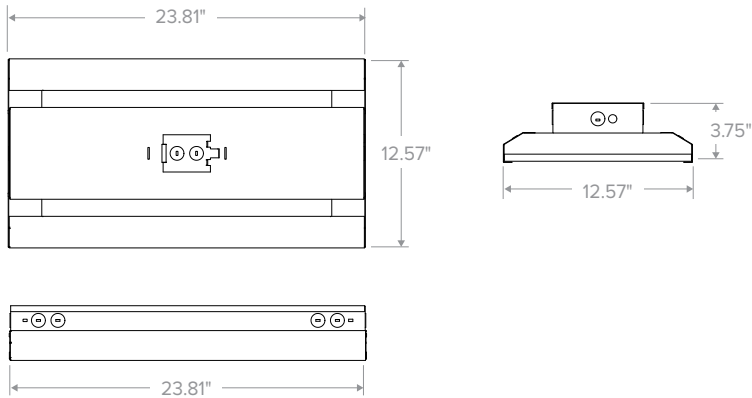

MV MODEL

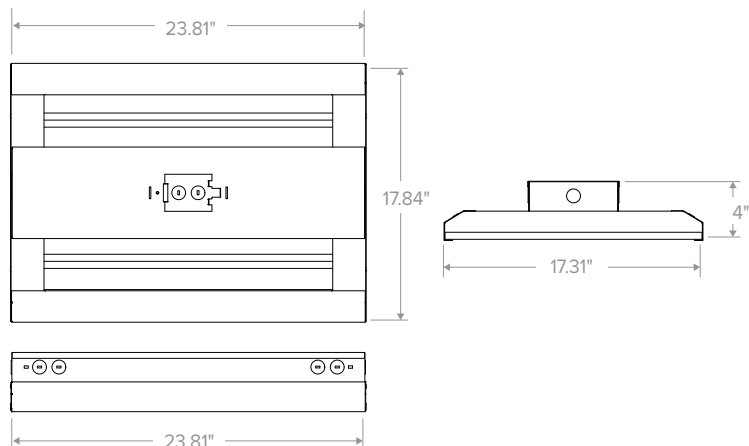

DATE:	LOCATION:
TYPE:	PROJECT:
CATALOG #:	

ADDITIONAL INFORMATION

MOUNTING OPTIONS

41" Chain Hanger (Standard)

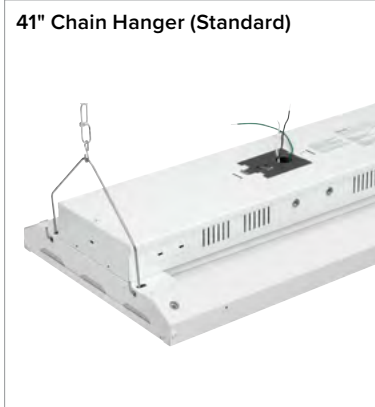

Surface Mount (Optional)



Pendant Mount (Optional)

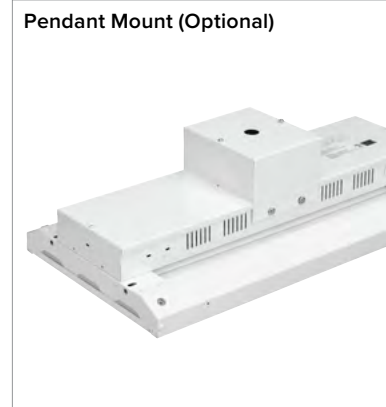

PHOTOMETRY

CHB2-40ML-FA-EDU

LUMINAIRE DATA

Test No.	RKSB180522019-10
Description	Commercial Linear LED, Highbay 12.5" x 24" LED luminaire with frosted acrylic lens
Delivered Lumens	17401
Watts	132.66
Efficacy	131
Mounting	Recessed
Spacing Criterion	0° = 1.24 90° = 1.24

ZONAL LUMEN SUMMARY

Zone	Lumens	% Luminaire
0-30	5243	30.1
0-40	8509	48.9
0-60	14424	82.9
0-90	17401	100.0
0-180	17401	100.0

INDOOR CANDELA PLOT

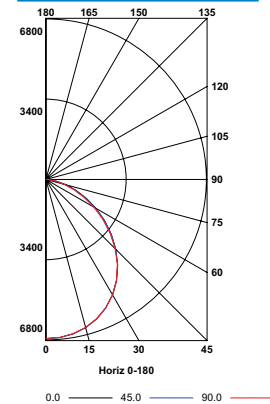

CHB-40MH-FA-EDU

LUMINAIRE DATA

Test No.	RKSB180522020-10
Description	Commercial Linear LED, Highbay 12.5" x 24" Led luminaire with frosted acrylic lens
Delivered Lumens	22550
Watts	172.79
Efficacy	131
Mounting	Recessed
Spacing Criterion	0° = 1.24 90° = 1.24

ZONAL LUMEN SUMMARY

Zone	Lumens	% Luminaire
0-30	6808	30.2
0-40	11052	49.0
0-60	18707	83.0
0-90	22550	100.0
0-180	22550	100.0

INDOOR CANDELA PLOT

