



createchange



**FEATURES**

- Designed specifically to provide comfortable ambient lighting or high lumen levels for examinations on demand
- Step dimming LED drivers provide ability to go from ambient to exam light levels
- Standard high performance matte white Antimicrobial® paint resists bacterial growth on exposed painted surfaces
- 90 CRI standard with a high R9 for excellent color rendering
- Enclosed lens protects against intrusion of contaminants
- High efficiency lens features linear prism acrylic for visual comfort and high performance without LED pixelation
- Long life, 50,000 hour LEDs at L80 reduce life cycle maintenance costs
- Lens gasket option and wet location listing available
- Low W/ft<sup>2</sup> ratio typically meets most restrictive lighting power density codes
- Electrical components accessible from below the ceiling with modular replaceability
- QR code for future traceability
- DLC® (DesignLights Consortium) Qualified - see www.designlights.org

**PROJECT INFORMATION**

Project Name \_\_\_\_\_

Type \_\_\_\_\_

Catalog No. \_\_\_\_\_

Date \_\_\_\_\_

**CONSTRUCTION**

Luminaire housing and end caps are die formed code gauge cold rolled steel. Reflector is stiffened with linear forms, profiled to a precision curve. High transmission extruded acrylic enclosed lens features linear prisms and custom frost for high efficacy without pixelation.

**SHIELDING**

Thermoplastic light seals snap into the housing at both ends of the lens to prevent light leaks. Lens hinges down for easy access to LED module and electrical components. Optional gasketing available to surround the lamp cavity (standard when Wet Label option is ordered).

**FINISH**

Supplied standard with Antimicrobial® paint; resists bacterial growth on exposed painted surfaces. Paint is custom formulated high reflectivity matte white for uniform indirect illumination and attractive, professional appearance.

**INSTALLATION**

For recessed products (G) an access plate is furnished with each luminaire for fast wiring access without the necessity to open the fixture or wireway. Surface mount (SM) products are provided with a surface mounting collar.

**CEILING COMPATIBILITY**

Luminaire fits recessed exposed grid ceilings (G); four integral NEC compliant T-bar clips are standard. Can be placed in Slot Grid (SG) style ceiling with regress 3/8" above ceiling plane. A Flange Kit (FK) accessory is available for recessed hard ceiling applications. Surface Mount (SM) option allows placement below ceiling plane.

**CERTIFICATION**

All luminaires are built to UL1598 and 2108 standards, and bear appropriate CSA labels. Damp location is standard. IC label standard. Note that IC label is void if product is installed on site with through wiring. Wet location listing available on all configurations. Emergency-equipped fixtures labeled UL 924 and Dry Location unless specified. Adheres to LM79, LM80, and TM21 industry standards. DLC® (DesignLights Consortium) Qualified. Please refer to the DLC website for specific product qualifications at www.designlights.org.

**WARRANTY**

Five year warranty (Terms and Conditions apply).

**ORDERING INFORMATION**

**EXAMPLE LTRX24-35AXG-RFA-EAXU**

<b>LTRX</b>	<b>24</b>	<b>AX</b>	<b>-</b>	<b>RFA</b>	<b>-</b>	<b>EAX</b>	<b>U</b>	<b>-</b>
<b>MODEL</b> LTRX Ambient/Exam Enclosed Luminaire	<b>COLOR TEMPERATURE</b> 30 3000K 35 3500K 40 4000K	<b>CEILING TYPE</b> G Grid Lay-in <sup>1</sup> SM Surface Mount CM Cable/Suspended Mount <sup>2</sup>	<b>SHIELDING</b> RFA Ribbed Frosted Acrylic	<b>VOLTAGE</b> U 120V-277V	<b>OPTIONS</b> ELL14 Emergency Battery Pack Installed, 1400 Lumens <sup>3,4</sup> C488 4-Wire Flex GLR Fast Blow Fuse G1 Lens Gasketing WL Wet Location <sup>4</sup> CP Chicago Plenum			
<b>SIZE</b> 24 2' x 4'	<b>LUMEN OUTPUT</b> AX Ambient/Exam	<b>DRIVER</b> EAX Ambient/Exam						

**ACCESSORIES (ORDER SEPARATELY)**

**FK24** 2' x 4' Single Flange Kit (Shipped separately)

**PRODUCT AVAILABILITY**

SIZE	OUTPUT	LIGHT LEVEL	LUMENS	WATTS	LUMENS PER WATT
24	AX	Ambient	2950-3300	34	86-96
24	AX	Exam	7350-8275	81	91-103

Range represents 3000K through 4000K.

Lumens will vary according to color temperatures and other factors. See specific photometric test (s).

<sup>1</sup> For drywall order FK24 accessories separately.

<sup>2</sup> Order hanger accessories separately.

<sup>3</sup> For compatibility with Dual-Lite LiteGear® inverters in lieu of installed battery pack, contact Hubbell Lighting Representative.

<sup>4</sup> Wet Location not available with battery packs.

Test #15835 Test Date 2/16/2016

**PHOTOMETRIC DATA**

**LUMINAIRE DATA - AMBIENT MODE**

Luminaire	LTRX24-40AXG-RFA-EAXU LTRX LED Transition Exam Light, Recessed Architectural 2 x 4 LED with frosted linear prism lens
Ballast	XI054C150V054SNT1
Ballast Factor	1.00
Lamp	LED
Fixture Lumens	3313
Watts	34.40
Mounting	Recessed
Shielding Angle	0° = 90 90° = 90
Spacing Criterion	0° = 1.22 90° = 1.33
Luminous Opening in Feet	Length: 3.92 Width: 1.96 Height: 0.00

**ZONAL LUMEN SUMMARY**

Zone	Lumens	% Lamp	% Fixt.
0-30	839	25.3	25.3
0-40	1380	41.6	41.6
0-60	2480	74.8	74.8
0-90	3313	100.0	100.0
0-180	3313	100.0	100.0

**ENERGY DATA**

Total Luminaire Efficiency	100.0%
Total Lumens per Watt	96
IESNA RP-1-1993 Compliance	Non-Compliant
Comparative Yearly Lighting Energy Cost per 1000 Lumens	\$2.47 based on 3000 hrs. and \$0.08 per KWH

**INDOOR CANDELA PLOT**

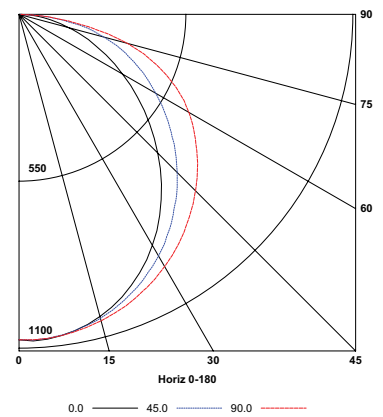

Test #16.00313 Test Date 2/16/2016

**LUMINAIRE DATA - EXAM MODE**

Luminaire	LTRX24-40AXG-RFA-EAXU LTRX LED Transition Exam Light, Recessed Architectural 2 x 4 LED with frosted linear prism lens
Ballast	XI054C150V054SNT1
Ballast Factor	1.00
Lamp	LED
Fixture Lumens	8283
Watts	80.80
Mounting	Recessed
Shielding Angle	0° = 90 90° = 90
Spacing Criterion	0° = 1.22 90° = 1.33
Luminous Opening in Feet	Length: 3.92 Width: 1.96 Height: 0.00

**ZONAL LUMEN SUMMARY**

Zone	Lumens	% Lamp	% Fixt.
0-30	2099	25.3	25.3
0-40	3450	41.6	41.6
0-60	6199	74.8	74.8
0-90	8283	100.0	100.0
0-180	8283	100.0	100.0

**ENERGY DATA**

Total Luminaire Efficiency	100.0%
Total Lumens per Watt	103
IESNA RP-1-1993 Compliance	Non-Compliant
Comparative Yearly Lighting Energy Cost per 1000 Lumens	\$2.35 based on 3000 hrs. and \$0.08 per KWH

**INDOOR CANDELA PLOT**

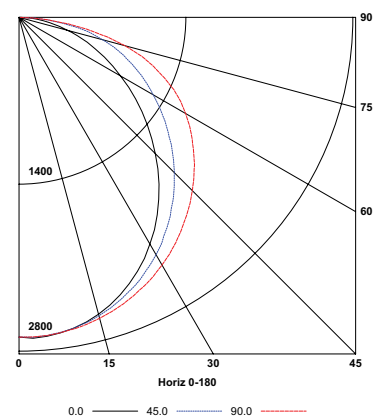

### DIMENSIONAL DATA — GRID

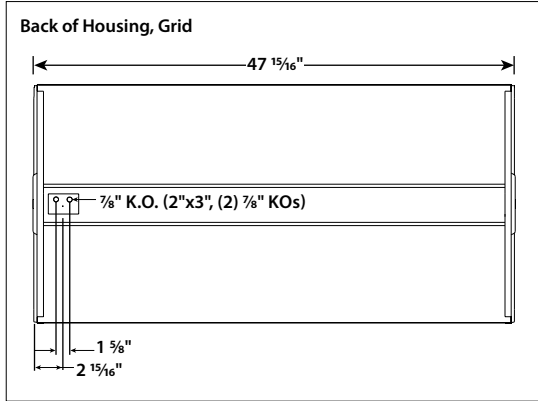
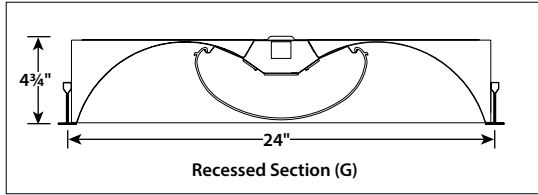

### CEILING COMPATIBILITY

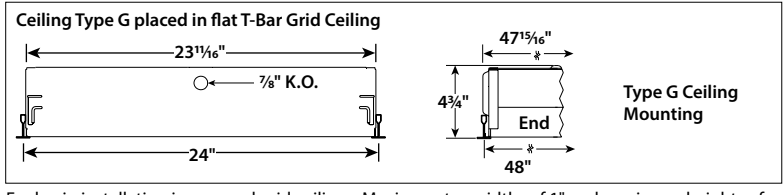

For lay-in installation in exposed grid ceilings. Maximum tee widths of 1" and maximum heights of 1 1/2" allowed.

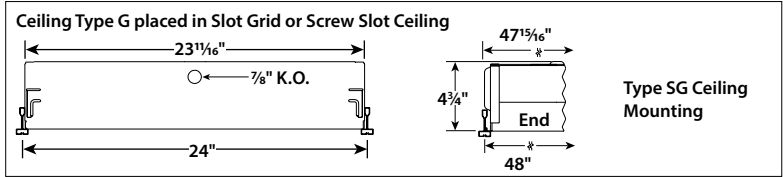

For 3/16" slot grid type ceilings. Luminaire will be regressed 3/8" from the horizontal surface of the tee.

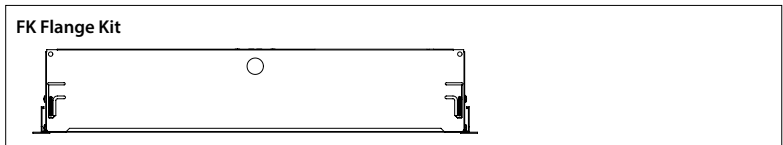

For hard ceiling applications, fixtures must be ordered with a flange kit that wires directly into the concealed ceiling opening for a clean finished appearance. For row configurations contact your local Columbia Representative.

Flange kit cut out dimension for single FK24: 24 3/8" x 48 3/8"

### DIMENSIONAL DATA — SURFACE MOUNT

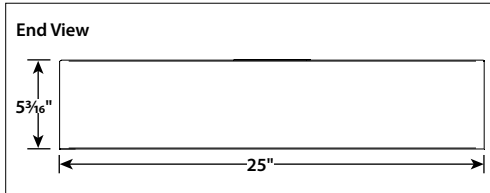
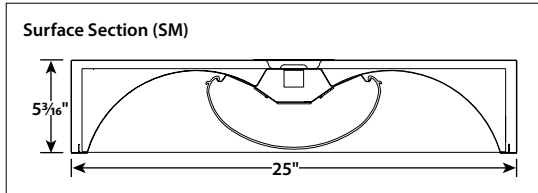

### Back of Housing, Surface Mount (SM) and Cable Mount (CM)

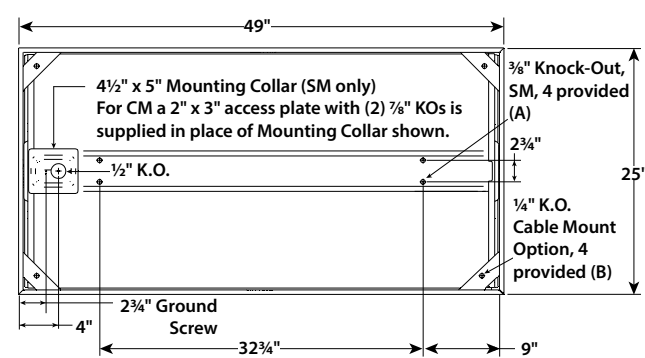

**Surface Mount:**  
Order SM ceiling type. Mounting collar required for surface mounting. (4) Mounting knock-outs, 3/8", provided in center channel as indicated at left, marked "A".

**Cable Mount:**  
Order CM ceiling type. Use CM48Y2SC3F-KIT 48" Cable Mount Kit for 2' wide SM trim fixtures. Mounting holes are provided in diagonal straps shown at left, marked "B".

**NOTE:** All dimensions are in inches; dimensions and specifications are subject to change without notice. Please consult factory or check sample for verification.