

8" LED Downlight LF8SL LENS

120V-277V
0-10V Dimming

APPLICATIONS:

LiteFrame LF8SL is a 8" specification grade LED lensed downlight that utilizes high efficiency LEDs to obtain color consistency, energy savings, and low maintenance costs. 50,000 hours minimum life up to 35°C (95°F) in open plenum applications.

HOUSING:

One-piece 22 gauge non-corrosive steel platform. Pre-wired i-box with snap-on cover for easy access. Snap-in-connection from driver compartment allows easy installation of light engine/trim assembly without tools above or below the ceiling and can be upgraded to accommodate technology improvements. Approve for 8 (4 in/4 out) No. 12 AWG conductors rated for 90°C through wiring.

REFLECTOR:

High purity aluminum, Alzak, iridescence suppressed, semi-diffuse reflector. Self-trim standard. Painted white self-trim (WT) available as option.

LED LIGHT ENGINE:

The LF8SL uses the Philips Fortimo DLM LED Module. This module provides controlled color consistency (3 SDCM) from fixture to fixture. The system is designed for optional life and lumen maintenance (>50,000 hours at 70% lumen maintenance). Both reflector and light engine assembly are mechanically retained to housing.

LED DRIVER:

The LF8SL utilizes the Philips Fortimo LED Driver specifically designed to optimize efficiency of the Fortimo DLM Module.

Driver is designed to match the 50,000 hour minimum life expectancy of the system. Meets UL Class 2, inherent short circuit protection, self limited, overload protected. If critical temperatures are reached on driver or LED module, integrated thermal feedback loop will gradually reduce current to protect system life. Driver is universal 120V-277V. Optional Lutron Series A driver is also available.

DIMMING:

Comes standard with 0-10V dimming capability. Flicker-free dimming to 10%. 0-10V control may consume up to 1mA. 0-10V, Lutron 2 wire and EcoSystem dimming available to 1% and DMX with RDM (remote device management) dimming to less than 0.1%.

INSTALLATION:

Adjustable Bar hangers included. Universal adjustable mounting brackets also accept 1/2" EMT conduit or 1 1/2" or 3/4" lathing channel (by others) or Prescolite 24" bar hangers (B24 or B6).

CERTIFICATIONS:

CSA certified to US and Canadian safety standards. Suitable for wet locations. Approved for through wiring. Non-IC rated. EMR is damp rated.

WARRANTY:

5 year warranty. See www.prescolite.com for details.

DATE: _____ TYPE: _____

FIRM NAME: _____

PROJECT: _____

LiteFrame®

Ceiling Cutout: 8 1/4"
Maximum Ceiling Thickness 1 1/4"
For conversion to millimeters,
multiply inches by 25.4
Not to Scale

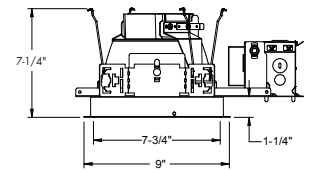
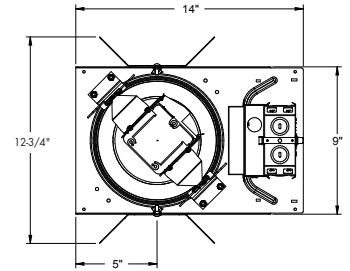

See page 4 for EMR and NX(W)E line art.

EXAMPLE: LF8SL-8LFSL15L40K8DL

CATALOG NUMBER:

Order housing, reflector, and accessories separately

STANDARD 0-10V DIMMING

ALTERNATIVE DIMMING TO 1% & 0.1%

HOUSING	DRIVER OPTION	HOUSING OPTION	TRIM APERTURE	KELVIN	CRI	REF. COLOR OPTIONS	TRIM OPTIONS	ACCESSORIES	
<input type="checkbox"/> LF8SL Standard Lumen 0-10V 10% dimming 120-277V	Standard 0-10V 10% Dimming <input type="checkbox"/> DM1 0-10V dimming at 1% <input type="checkbox"/> DMT^{9,10} SpectraSync™ Tunable White <input type="checkbox"/> DMTW¹¹ SpectraSync™ Tunable Dim to Warm VOLTAGE OPTION Standard 120V-277V <input type="checkbox"/> 347 347V	<input type="checkbox"/> EMR² Emergency Battery Pack with remote test switch and indicator light <input type="checkbox"/> LV⁷ Lutron Vive Enabled, 0-10V, 120-277V <input type="checkbox"/> NXWE^{4,13} NX Wireless Enabled <input type="checkbox"/> NXE^{4,13} NX Enabled, Dual SmartPorts	<input type="checkbox"/> 8LFSL Semi-Diffuse Clear Alzak OUTPUT <input type="checkbox"/> 11L 1100 Lumen Module <input type="checkbox"/> 15L 1500 Lumen Module <input type="checkbox"/> 20L¹² 2000 Lumen Module	<input type="checkbox"/> 27K 2700 Kelvin <input type="checkbox"/> 30K 3000 Kelvin <input type="checkbox"/> 35K 3500 Kelvin <input type="checkbox"/> 40K 4000 Kelvin <input type="checkbox"/> 50K 5000 Kelvin <input type="checkbox"/> 2230TD³ 2200K-3000K SpectraSync™ Dim to Warm <input type="checkbox"/> 2750T³ 2700K-5000K SpectraSync™ Tunable White <input type="checkbox"/> 2765T³ 2700K-6500K SpectraSync™ Tunable White	<input type="checkbox"/> 8 80+ CRI <input type="checkbox"/> 9 90+ CRI REF. FINISH OPTIONS Standard Semi-Diffuse <input type="checkbox"/> SP Specular <input type="checkbox"/> SS Semi-Specular <input type="checkbox"/> MFC American Matte™ <input type="checkbox"/> V Kurt Versen Specular <input type="checkbox"/> VS Kurt Versen Softglow® <input type="checkbox"/> VSS Kurt Versen SoftSheen™	Standard Clear Alzak <input type="checkbox"/> CG Champagne Gold Alzak <input type="checkbox"/> GD Gold Alzak <input type="checkbox"/> BL Black Alzak <input type="checkbox"/> WE Wheat Alzak <input type="checkbox"/> LW Light Wheat Alzak <input type="checkbox"/> PW Pewter Alzak <input type="checkbox"/> WH Painted Matte White Reflector and Flange <input type="checkbox"/> BC Painted Black Reflector and Flange	<input type="checkbox"/> WT Painted White Flange Only <input type="checkbox"/> TRG Trim Ring Gasket <input type="checkbox"/> WF Wide Flange <input type="checkbox"/> BNCT^{6,8} Black Non- conductive trim <input type="checkbox"/> WNCT^{6,8} White Non- conductive trim <input type="checkbox"/> BNCTB^{6,8} Black Non- conductive trim Baffled <input type="checkbox"/> WNCTB^{6,8} White Non- conductive trim Baffled	<input type="checkbox"/> B24 Set of two 24" bar hangers for T-bar ceilings <input type="checkbox"/> B6 Set of two (2) bar hangers for ceiling joist up to 24" centers <input type="checkbox"/> LFSC8 8" Reflector screw cover <input type="checkbox"/> SCA8D Sloped ceiling adapter (see note on back page) <input type="checkbox"/> LiteGear⁵ Inverter, single phase central lighting, 125VA-250VA <input type="checkbox"/> LPS Series⁵ LitePower micro-inverter, 20VA-55VA	
Use with EDM/2DM/DMX dimming option: Match Housing to Trim Output									
<input type="checkbox"/> LF8SL11L <input type="checkbox"/> LF8SL15L <input type="checkbox"/> LF8SL20L	<input type="checkbox"/> EDM¹ HiLume 1% EcoSystem LED Driver <input type="checkbox"/> 2DM¹ HiLume 1% 2-wire LED Driver (120V only) <input type="checkbox"/> DMX¹ DMX with RDM dimming to <0.1% VOLTAGE OPTION <input type="checkbox"/> 120 120V <input type="checkbox"/> 277 277V	<input type="checkbox"/> LVE (EDM Only) Lutron Vive Enabled, EcoSystem <i>*EDM, 2DM & DMX also available with EMR and VVV</i>							LENS <input type="checkbox"/> CL Clear Lens (Regressed Standard) <input type="checkbox"/> DL Diffuse Lens (Regressed Standard)
Notes: 1 For EDM, 2DM and DMX options, housing output must match trim output 2 Not available with 347V 3 Only available in 90+ CRI 4 Not available with EMR, DMX, LV or LVE 5 See Central Inverter compatibility note and web links on page 3 6 Not available with color/finish options. Semi-Diffuse finish only. 7 LV requires standard dimming or DM1 8 Must select CL or DL 9 Must select either 2750T or 2765T Kelvin with DMT driver option 10 Not available with LV or LVE 11 Must select 2230TD with DMTW driver option 12 Not compatible with DMT or DMTW 13 Not available with EDM, 2DM or DMX									



A Division of Hubbell Lighting, Inc.

In a continuing effort to offer the best product possible we reserve the right to change, without notice, specifications or materials that in our opinion will not alter the function of the product.
Web: www.prescolite.com • Tech Support: (888) 777-4832

LF8-LED-050

PHOTOMETRIC DATA

LiteFrame - 8" LF8SL Lens

DRIVER DATA	8LFSL20L	8LFSL15L	8LFSL11L	
Input Voltage	120-277V	120-277V	120-277V	
Input Frequency	50/60 Hz	50/60 Hz	50/60 Hz	
Input Current	0.184A (120V) 0.08A (277V)	0.133A (120V) 0.058A (277V)	0.104A (120V) 0.045A (277V)	
Input Power	22.1W	16.0W	12.5W	
Power Factor	≥0.90	≥0.90	≥0.90	
THD	<20%	<20%	<20%	
EMI Filtering	FCC 47CFR Part 15, Class A	FCC 47CFR Part 15, Class A	FCC 47CFR Part 15, Class A	
Operating Temperature	-20°C to 35°C	-20°C to 35°C	-20°C to 35°C	
Dimming	0-10V	0-10V	0-10V	
Over-voltage, over-current, short-circuit protected				
*Power consumption and photometric output may vary slightly with various driver and CRI options.				
When operating in EM mode, the fixture will deliver approximately 30% of the published full lumen output.				
				Lumen Multiplier Table
				Photometrics published below are for the 3000K, 80 CRI.
				This table may be used to approximate the lumen values at different Kelvin temperatures and CRI.
				4000 Kelvin 1.07
				3500 Kelvin 1.00
				3000 Kelvin 1.00
				2700 Kelvin 0.95
				80 CRI.....1.00
				90 CRI.....0.91

Delivered Lumens

The table below shows the delivered lumens for the various lumen outputs.

Output	CRI	Lens	Delivered Lumens	Input Watts	Lumens Per Watt	Full Catalog String
11L	80	CL	1082	12.7	85	LF8SL-8LFSL11L30K8CL
15L	80	CL	1454	16.2	90	LF8SL-8LFSL15L30K8CL
20L	80	CL	1912	21.5	89	LF8SL-8LFSL20L30K8CL
11L	80	DL	1050	12.5	84	LF8SL-8LFSL11L30K8DL
15L	80	DL	1407	16.2	87	LF8SL-8LFSL15L30K8DL
20L	80	DL	1854	21.6	86	LF8SL-8LFSL20L30K8DL

LF8SL-8LFSL20L30K8DL

LED Light Engine: 3000K, 80 CRI
System Wattage: 21.6W
Fixture Delivered Lumens: 1854
Fixture Efficacy: 86
Spacing Criteria: 1.2

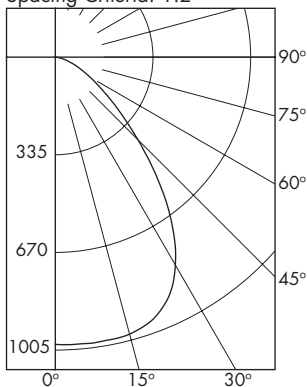

Test No. 18.00445-02

Tested at 25°C Ambient in accordance to IESNA LM-79-2008

ZONAL LUMEN SUMMARY

ZONE	LUMENS	%LUMINAIRE
0-30	790	43
0-40	1223	66
0-60	1716	93
0-90	1853	100
90-180	0	0
0-180	1853	100

LUMINANCE DATA IN CANDELA/SQ. METER

Angle in Vertical	Average
45°	18608
55°	11318
65°	7269
75°	4479
85°	1330

COEFFICIENTS OF UTILIZATION ZONAL CAVITY METHOD

Room Cavity Ratio	% Effective Ceiling Cavity Reflectance																
	80		70		50		30		10								
	70	50	30	10	70	50	30	10	50	30	10						
1	111	108	105	102	109	106	103	100	101	99	97	98	96	94	93	91	
2	104	97	92	87	101	95	90	86	92	88	84	89	85	82	86	83	81
3	96	88	81	76	94	86	80	75	83	78	74	81	76	73	78	75	72
4	89	80	72	67	87	78	71	66	76	70	65	74	69	65	72	67	64
5	83	72	65	59	81	71	64	59	69	63	58	68	62	58	66	61	57
6	78	66	59	53	76	65	58	53	64	57	52	62	56	52	61	56	52
7	73	61	53	48	71	60	53	48	59	52	47	57	52	47	56	51	47
8	68	56	49	44	67	56	48	43	54	48	43	53	47	43	52	47	43
9	64	52	45	40	63	51	44	40	50	44	39	49	44	39	48	43	39
10	60	48	41	37	59	48	41	36	47	41	36	46	40	36	45	40	36

LF8SL-8LFSL20L30K8DL

Test No. 18.00445-02



Web: www.prescolite.com • Tech Support: (888) 777-4832
701 Millennium Boulevard • Greenville, SC 29607 U.S.A. • Phone (864) 678-1000
Copyright ©2018 Prescolite, Inc., a division of Hubbell Lighting, Inc. All Rights Reserved
Specifications subject to change without notice. • Printed in U.S.A. • LFR-LED-050 • 01/16/19



PHOTOMETRIC DATA

LiteFrame - 8" LF8SL Lens

LF8SL-8LFSL15L30K8DL

LED Light Engine: 3000K, 80 CRI
 System Wattage: 16.2W
 Fixture Delivered Lumens: 1407
 Fixture Efficacy: 87
 Spacing Criteria: 1.2

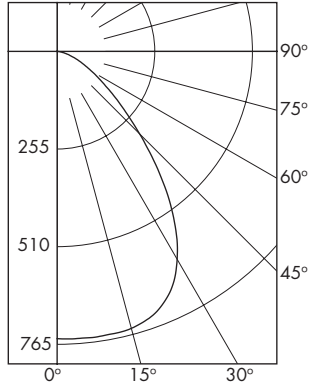

Test No. 18.00445-01

Tested at 25°C Ambient in accordance to IESNA LM-79-2008

ZONAL LUMEN SUMMARY

ZONE	LUMENS	%LUMINAIRE
0-30	600	32
0-40	928	50
0-60	1302	70
0-90	1406	76
90-180	0	0
0-180	1406	76

LUMINANCE DATA IN CANDELA/ SQ. METER

Angle in Vertical	Average
45°	14121
55°	8589
65°	5517
75°	3399
85°	1009

COEFFICIENTS OF UTILIZATION ZONAL CAVITY METHOD

Room Cavity Ratio	% Effective Ceiling Cavity Reflectance																
	80					70					50						
	20% Effective Floor Cavity Reflectance																
	% Wall Reflectance																
	70	50	30	10	70	50	30	10	50	30	10	50	30	10			
1	111	108	105	102	109	106	103	100	101	99	97	98	96	94	94	93	91
2	104	97	92	87	101	95	90	86	92	88	84	89	85	82	86	83	81
3	96	88	81	76	94	86	80	75	83	78	74	81	76	73	78	75	72
4	89	80	72	67	87	78	71	66	76	70	65	74	69	65	72	67	64
5	83	72	65	59	81	71	64	59	69	63	58	68	62	58	66	61	57
6	78	66	59	53	76	65	58	53	64	57	52	62	56	52	61	56	52
7	73	61	53	48	71	60	53	48	59	52	47	57	52	47	56	51	47
8	68	56	49	44	67	56	48	43	54	48	43	53	47	43	52	47	43
9	64	52	45	40	63	51	44	40	50	44	39	49	44	39	48	43	39
10	60	48	41	37	59	48	41	36	47	41	36	46	40	36	45	40	36

LF8SL-8LFSL15L30K8DL

Test No. 18.00445-01

LF8SL-8LFSL11L30K8DL

LED Light Engine: 3000K, 80 CRI
 System Wattage: 12.5W
 Fixture Delivered Lumens: 1050
 Fixture Efficacy: 84
 Spacing Criteria: 1.2

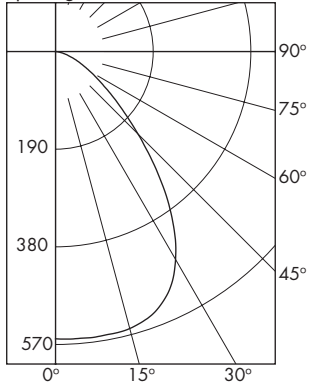

Test No. 18.00445

Tested at 25°C Ambient in accordance to IESNA LM-79-2008

ZONAL LUMEN SUMMARY

ZONE	LUMENS	%LUMINAIRE
0-30	448	42.6
0-40	692	66.0
0-60	972	92.6
0-90	1050	100.0
90-180	0	0.0
0-180	1050	100.0

LUMINANCE DATA IN CANDELA/ SQ. METER

Angle in Vertical	Average
45°	10548
55°	6416
65°	4121
75°	2539
85°	754

COEFFICIENTS OF UTILIZATION ZONAL CAVITY METHOD

Room Cavity Ratio	% Effective Ceiling Cavity Reflectance																
	80					70					50						
	20% Effective Floor Cavity Reflectance																
	% Wall Reflectance																
	70	50	30	10	70	50	30	10	50	30	10	50	30	10			
1	111	108	105	102	109	106	103	100	101	99	97	98	96	94	94	93	91
2	104	97	92	87	101	95	90	86	92	88	84	89	85	82	86	83	81
3	96	88	81	76	94	86	80	75	83	78	74	81	76	73	78	75	72
4	89	80	72	67	87	78	71	66	76	70	65	74	69	65	72	67	64
5	83	72	65	59	81	71	64	59	69	63	58	68	62	58	66	61	57
6	78	66	59	53	76	65	58	53	64	57	52	62	56	52	61	56	52
7	73	61	53	48	71	60	53	48	59	52	47	57	52	47	56	51	47
8	68	56	49	44	67	56	48	43	54	48	43	53	47	43	52	47	43
9	64	52	45	40	63	51	44	40	50	44	39	49	44	39	48	43	39
10	60	48	41	37	59	48	41	36	47	41	36	46	40	36	45	40	36

LF8SL-8LFSL11L30K8DL

Test No. 18.00445



Dimming Compatibility Table

Dimming Ballast	Manufacturer	Web Link
DM/DM1	Lutron DTV	http://bit.ly/11jSvZg
DM/DM1	Leviton AWRMG-7xx, AWSMG-7xx, AWSMT-7xx	http://bit.ly/1Bjn2R9
EDM	Lutron	http://bit.ly/1vijHAL
2DM	Lutron	http://bit.ly/1S4WjXK

DMX

See instruction sheet on www.prescolite.com for connection & installation information.
Other useful links: <http://www.eldoled.com/led-drivers/powerdrive/50-watt/ac-561s/>

Central Inverters

For full fixture output in back-up mode, we recommend you visit www.dual-lite.com for your Central Lighting Inverter options. Please contact your local Hubbell representative for any assistance with proper sizing and loading of your inverter selection. Central lighting inverters must be ordered separately.

LiteGear: www.dual-lite.com/products/litegear_lg_series

LPS Series: www.dual-lite.com/products/lps

SpectraSync™ Color Tuning Technology:

Control your space based on the needs of the application, specific activities throughout the day and preferences of the occupants with two distinct SpectraSync™ Color Tuning Technology.

Dim to Warm: Dim to Warm mimics the familiar warming effect that occurs with traditional incandescent sources as they are dimmed.
(Available with 2200K-3000K).

Tunable White: Tunable White offers users the ability to tailor CCT to their personal preference, enhancing task visibility, material and colors or the aesthetics of the space. (Available with 2700K-5000K or 2700K-6500K).

See separate [SpectraSync™ Tech Sheet](#) for additional details.

NX Distributed Intelligence:

Supports indoor and outdoor applications, wired, wireless and hybrid networked NX lighting control deployments and enables emerging applications such as Hubbell Lighting's SpectraSync™ color tuning technology.

See separate [NX™ Solutions Guide](#) for additional details.

See Hubbell Controls Solution [NX Brochure](#).

NOTES:

When ordering a sloped ceiling adapter, specify the degree of slope in 5° increments, max. of 35°. For a more precise degree or wet ceiling applications, please contact factory. Sloped ceiling adapter and housing must be installed at the same time.

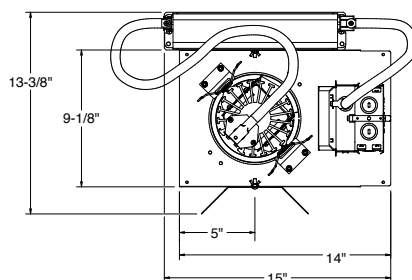

LF8SL EMR

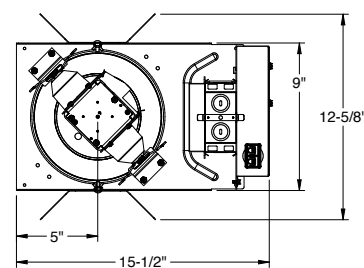

LF8SL LENS NX(W)

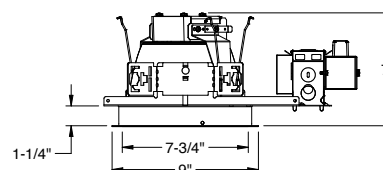
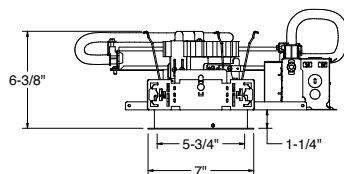

Web: www.prescolite.com • Tech Support: (888) 777-4832
701 Millennium Boulevard • Greenville, SC 29607 U.S.A. • Phone (864) 678-1000
Copyright ©2018 Prescolite, Inc., a division of Hubbell Lighting, Inc. All Rights Reserved
Specifications subject to change without notice. • Printed in U.S.A. • LFR-LED-050 • 01/16/19

