

**V Mount** 1:8 Scale

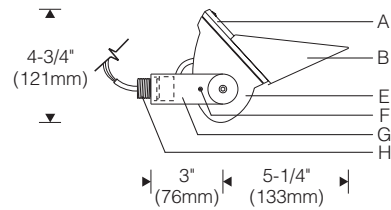

**S Mount** 1:8 Scale  
(weatherproof outlet box included)

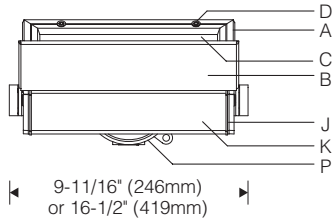

**Cantilever** 1:12 Scale  
(for use with X mount)

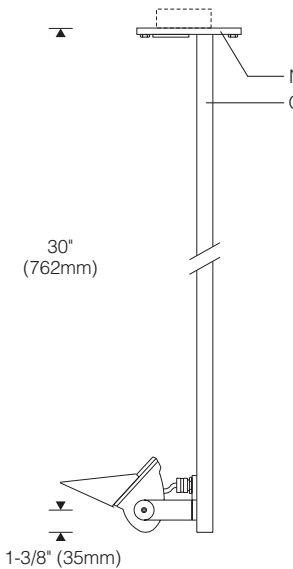

**Side-Mount Slipfitter** 1:12 Scale  
(for use with X mount)

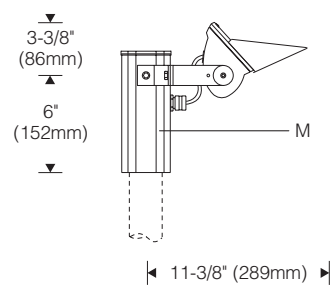

**Top-Mount Slipfitter** 1:12 Scale  
(for use with X mount)

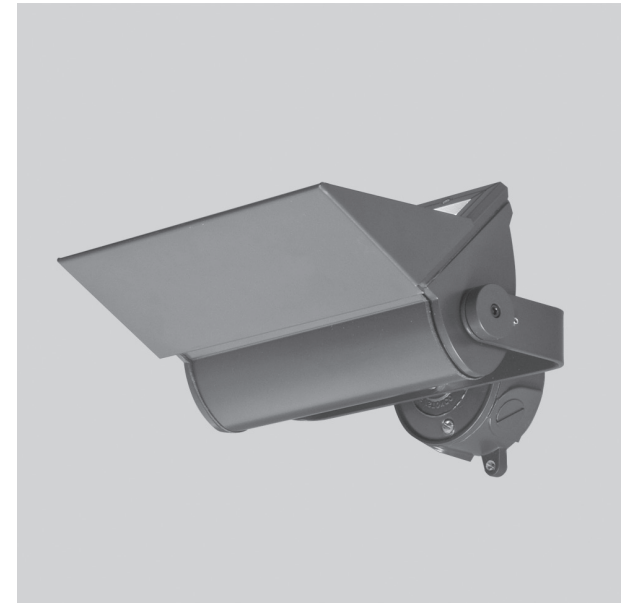
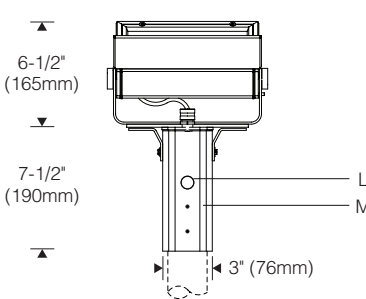

**Specifications**

- |   |   |   |  |
|---|---|---|--|
| <b>A</b> Mitred extruded aluminum door frame        | <b>D</b> Tamper-resistant captive door screws | <b>K</b> Specular extruded aluminum housing                         | <b>N</b> Welded aluminum mounting plate with splice access cover |
| <b>B</b> Aluminum cutoff visor (included)           | <b>E</b> Die-cast aluminum end plates         | <b>L</b> 1/2" NPT entry (with plug)                                 | <b>O</b> 1" x 1-1/2" aluminum arm                                |
| <b>C</b> Clear impact resistant tempered glass lens | <b>F</b> Locking set screw                    | <b>M</b> Extruded aluminum slipfitter for 2-3/8" O.D. pole or tenon | <b>P</b> Weatherproof outlet box (S mount)                       |
|   | <b>G</b> Aluminum yoke                        |   |  |
|   | <b>H</b> 1/2" NPT nipple                      |   |  |
|   | <b>J</b> Aluminum reveal plates (black)       |   |  |

**Optic Assembly:**

Two-piece extruded aluminum heat sink housing and light engine. Exterior heat sink anodized for maximum emissivity. Removable interior extrusion treated to maximize thermal conductivity. Precision extruded polymer refractive lens with optimal distribution. Tempered microprismatic glass.

**Finish:**

Exterior surfaces – 6 stage pretreatment and electrostatically applied thermoset polyester powder coating for a durable abrasion, fade and corrosion resistant finish. Choice of semigloss colors (see ordering information).

Extruded aluminum heat sink/housing plus yoke, door frame and decorative end plates are finished in color. All hardware and components – non-corrosive stainless steel or aluminum.

**Mounting:**

**S** mount provided with 1/2" NPT nipple, wet location outlet box and cover finished to match the luminaire. **V** mount provided with 1/2" NPT nipple only.

**X** mount for use with required aluminum cantilever or slipfitter — ordered and priced separately; see SU1.1. Top or side mount slipfitter for 2-3/8" O.D. stanchion, pole (by others). Fixture weight: 4.5 lb (2.0 kg).

**Electrical:**

Integral electronic HPF constant current driver. For complete driver specifications, see website, reference document [MA-1303](#). Leads exit housing through watertight flush cord entry and silicone coated fiberglass sleeving with 8" (.2m) exposed beyond nipple. 60" (1.5m) leads for **X** mount.

**Standard:**

UL listed or CSA certified for wet locations. Approved for use in interior damp locations such as natatoriums. 5 year warranty, maximum ambient temperature 45°C (113°F).

**Features**

- Compact size, – ideal for unobtrusively uplighting soffits, canopies, vaults
- Durable and secure – thermal and impact resistant lens, tamper-resistant fasteners, set screw in yoke locks aiming
- Precured silicone gaskets, unique flush cord entry – seal out dirt and moisture, maintain performance



**Performance**

Precisely extruded polymer lens produces an asymmetric distribution ideal for illuminating horizontal surfaces evenly.

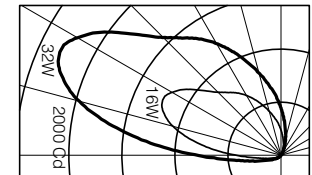

L90(10k) > 60,000 hrs. @ 25°C per TM-21

For LM79 and photometric reports, visit [thelightingquotient.com](http://thelightingquotient.com)



*To form a Catalog Number*

S **1** **7** **0** | | | | | | | | | |  
**1** **2** **3** **4** **5** **6** **7** **8** **9** **10**

Project: \_\_\_\_\_

Type: \_\_\_\_\_

**1 Source**

S = Solid state (LED)

**2 Style**

170 = Small wet location LED with integral driver

**3 Length / Light Output / Power**

ORDER CODE	LENGTH	LUMENS	INPUT WATTS	NUMBER OF LEDS	DRIVE CURRENT
L028	9"	925	8	28	175mA
M028	9"	1789	16	28	350mA
L056	16"	1899	16	56	175mA
M056	16"	3673	32	56	350mA

Based on 3500K/80+CRI. [Click here](#) for scaled performance table.

**4 Mounting**

S = External yoke with 1/2" NPT nipple, wet location outlet box and cover finished to match luminaire  
 V = External yoke with 1/2" NPT nipple (box, cover by others)  
 X = External yoke for use with required cantilever or slipfitter — ordered and priced separately, see hangers at right

**5 Finish**

02 = Semigloss white    15 = Metallic    99 = Custom or RAL, consult sales rep.\*  
 06 = Dark bronze\*    17 = Champagne\*  
 07 = Silver\*    18 = Copper\*  
 08 = Semigloss black

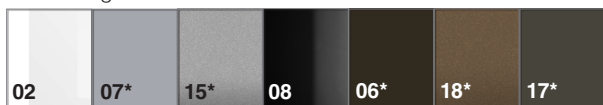

\* = non-cancellable/returnable

**6 Voltage**

M = 120-277V Universal voltage input  
 K = 347V input

**7 Option** (see Accessories Section for specifications)

V0 = Cutoff visor included, no other options  
 VX = For modification not listed, include detailed description. Consult factory prior to specification.  
**Note:** Cutoff visor included unless specified otherwise.

**8 Destination Requirement**

0 = UL listed or CSA certified for U.S.  
 J = UL listed or CSA certified for Canada

**9 Color Temperature / CRI**

827 = 2700K, 80+ CRI    927 = 2700K, 90+ CRI  
 830 = 3000K, 80+ CRI    930 = 3000K, 90+ CRI  
 835 = 3500K, 80+ CRI    935 = 3500K, 90+ CRI  
 840 = 4000K, 80+ CRI    940 = 4000K, 90+ CRI

**Note:** Additional CCT and CRI options are available; consult factory.  
 RGBW - Consult factory.



**10 Dimming\*\***

00 = Non-dimming  
 TD = ERP forward phase or reverse phase (120V only), dimming range 100-10% power, compatible controls by others  
 ZX = 0-10V analog dimming 120-277V or 347V input, dimming range 100%-5%, 0-10V controls by others  
 \*\*Dimming range refers to % power input, % light output will vary.

Refer to Driver Information document [MA-1303](#)

**Example**

**S170-M028-V-06-M-00-0-30-TD**

Small wet location LED, extruded aluminum heat sink/housing, yoke, door frame, visor and decorative end plates finished dark bronze. Integral 120-277V 700mA dimming driver compatible with forward phase, reverse phase or 0-10V dimming controls by others, dims to 10% power, UL listed or CSA certified for U.S., wet locations. 3000K/80+ CRI.

**Required Mounting Hangers (X mount)**

Required ACJ or ASP mounting hangers for X mount cantilever or slipfitter fixtures are ordered and priced separately. See installation sheets on website.

ACJ | 30 | = **Cantilever**,  
 30" (760mm) setback  
 (for use with X mount unit)  
 0 = U.S.  
 J = Canada  
**5 Finish**



AMS | 000 | = Surface mount **splice box**  
 for use with ACJ cantilever  
**5 Finish**

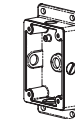

ASP | T10 | = **Top-mount slipfitter**,  
 for 2-3/8" O.D. pole,  
 stanchion or tenon  
 (for use with single  
 X mount unit)  
**5 Finish**

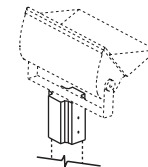

ASP | S | 0 = **Side-mount slipfitter**,  
 for 2-3/8" O.D. pole,  
 stanchion or tenon  
 (for use with  
 X mount units)  
 1 = Single unit  
 2 = Double unit  
**5 Finish** (back to back)

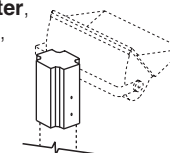

**Accessories**

Order separately. See Accessories Section for specifications.

AE | V | 0D0 = External vertical blade **baffle**, black  
 2 = 25° shielding  
 4 = 45°  
 G = 8" long fixture  
 M = 16" long fixture

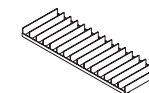

The external shapes of the housings are trademarks of Sylvan R. Shemitz Designs, LLC dba **The Lighting Quotient**, makers of **elliptipar**, **tambient** and **fragtir**.

Certain products illustrated may be covered by applicable patents and patents pending. These specifications supersede all prior publications and are subject to change without notice. Copyright © 2021 Sylvan R. Shemitz Designs, LLC, all rights reserved.



elliptipar from **The Lighting Quotient**  
 114 Boston Post Road, West Haven, Connecticut 06516, USA  
 Voice 203.931.4455 • Fax 203.931.4464 • [thelightingquotient.com](#)