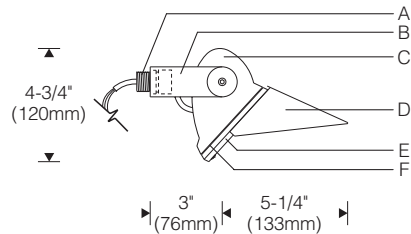
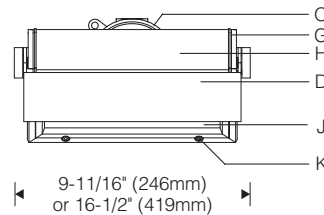
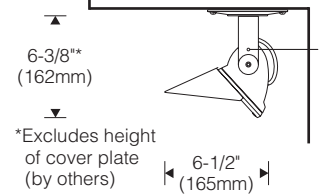
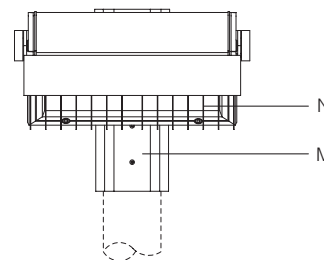
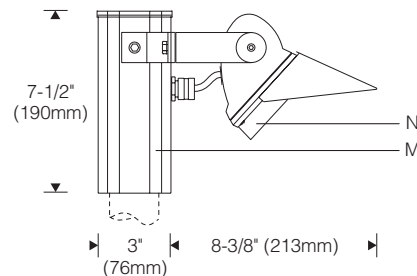
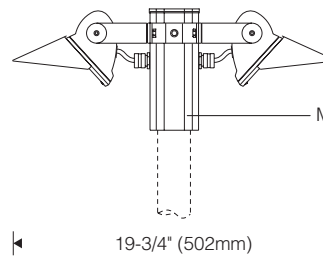

V Mount 1:8 Scale**S Mount** 1:8 Scale
(weatherproof outlet box included)**V Mount** 1:12 Scale
(shown mounted under soffit/overhang)**Slipfitter: Single Unit** 1:8 Scale (for use with **X** mount)**Slipfitter: Double** 1:12 Scale**Specifications**

A 1/2" NPT nipple	F Precured silicone door and lens gasket	J Clear impact resistant tempered glass lens	extruded aluminum slipfitter for 2-3/8" O.D. pole or tenon
B Aluminum yoke	G Aluminum reveal plates (black)	K Tamper-resistant captive door screws	N Accessory vertical blade cross baffle (black)
C Die-cast aluminum end plates	H Specular extruded aluminum housing	L Locking set screw	O Weatherproof outlet box (S mount)
D Aluminum cutoff visor (included)		M Required (X mt)	
E Mitred extruded aluminum door frame			

Optic Assembly:

Two-piece extruded aluminum heat sink housing and light engine. Exterior heat sink anodized for maximum emissivity. Removable interior extrusion treated to maximize thermal conductivity. Precision extruded polymer refractive lens with optimal distribution. Tempered microprismatic glass.

Finish:

Exterior surfaces – 6 stage pretreatment and electrostatically applied thermoset polyester powder coating for a durable abrasion, fade and corrosion resistant finish. Choice of semigloss colors (see ordering information).

Extruded aluminum heat sink/housing plus yoke, door frame, cutoff visor and decorative end plates are finished in color. All hardware and components – non-corrosive stainless steel or aluminum.

Mounting:

S mount provided with 1/2" NPT nipple, wet location outlet box and cover finished to match the luminaire. **V** mount provided with 1/2" NPT nipple only.

X mount for use with required slipfitter, ordered and priced separately — see pg. SG1.1. Side mount slipfitter for 2-3/8" O.D. stanchion, pole (by others). Fixture weight: 4.5 lb (2.0 kg).

Electrical:

Integral electronic HPF constant current driver. For complete driver specifications, see website, reference document **MA-1303**. Leads exit housing through watertight flush cord entry and silicone coated fiberglass sleeving with 8" (.2m) exposed beyond nipple. 60" (1.5m) leads for **X** mount.

Standard:

UL listed or CSA certified for wet locations. Approved for use in interior damp locations such as natatoriums. 5 year warranty, maximum ambient temperature 45°C (113°F).

Features

- High performance asymmetric lighting for broad areas where pedestrian scale, controlled distribution are desired
- Durable and secure – thermal and impact resistant lens, tamper-resistant fasteners, set screw in yoke locks aiming
- Non-corrosive aluminum and stainless steel construction – seal out dirt and moisture, maintain performance

Performance

Precisely extruded polymer lens produces an asymmetric distribution ideal for illuminating horizontal surfaces evenly.

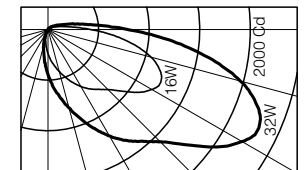

L90(10k) > 60,000 hrs. @ 25°C per TM-21

For LM79 and photometric reports, visit thelightingquotient.com



To form a Catalog Number

S **1 7 0** - - - - -
1 2 3 4 5 6 7 8 9 10

Project: _____

Type: _____

1 Source

S = Solid state (LED)

2 Style

170 = Small wet location LED with integral driver

3 Length / Light Output / Power

ORDER CODE	LENGTH	LUMENS	INPUT WATTS	NUMBER OF LEDS	DRIVE CURRENT
L028	9"	925	8	28	175mA
M028	9"	1789	16	28	350mA
L056	16"	1899	16	56	175mA
M056	16"	3673	32	56	350mA

Based on 3500K/80+CRI. [Click here](#) for scaled performance table.

4 Mounting

S = External yoke with 1/2" NPT nipple, wet location outlet box and cover finished to match luminaire
V = External yoke with 1/2" NPT nipple (box, cover by others)
X = External yoke for use with required slipfitter — ordered and priced separately, see **ASP** hangers at right

5 Finish

02 = Semigloss white **15** = Metallic **99** = Custom or RAL, consult sales rep.*
06 = Dark bronze* **17** = Champagne*
07 = Silver* **18** = Copper*
08 = Semigloss black

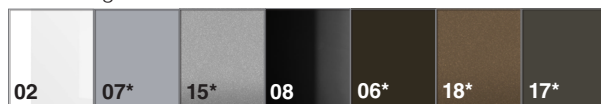

* = non-cancellable/returnable

6 Voltage

M = 120-277V Universal voltage input
K = 347V input

7 Option (see Accessories Section for specifications)

V0 = Cutoff visor included, no other options
VX = For modification not listed, include detailed description. Consult factory prior to specification.

Note: Cutoff visor included unless specified otherwise.

8 Destination Requirement

0 = UL listed or CSA certified for U.S.
J = UL listed or CSA certified for Canada

9 Color Temperature / CRI

827 = 2700K, 80+ CRI **927** = 2700K, 90+ CRI
830 = 3000K, 80+ CRI **930** = 3000K, 90+ CRI
835 = 3500K, 80+ CRI **935** = 3500K, 90+ CRI
840 = 4000K, 80+ CRI **940** = 4000K, 90+ CRI

Note: Additional CCT and CRI options are available; consult factory.

RGBW - Consult factory.



10 Dimming**

00 = Non-dimming
TD = ERP forward phase or reverse phase (120V only), dimming range 100-10% power, compatible controls by others

ZX = 0-10V analog dimming 120-277V or 347V input, dimming range 100%-5%, 0-10V controls by others

**Dimming range refers to % power input, % light output will vary.

Refer to Driver Information document [MA-1303](#)

Example

S170-M056-V-06-M-00-0-830-TD

Small wet location LED, extruded aluminum heat sink/housing, yoke, door frame and decorative end plates finished dark bronze. Integral 120-277V 700mA dimming driver compatible Triac/ELV or 0-10V dimming controls by others, UL listed or CSA certified for U.S., wet locations. 3000K/80+ CRI.

Required Mounting Hangers (X mount)

Required **ASP** mounting hangers for **X** mount slipfitter fixtures are ordered and priced separately. See installation sheets on website.

ASP _____ **S** _____ **0** = **Side-mount slipfitter**, for 2-3/8" O.D. pole, tenon or rigid conduit (for use with **X** mount units)
1 = Single unit
2 = Double unit (back to back)

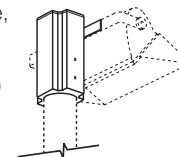

5 Finish

Accessories

Order separately. See Accessories Section for specifications.

AE _____ **V** _____ **0D0** = External vertical blade **baffle**, black
2 = 25° shielding
4 = 45°
G = 8" long fixture
M = 16" long fixture

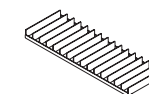

elliptipar from The Lighting Quotient
 114 Boston Post Road, West Haven, Connecticut 06516, USA
 Voice 203.931.4455 • Fax 203.931.4464 • thelightingquotient.com

The external shapes of the housings are trademarks of Sylvan R. Shemitz Designs, LLC dba **The Lighting Quotient**, makers of **elliptipar**, **tambient** and **fragtir**.

Certain products illustrated may be covered by applicable patents and patents pending. These specifications supersede all prior publications and are subject to change without notice. Copyright © 2021 Sylvan R. Shemitz Designs, LLC, all rights reserved.