

S Mount 1:10 Scale

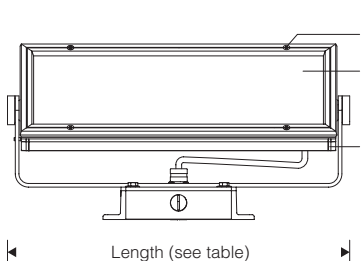

Mounting Plate

(S Mount)

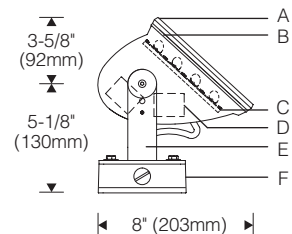
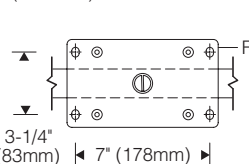

# of LEDs	Length
112	12-1/16" (306mm)
224	17-13/16" (452mm)
336	24-7/8" (632mm)

Side-Mount Slipfitter 1:10 Scale
(For use with X Mount)

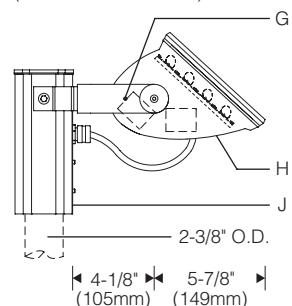

Cantilever, Lighting Downward
(For use with X Mount)

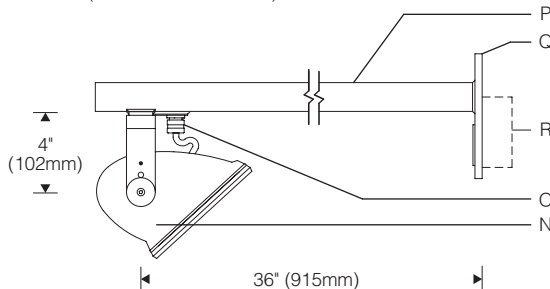

Lighting Upward 1:12 Scale
(Upward/Downward Optional)

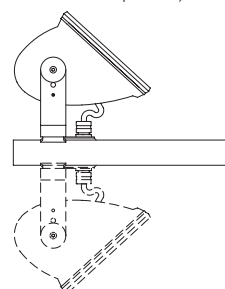

Specifications

- | | | | |
|---|---|---|--|
| A Mitred extruded aluminum door frame | E Aluminum yoke | K Tamper-resistant captive door screws | O 1/2" NPT nipple |
| B Precured silicone door and lens gasket | F Surface splice box | L Micro-prismatic impact resistant tempered glass lens | P 1-1/2" aluminum arm |
| C Field serviceable light engine with asymmetric optic | G Locking set screw | M Aluminum reveal plate (black) | Q Welded aluminum mounting plate with splice access cover |
| D Integral driver | H Specular extruded aluminum housing | N Die-cast aluminum end plates | R Outlet box (by others) |
| | J Extruded aluminum slipfitter | | |

Optic Assembly:

Two-piece extruded aluminum heat sink housing and light engine. Exterior heat sink anodized for maximum emissivity. Precision extruded polymer refractive lens with optimized asymmetric distribution. Light engine may be removed for service or upgrade. Clear Tempered micro-prismatic glass lens. Stainless steel hardware.

Finish:

Exterior surfaces – 6 stage pretreatment and electrostatically applied thermoset polyester powder coating for a durable abrasion, fade and corrosion resistant finish. Choice of semigloss colors (see ordering information). Extruded aluminum heat sink/housing plus yoke, door frame and decorative end plates are finished in color. All hardware and components – non-corrosive stainless steel or aluminum.

Mounting:

S mount provided with 1/2" NPT nipple, wet location outlet box and cover finished to match the luminaire.

X mount for use with required aluminum cantilever or slipfitter — ordered and priced separately, see SV3.1. Top or side mount slipfitter for 2-3/8" O.D. stanchion, pole (by others).

Fixture weights: 12" fixture 12.4 lb (5.6 kg); 17" fixture 16.2 lb (7.3 kg); 24" fixture 24.0 lb (10.9 kg).

Electrical:

Use 90°C wire for supply connections. Integral electronic HPF constant current driver. For complete driver specifications, see website, reference document [MA-1303](#).

Standard:

CSA certified to UL1598, UL8750, CSA C22.2 for wet locations. 5 year warranty, maximum ambient temperature 45°C (113°F).

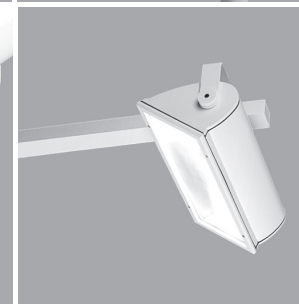

Features

- Extruded aluminum housing, die-cast aluminum end plates; 1000 hour salt-spray test to ASTM B117-90
- Silicone gaskets – keep dirt and moisture out
- Yoke set screw – securely locks aiming
- Asymmetric distribution – illuminates planes evenly



Performance

Precisely extruded acrylic lens produces an asymmetric distribution ideal for illuminating vertical surfaces evenly from top to bottom.

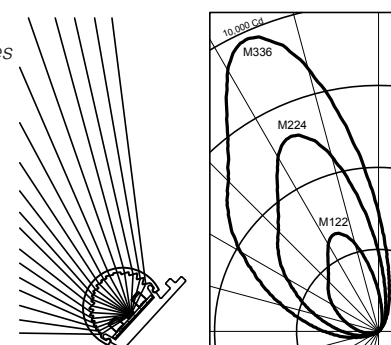

For LM79 and photometric reports, visit thelightingquotient.com

L90(10k) > 60,000 hrs. @ 25°C per TM-21



To form a Catalog Number

S **1 7 2** - - - - -
1 2 3 4 5 6 7 8 9 10

1 Source

S = Solid State (LED)

2 Style

172 = Large outdoor, integral driver

3 Length / Light Output / Power

ORDER CODE	LENGTH	LUMENS	INPUT WATTS	NUMBER OF LEDS	DRIVE CURRENT
L112	12"	3160	27	112	150mA
M112	12"	6111	54	112	300mA
L224	17"	6320	54	224	150mA
M224	17"	12221	109	224	300mA
L336	24"	9480	81	336	150mA
M336	24"	18332	163	336	300mA

Based on 3500K, 80+CRI. [Click here](#) for scaled performance table.

4 Mounting

S = External yoke with 1/2" NPT nipple, wet location outlet box and cover finished to match luminaire

X = External yoke for use with required cantilever or slipfitter — ordered and priced separately, see hangers at right

5 Finish

02 = Semigloss white **15** = Metallic **99** = Custom or RAL, consult sales rep.*
06 = Dark bronze* **17** = Champagne*
07 = Silver* **18** = Copper*
08 = Semigloss black



* = non-cancellable/returnable

6 Voltage

M = 120-277V Universal voltage input
K = 347V input

Project: _____

Type: _____

7 Option (see Accessories Section for specifications)

00 = No options

V0 = Visor option

XX = For modification not listed, include detailed description. Consult factory prior to specification.

8 Destination Requirement

0 = UL listed or CSA certified for U.S.

J = UL listed or CSA certified for Canada

9 Color Temperature / CRI

827 = 2700K, 80+ CRI **927** = 2700K, 90+ CRI

830 = 3000K, 80+ CRI **930** = 3000K, 90+ CRI

835 = 3500K, 80+ CRI **935** = 3500K, 90+ CRI

840 = 4000K, 80+ CRI **940** = 4000K, 90+ CRI

740 = 4000K, 70+ CRI

Note: Additional CCT and CRI options are available; consult factory.

RGBW - Consult factory.

**10 Dimming****

00 = Non-dimming

TD = ERP forward phase or reverse phase (120V only), dimming range 100-10% power, compatible controls by others

ZX = 0-10V analog dimming 120-277V input, dimming range 100%-5%, 0-10V controls by others

EL = eldoLED SOLOdrive 120-277V input, dimming range 100%-0.1%, 0-10V controls by others.

**Dimming range refers to % power input, % light output will vary.

Refer to Driver Information document [MA-1303](#)

Note: Number of drivers varies with number of LEDs, drive current and driver type.

Required Mounting Hangers (X mount)

Required **ACL** or **ASF** mounting hangers for **X** mount cantilever or slipfitter fixtures are ordered and priced separately. See installation sheets on website.

AC _____ **36** _____ = **Cantilever, 36" (914mm) setback**
 (for use with **X** mount unit)
0 = U.S.
J = Canada
5 Finish
L = single unit (downward or upward facing only)

ASF _____ **T10** = **Top-mount slipfitter**,
 for 2-3/8" O.D. stanchion,
 pole or tenon (for use with
 single **X** mount unit)
5 Finish

ASF _____ **S10** = **Side-mount slipfitter**,
 for 2-3/8" O.D. pole,
 stanchion or tenon
 (for use with single
X mount unit)
5 Finish

Accessories

AE _____ **V** _____ **0D0** = External vertical blade **baffle**, black,
 for lengthwise shielding
2 = 25° shielding
4 = 45°
C = 12 inch fixtures
D = 17 inch fixtures
F = 24 inch fixtures

AV _____ **0D0** = Cutoff **visor**
5 Finish
C = 12 inch fixtures
D = 17 inch fixtures
F = 24 inch fixtures

The external shapes of the housings are trademarks of Sylvan R. Shemitz Designs, LLC
 dba **The Lighting Quotient**, makers of **elliptipar**, **tambient** and **fraqtir**.

elliptipar from **The Lighting Quotient**
 114 Boston Post Road, West Haven, Connecticut 06516, USA
 Voice 203.931.4455 • Fax 203.931.4464 • thelightingquotient.com

Certain products illustrated may be covered by applicable patents and patents pending.
 These specifications supersede all prior publications and are subject to change
 without notice. Copyright © 2021 Sylvan R. Shemitz Designs, LLC, all rights reserved.

