

BULLETTO

Compact Adjustable Floodlight Projector

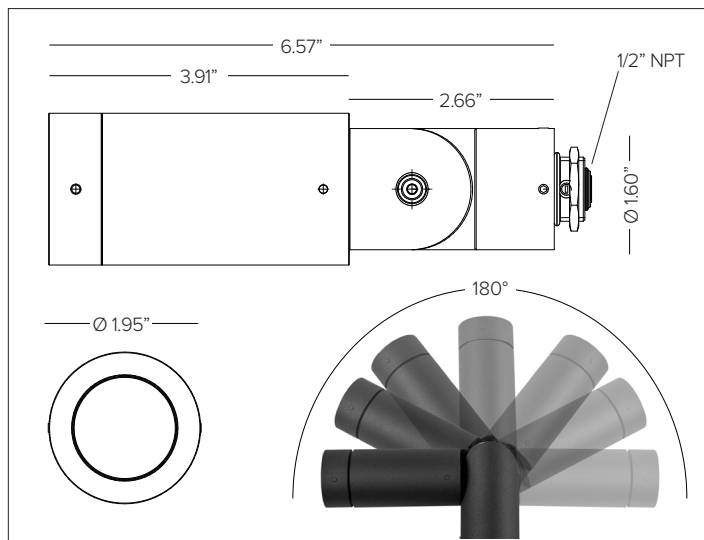

BULLETTO shown in Ferrite Dark Grey finish.



CONCEPT

Compact projector flood light for high intensity applications.

MECHANICAL CHARACTERISTICS

Housing	1.95" Dia. X 6.57" L
Materials	Aluminum body and joints for maximum heat dissipation.
Finish	Textured finish. ● Ferrite Dark Grey ● Heritage Brown ● Bronze ● Black ● White ● Sandstone Grey
Power Connection	Pre-cabled with 10' Belden direct burial 18ga 3 conductor cable for connection to remote power supply.
Functionality	Modular body for toolless maintenance. IP66 protection rated optical chamber with removable front cap for simple toolless field interchangeability of optics and accessories.
Mounting	Adjustable up to 180° on the vertical surface with aim lock set screw, 360° rotatable on the horizontal axis. Brass counter nut with 1/2" NPS mounting stem suitable for direct j-box mount. Optional installation accessories for additional mountings.
Weight	1.4lbs
Protection	IP66
Impact	IK08

CERTIFICATIONS

cULus Class 2 Wet Location Listed E479873.
 Tested in accordance with LM-79-08.
 Compliant for California installations.
 IEC 62471
 RoHS3 EU 215/863

WARRANTY

5 year limited warranty
^A Fixture suitable for use in marine grade environments. Not to be in direct contact with salt or corrosive agents for extended periods of time.

SUSTAINABILITY

Luminaire designed for disposal/recycling at end-of-life. Replaceable LED light source and control gear by a Targetti technician.

ELECTRICAL CHARACTERISTICS

Power Supply	Remote Class 2 120V-277V AC power supply required, ordered separately.
Wattage	8W (NSP) / 12W (SP/FL/MFL/WFL)
Voltage	24V DC

SOURCE

High efficiency LED Emitter

TM30	CCT (Nominal)	CRI	Rf	Rg	SDCM
	2700K	90	88	95	2
	3000K	90	91	98	2
	3500K	90	89	96	2
	4000K	90	88	94	2

OPTIC

Optical system is dependent on beam angle. NSP version PMMA lens and fixed holographic filter. SP / FL / MWFL / WFL versions equipped with PMMA lens and interchangeable optical holographic lens, factory preset per specified optic with other beams included in packaging.

Beam	NSP 8°	SP 15°	FL 24°	MWFL 3°	WFL 44°
Delivered Lumens	2700K 362Lm	679Lm	642Lm	648Lm	634Lm
	3000K 394Lm	738Lm	698Lm	704Lm	689Lm
	3500K 421Lm	790Lm	747Lm	753Lm	737Lm
	4000K 421Lm	790Lm	747Lm	753Lm	737Lm
Efficacy	66Lm/W max. Refer to photometric graphs for specific values.				
Lifetime	L96/B10 30,000hrs at max TA +25°C L95/B10 50,000hrs at max TA +25°C L94/B10 80,000hrs at max TA +25°C L93/B10 100,000hrs at max TA +25°C				

Photobiological Classification Low risk safety RG1

BULLETTO

SPECIFICATION INFORMATION



Ex: BLTRPFELINS30

1 - PRODUCT CODE	2 - DRIVER	3 - FINISH	4 - WATTAGE	5 - OPTIC	6 - KELVIN	7 - POWER SUPPLY
BLT — BULLETTO	RP — Remote Power	FE — Ferrite Dark Grey HB — Heritage Brown BZ — Bronze WT — White BT — Black SG — Sandstone Grey RAL — Custom RAL	L1 — 8W L2 — 12W	NS — NSP 8° SP — SP 15° FL — FL 24° MF — MWFL 31° WF — WF 44°	27 — 2700K 30 — 3000K 35 — 3500K 40 — 4000K	Power Supply See section for details
8 - OPTICAL ACCESSORIES		9 - INSTALLATION ACCESSORIES		10 - TREE MOUNTING INSTALLATION		
Blade of Light Linear Spread Lens See section for details Anti-glare Louver See section for details Asymmetric Screen See section for details Lumishape See section for details		Surface Mount Bracket See section for details Low Profile Surface Canopy See section for details Earth Spike See section for details Permapost See section for details		Tree Strap See section for details Fixture Bracket See section for details Wiring Connection Box See section for details Mesh Protective Wiring See section for details		

OPTIC DETAILS

Fixed Optic (NSP)



*Interchangeable Multi Optic (SP / FL / MWFL / WFL)
 Factory preset per specified optic with other beams
 included in packaging.*



BULLETTO

7 - POWER SUPPLY (REQUIRED)

ENCLOSURE								
<i>Part No.</i>	<i>Wattage</i>	<i>Control</i>	<i>Dim Range</i>	<i>Rating</i>	<i>In / Out Voltage</i>	<i>Certification</i>	<i>Dimensions (Enclosure)</i>	<i>Description</i>
DMLE301242UD	30W	MLV / ELV / 0-10V / TRIAC	MLV 10% / ELV 10% / 0-10V 5%	NEMA3R	120-277V / 24V	UL Class 2	4.47" X 6.79" X 1.38"	EMCOD MLE-UD electronic driver with wiring compartment.
DMLE601242UD	60W	MLV / ELV / 0-10V / TRIAC	MLV 10% / ELV 10% / 0-10V 5%	NEMA3R	120-277V / 24V	UL Class 2	4.47" X 6.79" X 1.38"	EMCOD MLE-UD electronic driver with wiring compartment.
DMLE961242UD	96W	MLV / ELV / 0-10V / TRIAC	MLV 10% / ELV 10% / 0-10V 5%	NEMA3R	120-277V / 24V	UL Class 2	5.16" X 7.73" X 1.54"	EMCOD MLE-UD electronic driver with wiring compartment.
DMLE1922242UD	2X96W	MLV / ELV / 0-10V / TRIAC	MLV 10% / ELV 10% / 0-10V 5%	NEMA3R	120-277V / 24V	UL Class 2	5.04" X 10.94" X 1.81"	EMCOD MLE-UD electronic driver with wiring compartment.
DMLE2882242UD	3X96W	MLV / ELV / 0-10V / TRIAC	MLV 10% / ELV 10% / 0-10V 5%	NEMA3R	120-277V / 24V	UL Class 2	5.04" X 10.94" X 1.81"	EMCOD MLE-UD electronic driver with wiring compartment.

MAX FIXTURES PER DRIVER

<i>Fixture Wattage</i>	<i>Driver Wattage</i>				
	<i>30W</i>	<i>60W</i>	<i>96W</i>	<i>2X96W</i>	<i>3X96W</i>
8W	3	6	9	9+9	9+9+9
12W	2	4	7	7+7	7+7+7

BULLETO

8 – OPTICAL ACCESSORIES (OPTIONAL)

MAXIMUM OF TWO ACCESSORIES PER FIXTURE.



Integral 'Blade of Light' linear spread lens PMMA holographic filter.

Part No. **1E3790**

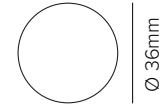

Integral honeycomb anti-glare louver.

Finish ● Deep Black

Part No. **1E3792**

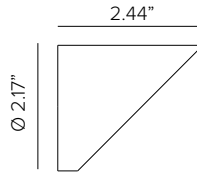
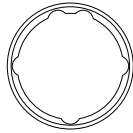
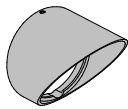

External asymmetric snoot. Powder coated stainless steel. Cutoff 20°.

Part No. **1E3788 (*)**

- Ferrite Dark Grey (Default)
- Heritage Brown (HB)*
- Bronze (BZ)*
- White (WT)*
- Black (BT)*
- Sandstone Grey (SG)*

***Add suffix to end of number to identify finish (EX. 1E3788HB)**



Water jet cut stainless steel round pinhole LUMISHAPE light shield. **Performs best with SP optic.**

Finish ● Deep Black

Part No. **LS03601**

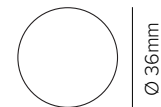

Water jet cut stainless steel round circular LUMISHAPE light shield. **Performs best with SP or FL optic.**

Finish ● Deep Black

Part No. **LS03602**



Water jet cut stainless steel square pinhole LUMISHAPE light shield. **Performs best with SP optic.**

Finish ● Deep Black

Part No. **LS03603**

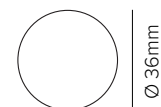
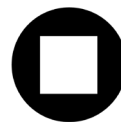

Water jet cut stainless steel regular square LUMISHAPE light shield. **Performs best with SP or FL optic.**

Finish ● Deep Black

Part No. **LS03604**

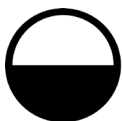

Water jet cut stainless steel half LUMISHAPE light shield. **Stackable up to 4pcs per fixture; 4pcs accounts to 1 accessory toward maximum accessory count. Performs best with FL or MFL optic.**

Finish ● Deep Black

Part No. **LS03605**

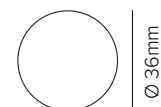
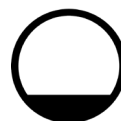

Water jet cut stainless steel quarter LUMISHAPE light shield. **Stackable up to 4pcs per fixture; 4pcs accounts to 1 accessory toward maximum accessory count. Performs best with FL or MFL optic.**

Finish ● Deep Black

Part No. **LS03606**

BULLETO

9 – INSTALLATION ACCESSORIES (OPTIONAL)

MAXIMUM OF ONE ACCESSORY PER FIXTURE

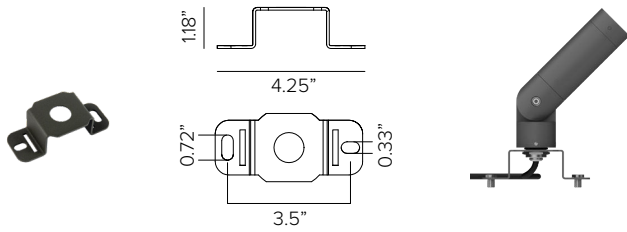

Surface mounting bracket. Powder coated stainless steel.

Part No. **1E3786 (*)**

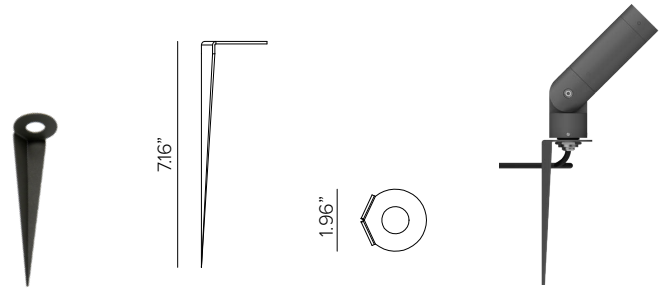

Earth spike. Powder coated stainless steel.

Part No. **1E3785 (*)**

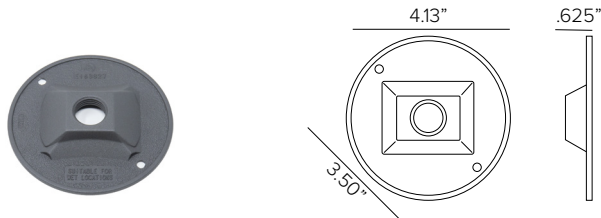

Low Profile surface canopy. Powder coated aluminum with 1/2" NPT to mount over standard 4" Dia. round outdoor j-box.

Part No. **1BLTSMCVR (*)**

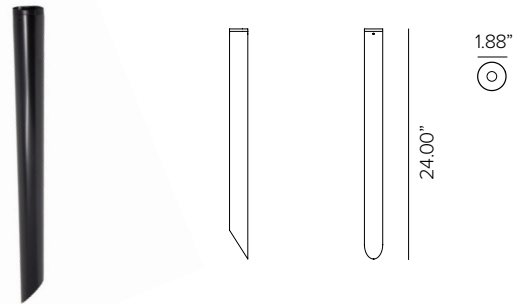

BULLETO aluminum permastap with 1/2" NPT and 1ea stabilizer.

Finish ● Deep Black

Part No. **PRMP24BK**

- Ferrite Dark Grey (Default)
- Heritage Brown (HB)*
- Bronze (BZ)*
- White (WT)*
- Black (BT)*
- Sandstone Grey (SG)*

***Add suffix to end of number to identify finish (EX. 1E3786HB)**

BULLETTTO

10 – TREE MOUNTING INSTALLATION (OPTIONAL)

SINGLE STRAP FOR USE WITH OF UP TO 3 FIXTURES

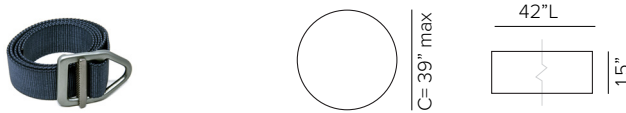

Single tree strap comprised of durable Nylon webbing flexible strap with high strength aircraft aluminum V-ring buckle in Gunmetal finish and lock-in loop to prevent slipping. **Strap is made to coordinate with up to 3 fixtures and 1 wiring connection box. Strap fits trees 39" max circumference or smaller. (REQUIRED)**

Finish ● Olive Green ● Coyote Brown ● Graphite Grey

Part No. **TTS0101** **TTS0102** **TTS0103**

DOUBLE STRAP FOR USE WITH OF UP TO 8 FIXTURES

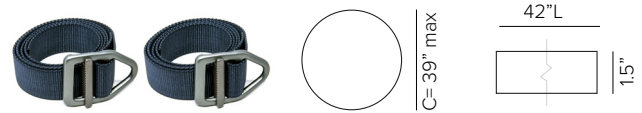

Durable 1.5 inch wide Nylon webbing Strap is flexible with High Strength Aircraft Aluminum V-ring Buckle in Gunmetal finish and lock in loop to prevent slipping. **Strap is made to coordinate with up to 8 fixtures and 2 wiring connection boxes. Strap fits trees 39" max circumference or smaller. (REQUIRED)**

Finish ● Ferrite Dark Grey ● Bronze ● Graphite Grey

Part No. **TTS0106** **TTS0104** **TTS0105**



Fixture bracket comprised of powder coated stainless steel for use with tree strap. **Maximum of 3 brackets can be per single strap. (REQUIRED)**

Finish ● Ferrite Dark Grey ● Bronze

Part No. **TTBLT0101** **TTBLT0102**



Fixture bracket comprised of powder coated stainless steel for use with tree strap. **Maximum of 3 brackets can be per double strap. (REQUIRED)**

Finish ● Ferrite Dark Grey ● Bronze

Part No. **TTBLT0201** **TTBLT0202**



Tree Strap Connection Box. Painted aluminum UL listed 9in³ j-box with 3ea 3/8" cable glands and 1ea 1/2" cable gland. Mounting bracket for tree strap included. Used to connect multiple 24V DC low voltage cables for one continuous cable connection down the tree to remote driver, additional cable provided by others. **Can be used for up to 3 fixture connections per tree strap. (OPTIONAL)**

Finish ● Ferrite Dark Grey ● Bronze

Part No. **TTCB0103FG** **TTB0103BZ**

Tree Strap Connection Box. Painted aluminum UL listed 13in³ j-box with 3ea 3/8" cable glands and 1ea 1/2" cable gland. Mounting bracket for tree strap included. Used to connect multiple 24V DC low voltage cables for one continuous cable connection down the tree to remote driver, additional cable provided by others. **Can be used for up to 5 fixture connections per tree strap. (OPTIONAL)**

Finish ● Ferrite Dark Grey ● Bronze

Part No. **TTCB0104FG** **TTB0104BZ**

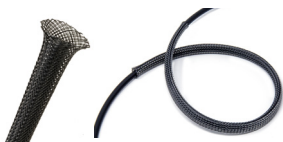

Mesh wire protection cover sleeve comprised of braided polyethylene terephthalate (PET) monofilament webbing resistant to chemical degradation, UV radiation and abrasion. 3/8" SJO Cord Sleeve, available per foot. **(OPTIONAL)**

Finish ● Carbon Grey ● Brown ● Forest Green

Part No. **TTSJS01** **TTSJS02** **TTSJS03**



Mesh wire protection cover sleeve comprised of braided polyethylene terephthalate (PET) monofilament webbing resistant to chemical degradation, UV radiation and abrasion. 3/8" SJO Cord Sleeve, available per foot. **(OPTIONAL)**

Finish ● Carbon Grey ● Brown ● Forest Green

Part No. **TTSJS01** **TTSJS02** **TTSJS03**

WIRING CONFIGURATION

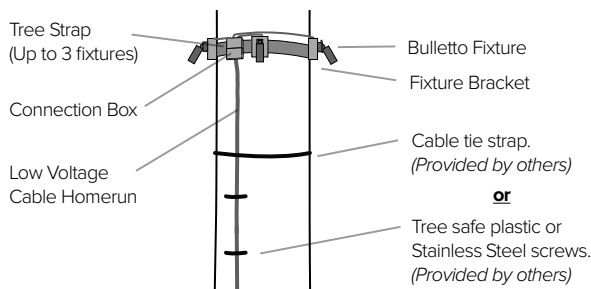

To be installed per local building code. Adjust the strap every 6 months in order to prevent tree damage.

WIRING CONFIGURATION

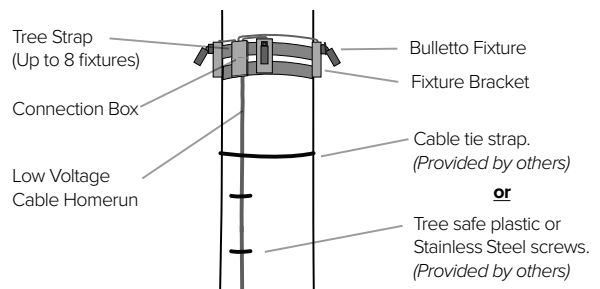

To be installed per local building code. Adjust the strap every 6 months in order to prevent tree damage.

BULLETTO

PHOTOMETRY

IES FILES WATTAGE AND EFFICIENCY CALCULATIONS BASED WITH SUPPLIED DRIVER

NARROW SPOT



2700K		H(m)	D(m)	Emax(lx)	
Ra90			8°		
Fixture Power	8W	1	0.15	11580	
Source Flux	479lm	2	0.30	2895	
Fixture Flux	362lm	3	0.44	1287	
Efficacy	47lm/W	4	0.59	724	
TS1404	I _{max} =24196cd/klm	I _{max}	11580cd	5	0.74 463



3000K		H(m)	D(m)	Emax(lx)	
Ra90			8°		
Fixture Power	8W	1	0.15	12587	
Source Flux	520lm	2	0.30	3147	
Fixture Flux	394lm	3	0.44	1399	
Efficacy	51lm/W	4	0.59	787	
TS1404	I _{max} =24196cd/klm	I _{max}	12587cd	5	0.74 503



3500K		H(m)	D(m)	Emax(lx)	
Ra90			8°		
Fixture Power	8W	1	0.15	13470	
Source Flux	557lm	2	0.30	3367	
Fixture Flux	421lm	3	0.44	1497	
Efficacy	54lm/W	4	0.59	842	
TS1404	I _{max} =24196cd/klm	I _{max}	13470cd	5	0.74 539



4000K		H(m)	D(m)	Emax(lx)	
Ra90			8°		
Fixture Power	8W	1	0.15	13470	
Source Flux	557lm	2	0.30	3367	
Fixture Flux	421lm	3	0.44	1497	
Efficacy	54lm/W	4	0.59	842	
TS1404	I _{max} =24196cd/klm	I _{max}	13470cd	5	0.74 539

SPOT



2700K		H(m)	D(m)	Emax(lx)	
Ra90			15°		
Fixture Power	12W	1	0.27	6624	
Source Flux	908lm	2	0.54	1656	
Fixture Flux	679lm	3	0.81	736	
Efficacy	57lm/W	4	1.08	414	
TS1405	I _{max} =7292cd/klm	I _{max}	6624cd	5	1.35 265



3000K		H(m)	D(m)	Emax(lx)	
Ra90			15°		
Fixture Power	12W	1	0.27	7200	
Source Flux	987lm	2	0.54	1800	
Fixture Flux	738lm	3	0.81	800	
Efficacy	62lm/W	4	1.08	450	
TS1405	I _{max} =7292cd/klm	I _{max}	7200cd	5	1.35 288



3500K		H(m)	D(m)	Emax(lx)	
Ra90			15°		
Fixture Power	12W	1	0.27	7701	
Source Flux	1056lm	2	0.54	1925	
Fixture Flux	790lm	3	0.81	856	
Efficacy	66lm/W	4	1.08	481	
TS1405	I _{max} =7292cd/klm	I _{max}	7701cd	5	1.35 308



4000K		H(m)	D(m)	Emax(lx)	
Ra90			15°		
Fixture Power	12W	1	0.27	7701	
Source Flux	1056lm	2	0.54	1925	
Fixture Flux	790lm	3	0.81	856	
Efficacy	66lm/W	4	1.08	481	
TS1405	I _{max} =7292cd/klm	I _{max}	7701cd	5	1.35 308

FLOOD



2700K		H(m)	D(m)	Emax(lx)	
Ra90			24°		
Fixture Power	12W	1	0.43	2618	
Source Flux	908lm	2	0.85	655	
Fixture Flux	642lm	3	1.28	291	
Efficacy	54lm/W	4	1.71	164	
TS1406	I _{max} =2883cd/klm	I _{max}	2618cd	5	2.14 105



3000K		H(m)	D(m)	Emax(lx)	
Ra90			24°		
Fixture Power	12W	1	0.43	2846	
Source Flux	987lm	2	0.85	712	
Fixture Flux	698lm	3	1.28	316	
Efficacy	58lm/W	4	1.71	178	
TS1406	I _{max} =2883cd/klm	I _{max}	2846cd	5	2.14 114



3500K		H(m)	D(m)	Emax(lx)	
Ra90			24°		
Fixture Power	12W	1	0.43	3044	
Source Flux	1056lm	2	0.85	761	
Fixture Flux	747lm	3	1.28	338	
Efficacy	62lm/W	4	1.71	190	
TS1406	I _{max} =2883cd/klm	I _{max}	3044cd	5	2.14 122



4000K		H(m)	D(m)	Emax(lx)	
Ra90			24°		
Fixture Power	12W	1	0.43	3044	
Source Flux	1056lm	2	0.85	761	
Fixture Flux	747lm	3	1.28	338	
Efficacy	62lm/W	4	1.71	190	
TS1406	I _{max} =2883cd/klm	I _{max}	3044cd	5	2.14 122

BULLETTO

PHOTOMETRY

IES FILES WATTAGE AND EFFICIENCY CALCULATIONS BASED WITH SUPPLIED DRIVER

MEDIUM WIDE FLOOD

2700K		H(m)	D(m)	Emax(lx)		
Ra90			31°			
Fixture Power	12W	1	0.55	1741		
Source Flux	908lm	2	1.09	435		
Fixture Flux	648lm	3	1.64	193		
Efficacy	54lm/W	4	2.18	109		
TS1407	I _{max} =1916cd/klm	I _{max}	1741cd	5	2.73	70

3000K		H(m)	D(m)	Emax(lx)		
Ra90			31°			
Fixture Power	12W	1	0.55	1892		
Source Flux	987lm	2	1.09	473		
Fixture Flux	704lm	3	1.64	210		
Efficacy	59lm/W	4	2.18	118		
TS1407	I _{max} =1916cd/klm	I _{max}	1892cd	5	2.73	76

3500K		H(m)	D(m)	Emax(lx)		
Ra90			31°			
Fixture Power	12W	1	0.55	2024		
Source Flux	1056lm	2	1.09	506		
Fixture Flux	753lm	3	1.64	225		
Efficacy	63lm/W	4	2.18	126		
TS1407	I _{max} =1916cd/klm	I _{max}	2024cd	5	2.73	81

4000K		H(m)	D(m)	Emax(lx)		
Ra90			31°			
Fixture Power	12W	1	0.55	2024		
Source Flux	1056lm	2	1.09	506		
Fixture Flux	753lm	3	1.64	225		
Efficacy	63lm/W	4	2.18	126		
TS1407	I _{max} =1916cd/klm	I _{max}	2024cd	5	2.73	81

WIDE FLOOD

2700K		H(m)	D(m)	Emax(lx)		
Ra90			44°			
Fixture Power	12W	1	0.82	916		
Source Flux	908lm	2	1.63	229		
Fixture Flux	634lm	3	2.45	102		
Efficacy	53lm/W	4	3.27	57		
TS1408	I _{max} =1009cd/klm	I _{max}	916cd	5	4.08	37

3000K		H(m)	D(m)	Emax(lx)		
Ra90			44°			
Fixture Power	12W	1	0.82	996		
Source Flux	987lm	2	1.63	249		
Fixture Flux	689lm	3	2.45	111		
Efficacy	57lm/W	4	3.27	62		
TS1408	I _{max} =1009cd/klm	I _{max}	996cd	5	4.08	40

3500K		H(m)	D(m)	Emax(lx)		
Ra90			44°			
Fixture Power	12W	1	0.82	1065		
Source Flux	1056lm	2	1.63	266		
Fixture Flux	737lm	3	2.45	118		
Efficacy	61lm/W	4	3.27	67		
TS1408	I _{max} =1009cd/klm	I _{max}	1065cd	5	4.08	43

4000K		H(m)	D(m)	Emax(lx)		
Ra90			44°			
Fixture Power	12W	1	0.82	1065		
Source Flux	1056lm	2	1.63	266		
Fixture Flux	737lm	3	2.45	118		
Efficacy	61lm/W	4	3.27	67		
TS1408	I _{max} =1009cd/klm	I _{max}	1065cd	5	4.08	43