

# BULLETTO MINI

## Compact Adjustable Floodlight Projector

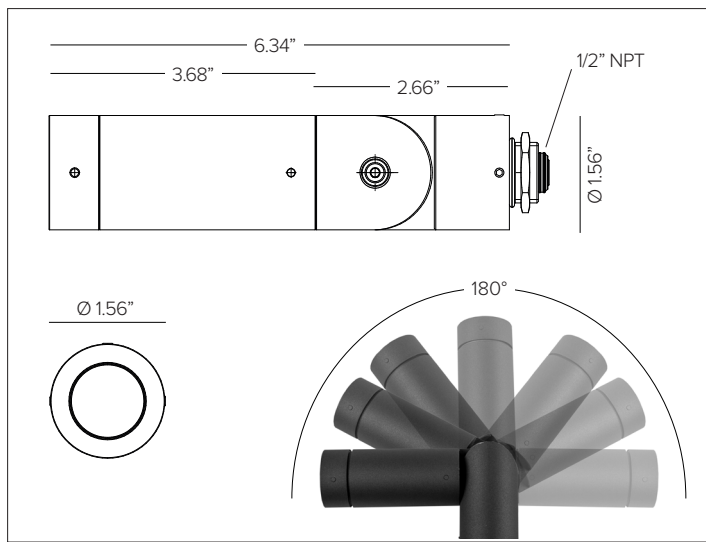

BULLETTO MINI shown in Ferrite Dark Grey finish.



### CONCEPT

Compact projector flood light for high intensity applications.

### MECHANICAL CHARACTERISTICS

<b>Housing</b>	1.56" Dia. X 6.34" L
<b>Materials</b>	Aluminum body and joints for maximum heat dissipation.
<b>Finish</b>	Textured finish. ● Ferrite Dark Grey   ● Heritage Brown   ● Bronze ● Black   ● White   ● Sandstone Grey
<b>Power Connection</b>	Pre-cabled with 10' Belden direct burial 18ga 3 conductor cable for connection to remote power supply.
<b>Functionality</b>	Modular body for toolless maintenance. IP66 protection rated optical chamber with removable front cap for simple toolless field interchangeability of optics and accessories.
<b>Mounting</b>	Adjustable up to 180° on the vertical surface with aim lock set screw, 360° rotatable on the horizontal axis. Brass counter nut with 1/2" NPS mounting stem suitable for direct j-box mount. Optional installation accessories for additional mountings.
<b>Weight</b>	1.0lbs
<b>Protection</b>	IP66
<b>Impact</b>	IK08

### CERTIFICATIONS

cULus Class 2 Wet Location Listed E479873.  
 Tested in accordance with LM-79-08.  
 Compliant for California installations.  
 IEC 62471  
 RoHS3 EU 215/863

### WARRANTY

5 year limited warranty  
 ^ Fixture suitable for use in marine grade environments. Not to be in direct contact with salt or corrosive agents for extended periods of time.

### SUSTAINABILITY

Luminaire designed for disposal/recycling at end-of-life. Replaceable LED light source and control gear by a Targetti technician.

### ELECTRICAL CHARACTERISTICS

<b>Power Supply</b>	Remote Class 2 120V-277V AC power supply required, ordered separately.
<b>Wattage</b>	8W
<b>Voltage</b>	24V DC

### SOURCE

High efficiency LED Emitter

TM30	CCT (Nominal)	CRI	Rf	Rg	SDCM
	2700K	90	94	99	2
	3000K	90	94	99	2
	3500K	90	94	99	2
	4000K	90	93	101	2

### OPTIC

Equipped with PMMA lens and interchangeable optical holographic lens, factory preset per specified optic with other beams included in packaging.

Beam	SP 11°	FL 20°	MWFL 37°
<b>Delivered Lumens</b>	<b>2700K</b> 350Lm	306Lm	276Lm
	<b>3000K</b> 380Lm	332Lm	300Lm
	<b>3500K</b> 407Lm	356Lm	321Lm
	<b>4000K</b> 407Lm	356Lm	321Lm
<b>Efficacy</b>	61Lm/W max. Refer to photometric graphs for specific values.		
<b>Lifetime</b>	L96/B10 30,000hrs at max TA +25°C L95/B10 50,000hrs at max TA +25°C L94/B10 80,000hrs at max TA +25°C L93/B10 100,000hrs at max TA +25°C		
<b>Photobiological Classification</b>	Low risk safety RG1		

# BULLETTO MINI

## SPECIFICATION INFORMATION



1 - PRODUCT CODE	2 - DRIVER	3 - FINISH	4 - WATTAGE	5 - OPTIC	6 - KELVIN	7 - POWER SUPPLY
<b>BLM</b> — BULLETTO MINI	<b>RP</b> — Remote Power	<b>FE</b> — Ferrite Dark Grey <b>HB</b> — Heritage Brown <b>BZ</b> — Bronze <b>WT</b> — White <b>BT</b> — Black <b>SG</b> — Sandstone Grey <b>RAL</b> — <a href="#">Custom RAL</a>	<b>L1</b> — 8W	<b>SP</b> — SP 11° <b>FL</b> — FL 20° <b>MF</b> — MWFL 37°	<b>27</b> — 2700K <b>30</b> — 3000K <b>35</b> — 3500K <b>40</b> — 4000K	<a href="#">Power Supply</a> See section for details
8 - OPTICAL ACCESSORIES		9 - INSTALLATION ACCESSORIES		10 - TREE MOUNTING INSTALLATION ACCESSORIES		
<a href="#">Blade of Light Linear Spread Lens</a> See section for details <a href="#">Anti-glare Louver</a> See section for details <a href="#">Asymmetric Screen</a> See section for details <a href="#">Lumishape</a> See section for details		<a href="#">Surface Mount Bracket</a> See section for details <a href="#">Earth Spike</a> See section for details <a href="#">Low Profile Surface Canopy</a> See section for details <a href="#">Permapost</a> See section for details		<a href="#">Tree Strap</a> See section for details <a href="#">Fixture Bracket</a> See section for details <a href="#">Wiring Connection Box</a> See section for details <a href="#">Mesh Protective Wiring</a> See section for details		

For applicable quick ship items, see model configurations listed below. Lead time for quick ship fixtures is 1-2 weeks from processed PO date. Consult factory for quantities of over 20pcs to confirm lead time.

-  **QSBLMRPBZL1(SP / FL / MF)30 + DMLE301242UD / DMLE601242UD / DMLE961242UD**
- QSBLMRPFEL1(SP / FL / MF)30 + DMLE301242UD / DMLE601242UD / DMLE961242UD**

## OPTIC DETAILS

**Interchangeable Multi Optic (SP / FL / MWFL)**  
 Factory preset per specified optic with other beams included in packaging.



# BULLETTO MINI

## 7 - POWER SUPPLY (REQUIRED)

### ENCLOSURE

Part No.	Wattage	Control	Dim Range	Rating	In / Out Voltage	Certification	Dimensions (Enclosure)	Description
<b>DMLE301242UD</b>	30W	MLV / ELV / 0-10V / TRIAC	MLV 10% / ELV 10% / 0-10V 5%	NEMA3R	120-277V / 24V	UL Class 2	4.47" X 6.79" X 1.38"	EMCOD MLE-UD electronic driver with wiring compartment.
<b>DMLE601242UD</b>	60W	MLV / ELV / 0-10V / TRIAC	MLV 10% / ELV 10% / 0-10V 5%	NEMA3R	120-277V / 24V	UL Class 2	4.47" X 6.79" X 1.38"	EMCOD MLE-UD electronic driver with wiring compartment.
<b>DMLE961242UD</b>	96W	MLV / ELV / 0-10V / TRIAC	MLV 10% / ELV 10% / 0-10V 5%	NEMA3R	120-277V / 24V	UL Class 2	5.16" X 7.73" X 1.54"	EMCOD MLE-UD electronic driver with wiring compartment.
<b>DMLE1922242UD</b>	2X96W	MLV / ELV / 0-10V / TRIAC	MLV 10% / ELV 10% / 0-10V 5%	NEMA3R	120-277V / 24V	UL Class 2	5.04" X 10.94" X 1.81"	EMCOD MLE-UD electronic driver with wiring compartment.
<b>DMLE2882242UD</b>	3X96W	MLV / ELV / 0-10V / TRIAC	MLV 10% / ELV 10% / 0-10V 5%	NEMA3R	120-277V / 24V	UL Class 2	5.04" X 10.94" X 1.81"	EMCOD MLE-UD electronic driver with wiring compartment.

### MAX FIXTURES PER DRIVER

Fixture Wattage	Driver Wattage				
	30W	60W	96W	2X96W	3X96W
8W	3	6	9	9+9	9+9+9

# BULLETO MINI

## 8 – OPTICAL ACCESSORIES (OPTIONAL)

MAXIMUM OF TWO ACCESSORIES PER FIXTURE.



Integral 'Blade of Light' linear spread lens PMMA holographic filter.

Part No. **1E3789**

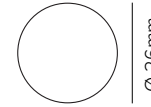

Integral honeycomb anti-glare louver.

Finish ● Deep Black

Part No. **1E3791**

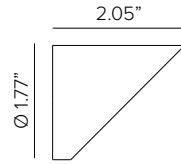
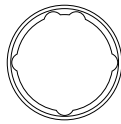
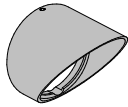

External asymmetric snoot. Powder coated stainless steel. Cutoff 19.4°

Part No. **1E3787 (\*)**

- Ferrite Dark Grey (Default)
- Heritage Brown (HB)\*
- Bronze (BZ)\*
- White (WT)\*
- Black (BT)\*
- Sandstone Grey (SG)\*

**\*Add suffix to end of number to identify finish (EX. 1E3787HB)**



Water jet cut stainless steel round pinhole LUMISHAPE light shield. **Performs best with SP optic.**

Finish ● Deep Black

Part No. **LS02601**

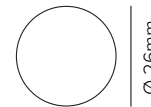

Water jet cut stainless steel round circular LUMISHAPE light shield. **Performs best with SP or FL optic.**

Finish ● Deep Black

Part No. **LS02602**



Water jet cut stainless steel square pinhole LUMISHAPE light shield. **Performs best with SP optic.**

Finish ● Deep Black

Part No. **LS02603**

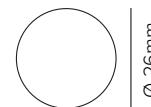
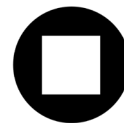

Water jet cut stainless steel regular square LUMISHAPE light shield. **Performs best with SP or FL optic.**

Finish ● Deep Black

Part No. **LS02604**



Water jet cut stainless steel half LUMISHAPE light shield. **Stackable up to 4pcs per fixture; 4pcs accounts to 1 accessory toward maximum accessory count. Performs best with FL or MFL optic**

Finish ● Deep Black

Part No. **LS02605**

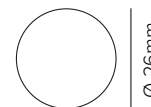
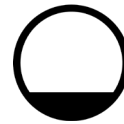

Water jet cut stainless steel quarter LUMISHAPE light shield. **Stackable up to 4pcs per fixture; 4pcs accounts to 1 accessory toward maximum accessory count. Performs best with FL or MFL optic**

Finish ● Deep Black

Part No. **LS02606**

**BULLETO MINI**

**9 – INSTALLATION ACCESSORIES (OPTIONAL)**

MAXIMUM OF ONE ACCESSORY PER FIXTURE

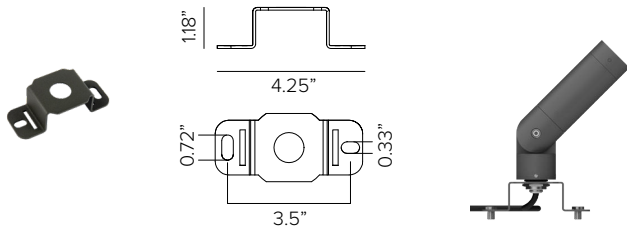

Surface mounting bracket. Powder coated stainless steel.

Part No. **1E3786 (\*)**

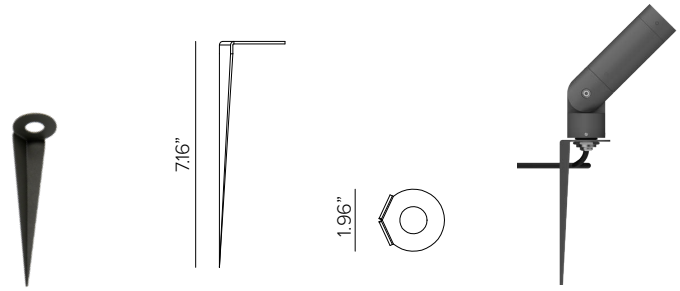

Earth spike. Powder coated stainless steel.

Part No. **1E3785 (\*)**

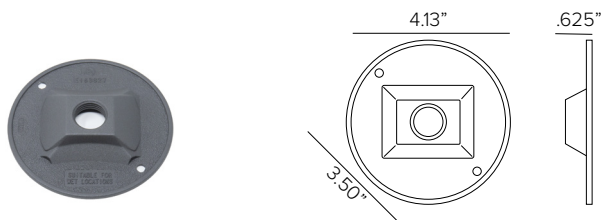

Low Profile surface canopy. Powder coated aluminum with 1/2" NPT to mount over standard 4" Dia. round outdoor j-box.

Part No. **1BLTSMCVR (\*)**

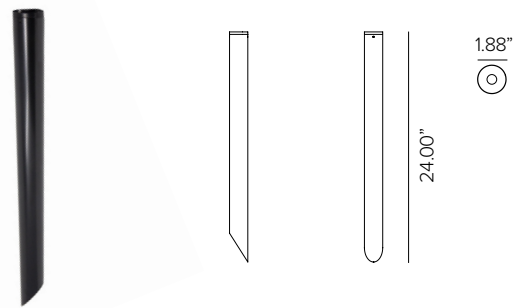

BULLETO aluminum permastab with 1/2" NPT and tea stabilizer.

Finish ● Deep Black

Part No. **PRMP24BK**

- Ferrite Dark Grey (Default)
- Heritage Brown (HB)\*
- Bronze (BZ)\*
- White (WT)\*
- Black (BT)\*
- Sandstone Grey (SG)\*

**\*Add suffix to end of number to identify finish (EX. 1E3786HB)**

# BULLETTO MINI

## 10 – TREE MOUNTING INSTALLATION (OPTIONAL)

### SINGLE STRAP FOR USE WITH OF UP TO 3 FIXTURES

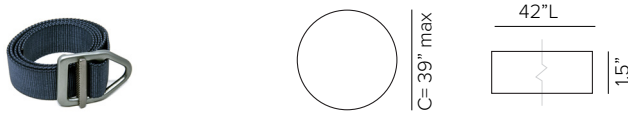

Single tree strap comprised of durable Nylon webbing flexible strap with high strength aircraft aluminum V-ring buckle in Gunmetal finish and lock-in loop to prevent slipping. **Strap is made to coordinate with up to 3 fixtures and 1 wiring connection box. Strap fits trees 39" max circumference or smaller. (REQUIRED)**

Finish ● Olive Green ● Coyote Brown ● Graphite Grey

Part No. **TTS0101**      **TTS0102**      **TTS0103**



Fixture bracket comprised of powder coated stainless steel for use with tree strap. **Maximum of 3 brackets can be per single strap. (REQUIRED)**

Finish ● Ferrite Dark Grey ● Bronze

Part No. **TTBLT0101**      **TTBLT0102**



Tree Strap Connection Box. Painted aluminum UL listed 9in<sup>3</sup> j-box with 3ea 3/8" cable glands and 1ea 1/2" cable gland. Mounting bracket for tree strap included. Used to connect multiple 24V DC low voltage cables for one continuous cable connection down the tree to remote driver, additional cable provided by others. **Can be used for up to 3 fixture connections per tree strap. (OPTIONAL)**

Finish ● Ferrite Dark Grey ● Bronze

Part No. **TTCB0103FG**      **TTB0103BZ**



Mesh wire protection cover sleeve comprised of braided polyethylene terephthalate (PET) monofilament webbing resistant to chemical degradation, UV radiation and abrasion. 3/8" SJO Cord Sleeve, available per foot. **(OPTIONAL)**

Finish ● Carbon Grey ● Brown ● Forest Green

Part No. **TTSJS01**      **TTSJS02**      **TTSJS03**

### WIRING CONFIGURATION

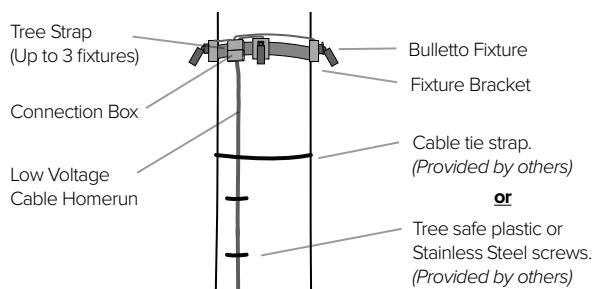

To be installed per local building code. Adjust the strap every 6 months in order to prevent tree damage.

### DOUBLE STRAP FOR USE WITH OF UP TO 8 FIXTURES

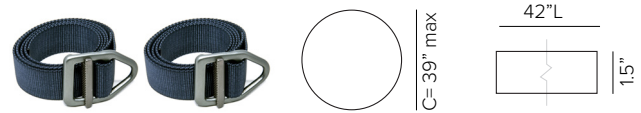

Durable 1.5 inch wide Nylon webbing Strap is flexible with High Strength Aircraft Aluminum V-ring Buckle in Gunmetal finish and lock in loop to prevent slipping. **Strap is made to coordinate with up to 8 fixtures and 2 wiring connection boxes. Strap fits trees 39" max circumference or smaller. (REQUIRED)**

Finish ● Ferrite Dark Grey ● Bronze ● Graphite Grey

Part No. **TTS0106**      **TTS0104**      **TTS0105**



Fixture bracket comprised of powder coated stainless steel for use with tree strap. **Maximum of 3 brackets can be per double strap. (REQUIRED)**

Finish ● Ferrite Dark Grey ● Bronze

Part No. **TTBLT0201**      **TTBLT0202**

Tree Strap Connection Box. Painted aluminum UL listed 13in<sup>3</sup> j-box with 3ea 3/8" cable glands and 1ea 1/2" cable gland. Mounting bracket for tree strap included. Used to connect multiple 24V DC low voltage cables for one continuous cable connection down the tree to remote driver, additional cable provided by others. **Can be used for up to 5 fixture connections per tree strap. (OPTIONAL)**

Finish ● Ferrite Dark Grey ● Bronze

Part No. **TTCB0104FG**      **TTB0104BZ**



Mesh wire protection cover sleeve comprised of braided polyethylene terephthalate (PET) monofilament webbing resistant to chemical degradation, UV radiation and abrasion. 3/8" SJO Cord Sleeve, available per foot. **(OPTIONAL)**

Finish ● Carbon Grey ● Brown ● Forest Green

Part No. **TTSJS01**      **TTSJS02**      **TTSJS03**

### WIRING CONFIGURATION

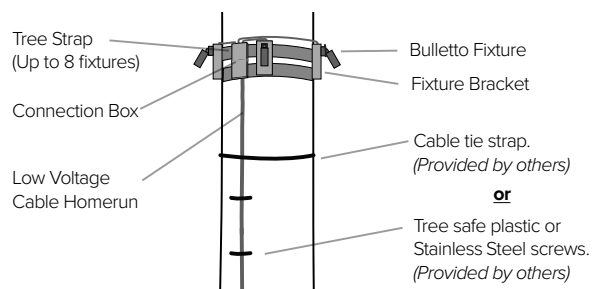

To be installed per local building code. Adjust the strap every 6 months in order to prevent tree damage.

# BULLETTINO MINI

## PHOTOMETRY

IES FILES WATTAGE AND EFFICIENCY CALCULATIONS BASED WITH SUPPLIED DRIVER

### SPOT



2700K		H(m)	D(m)	Emax(lx)		
Ra90			11°			
Fixture Power	8W	1	0.19	6942		
Source Flux	479lm	2	0.38	1736		
Fixture Flux	350lm	3	0.57	771		
Efficacy	45lm/W	4	0.75	434		
TS1401	Imax=14505cd/klm	Imax	6942cd	5	0.94	278



3000K		H(m)	D(m)	Emax(lx)		
Ra90			11°			
Fixture Power	8W	1	0.19	7545		
Source Flux	520lm	2	0.38	1886		
Fixture Flux	380lm	3	0.57	838		
Efficacy	49lm/W	4	0.75	472		
TS1401	Imax=14505cd/klm	Imax	7545cd	5	0.94	302



3500K		H(m)	D(m)	Emax(lx)		
Ra90			11°			
Fixture Power	8W	1	0.19	8075		
Source Flux	557lm	2	0.38	2019		
Fixture Flux	407lm	3	0.57	897		
Efficacy	52lm/W	4	0.75	505		
TS1401	Imax=14505cd/klm	Imax	8075cd	5	0.94	323



4000K		H(m)	D(m)	Emax(lx)		
Ra90			11°			
Fixture Power	8W	1	0.19	8075		
Source Flux	557lm	2	0.38	2019		
Fixture Flux	407lm	3	0.57	897		
Efficacy	52lm/W	4	0.75	505		
TS1401	Imax=14505cd/klm	Imax	8075cd	5	0.94	323

### FLOOD



2700K		H(m)	D(m)	Emax(lx)		
Ra90			20°			
Fixture Power	8W	1	0.36	1720		
Source Flux	479lm	2	0.72	430		
Fixture Flux	306lm	3	1.08	191		
Efficacy	39lm/W	4	1.44	107		
TS1402	Imax=3593cd/klm	Imax	1720cd	5	1.80	69



3000K		H(m)	D(m)	Emax(lx)		
Ra90			20°			
Fixture Power	8W	1	0.36	1869		
Source Flux	520lm	2	0.72	467		
Fixture Flux	332lm	3	1.08	208		
Efficacy	43lm/W	4	1.44	117		
TS1402	Imax=3593cd/klm	Imax	1869cd	5	1.80	75



3500K		H(m)	D(m)	Emax(lx)		
Ra90			20°			
Fixture Power	8W	1	0.36	2000		
Source Flux	557lm	2	0.72	500		
Fixture Flux	356lm	3	1.08	222		
Efficacy	46lm/W	4	1.44	125		
TS1402	Imax=3593cd/klm	Imax	2000cd	5	1.80	80



4000K		H(m)	D(m)	Emax(lx)		
Ra90			20°			
Fixture Power	8W	1	0.36	2000		
Source Flux	557lm	2	0.72	500		
Fixture Flux	356lm	3	1.08	222		
Efficacy	46lm/W	4	1.44	125		
TS1402	Imax=3593cd/klm	Imax	2000cd	5	1.80	80

### MEDIUM WIDE FLOOD



2700K		H(m)	D(m)	Emax(lx)		
Ra90			37°			
Fixture Power	8W	1	0.68	565		
Source Flux	479lm	2	1.36	141		
Fixture Flux	276lm	3	2.04	63		
Efficacy	35lm/W	4	2.71	35		
TS1403	Imax=1180cd/klm	Imax	565cd	5	3.39	23



3000K		H(m)	D(m)	Emax(lx)		
Ra90			37°			
Fixture Power	8W	1	0.68	614		
Source Flux	520lm	2	1.36	153		
Fixture Flux	300lm	3	2.04	68		
Efficacy	39lm/W	4	2.71	38		
TS1403	Imax=1180cd/klm	Imax	614cd	5	3.39	25



3500K		H(m)	D(m)	Emax(lx)		
Ra90			37°			
Fixture Power	8W	1	0.68	657		
Source Flux	557lm	2	1.36	164		
Fixture Flux	321lm	3	2.04	73		
Efficacy	41lm/W	4	2.71	41		
TS1403	Imax=1180cd/klm	Imax	657cd	5	3.39	26



4000K		H(m)	D(m)	Emax(lx)		
Ra90			37°			
Fixture Power	8W	1	0.68	657		
Source Flux	557lm	2	1.36	164		
Fixture Flux	321lm	3	2.04	73		
Efficacy	41lm/W	4	2.71	41		
TS1403	Imax=1180cd/klm	Imax	657cd	5	3.39	26