

# EUROSTANDARD PLUS TRACK - RECESSED TRIMLESS

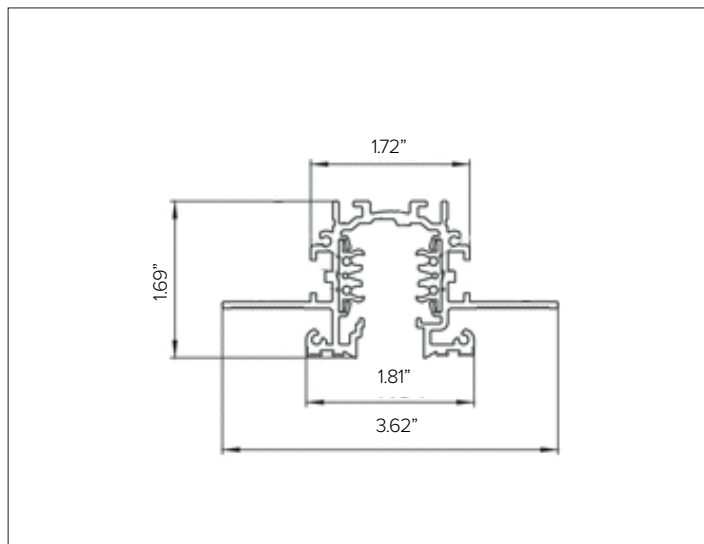

## CONCEPT

Recessed trimless electrified track system.

## MECHANICAL CHARACTERISTICS

<b>Dimensions</b>	3.62"W X 1.69"H
<b>Materials</b>	Aluminum track with copper conductors that feed electricity to the fixture and provide attachment support.
<b>Finish</b>	<input type="radio"/> White <input checked="" type="radio"/> Black
<b>Power Connection</b>	Mechanical electrical polarized connections. For current limiting solutions, 3rd party current limiter breaker panel to be supplied by others.
<b>Functionality</b>	Different mounting configurations are achievable using electrical feeds and connectors that make it possible to build a simple or complex systems.
<b>Mounting</b>	To be installed in recessed trimless mud in configurations. Support suspensions to be used with track to secure to main construction of the building per NEC requirements. For use in non airtight plenum applications.
<b>Weight</b>	1lbs/ft
<b>Protection</b>	IP20

## ELECTRICAL CHARACTERISTICS

<b>Voltage</b>	120V/60Hz
<b>Circuit</b>	3-circuit, 4+2 conductor
<b>Frequency</b>	60Hz
<b>Control</b>	0-10V Dimming

## CERTIFICATIONS

cULus Listed.  
RoHS3 EU 215/863

## WARRANTY

5 year limited warranty.

# EUROSTANDARD PLUS TRACK - RECESSED TRIMLESS

## SPECIFICATION INFORMATION



Ex: 9000-UL4/B-TR1-120 / 9004/TR-B / 9004/TRL-B / S-9000/T / 9001/B-3C / S-9001/TR-B / S-9000-UL/322-M6-B

1 - TRACK	2 - END CAP	3 - END CAP FLANGE	4 - CUTTING TOOL	5 - ELECTRICAL FEED	6 - FEED HOUSING	7 - ELECTRICAL CONNECTOR	8 - MOUNTING
REQUIRED	REQUIRED	REQUIRED	REQUIRED	REQUIRED	REQUIRED	OPTIONAL	REQUIRED

### 1 - TRACK (REQUIRED)

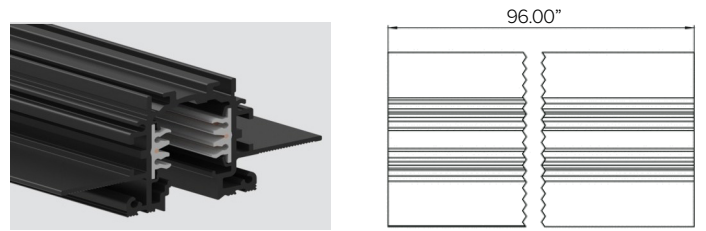
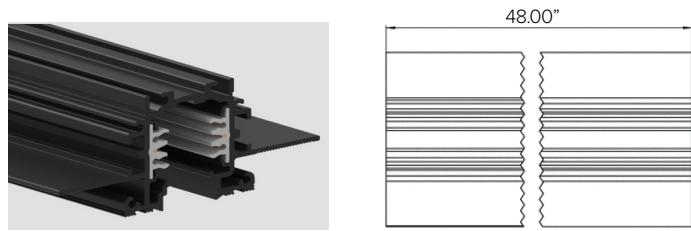

STUCCHI EUROSTRANDARD PLUS recessed trimless, field cuttable with specialized tool (REQUIRED).

Finish  White  Black

Part No. **9000-UL4/W-TR1-120** **9000-UL4/B-TR1-120**

STUCCHI EUROSTRANDARD PLUS recessed trimless, field cuttable with specialized tool (REQUIRED).

Finish  White  Black

Part No. **9000-UL8/W-TR1-120** **9000-UL8/B-TR1-120**

### 2 - END CAP (REQUIRED)

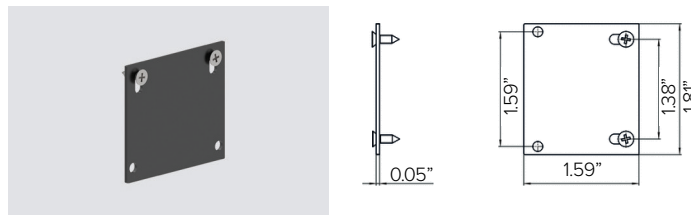

STUCCHI EUROSTRANDARD PLUS recessed trimless end cap kit with locking screws, 1pc.

Finish  White  Black

Part No. **9004/TR-W** **9004/TR-B**

### 3 - END CAP FLANGE (REQUIRED)

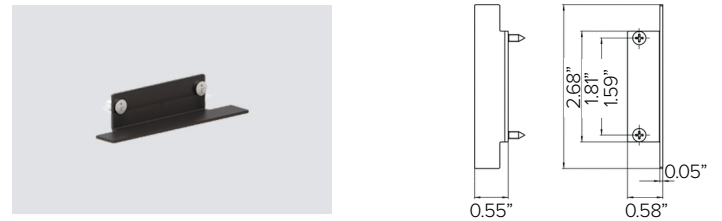

STUCCHI EUROSTRANDARD PLUS recessed trimless end cap flange kit with locking screws, 1pc

Finish  White  Black

Part No. **9004/TRL-W** **9004/TRL-B**

### 4 - CUTTING TOOL (REQUIRED)

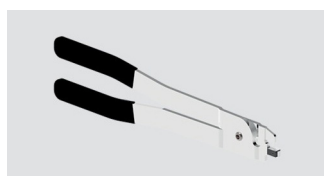

Cutting tool for track conductors.

**S-9000/TR1**

# EUROSTANDARD PLUS TRACK - RECESSED TRIMLESS

## 5 - ELECTRICAL FEED (REQUIRED)

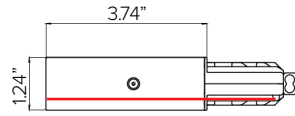

End feed polarity right/ground left.

Finish  White  Black

Part No. **9001/W-3C** **9001/B-3C**

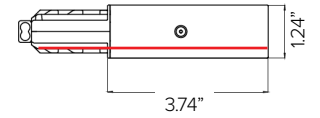

End feed polarity left/ground right.

Finish  White  Black

Part No. **9002/W-3C** **9002/B-3C**

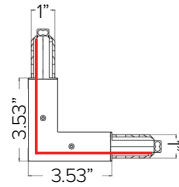
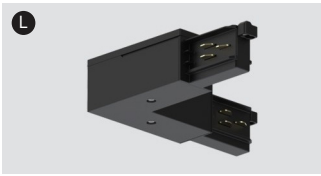

L – Feed polarity external/ground internal

Finish  White  Black

Part No. **9012/W-3C** **9012/B-3C**

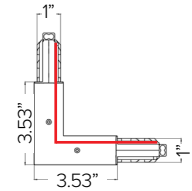

L – Feed polarity internal/ground external.

Finish  White  Black

Part No. **9011/W-3C** **9011/B-3C**

## 6 – FEED HOUSING (REQUIRED)

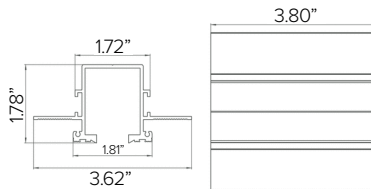

STUCCHI EUROSTRANDARD PLUS recessed trimless feed housing. Compatible with left/right and linear end feeds only.

Finish  White  Black

Part No. **S-9001/TR-W** **S-9001/TR-B**

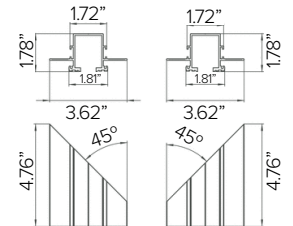

STUCCHI EUROSTRANDARD PLUS recessed trimless 'L' feed housing. Compatible with L-feed only.

Finish  White  Black

Part No. **S-9011/TR-W** **S-9011/TR-B**

## 7 - ELECTRICAL CONNECTOR (OPTIONAL)

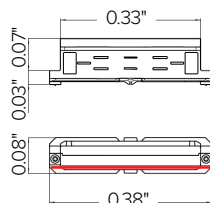

Linear joint connector.

Finish  White  Black

Part No. **9003/W** **9003/B**

**EUROSTANDARD PLUS TRACK - RECESSED TRIMLESS**

**8 – MOUNTING (REQUIRED)**

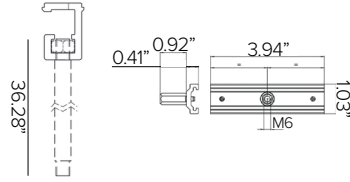

Suspension kit with track support bracket and threaded rod with mounting bracket, 1pc.

Finish ● Black

Part No. **S-9000-UL/322-M6-B**

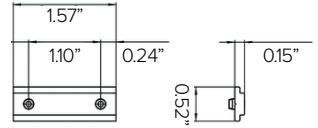

Linear joint connector, 2pcs. REQUIRED for use with interconnected lengths track lengths.

Finish ●

Part No. **S-9500/314-B**