

FCWSQ606

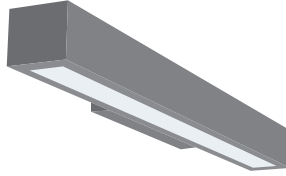

Date:	Approved:
Type:	
Fixture:	
Project:	

FCWSQ606 Heavy walled extruded aluminum with welded corners and waterproof gasket sealed lens for Interior / Exterior, Square Cylinder Wall Mount.

ORDERING

FCWSQ606				CRI80	15L											
SERIES	VOLTAGE		CCT		CRI		LUMENS		FINISH		OPTICS				OPTIONS	
FCWSQ606	120V	120V	27K	2700K	CRI80	80 CRI	15L	1500 lm	BK	Black	UP		DOWN		F	Fuse
	277V	277V	3K	3000K					BZ	Bronze	UWFL	Wide Flood	DWFL	Wide Flood	LD	0-10V Dimming
			35K	3500K					SL	Silver	UNO	None	DNO	None	VP	Vertical Position Mount
			4K	4000K					WH	White						
									CC	Custom Color						

SPECIFICATION

MOUNTING

- Mounts directly to standard outlet box with additional mounting holes to secure directly to the mounting surface.
- Optional: Mounting in vertical position (VP)

CONSTRUCTION

- Marine grade, corrosion resistant, heavy walled extruded aluminum with welded corners.
- Lens is heat resistant, clear, tempered glass. Vandal resistant.
- Neoprene continuous closed cell urethane gasket to seal out contaminants.
- Captive and recessed stainless steel, tamper resistant hex socket screws.

LED

- Lumens stated are the minimum lumens delivered out of the luminaire. LED lifetime is greater than or equal to 70,000 hours with the lumen depreciation greater than L70. All of our luminaires are tested to LM 80 with 80 CRI and color consistency of 3 SDCM. Integral power supply standard. Input voltage 120V or 277V. Consult factory for dimming and any single color options.

FINISH

- Six stage chemical iron phosphate conversion pre-treatment. Polyester powder coat finish, 18 µm Min., 5000hr salt spray test (ASTM B117) compliant with Florida / AAMA 2604 specification.

LISTING

- ETL, U.S. and CA listed for wet locations. IP65 rating.

Due to continuous development and improvements, specifications are subject to change without notice. FC Lighting reserves the right to change lab test details or specifications without notice. Product use certifies agreement to FC Lighting terms and conditions. FCW & FCWS Series fixtures are engineered and produced in our Illinois manufacturing facility.

 US Commercial Lighting Manufacturer Since 1982

Specification Sheet

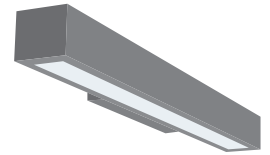

DIMENSIONS

FCWSQ606

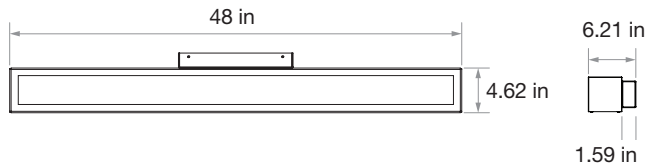

Due to continuous development and improvements, specifications are subject to change without notice. FC Lighting reserves the right to change lab test details or specifications without notice. Product use certifies agreement to FC Lighting terms and conditions. FCW & FCWS Series fixtures are engineered and produced in our Illinois manufacturing facility.

 US Commercial Lighting Manufacturer Since 1982

Specification Sheet

© FC Lighting, Inc. 3609 swenson ave • st. charles il • 60174 | fclighting.com | 800.900.1730

AG-DM-091622