

4" SQUARE RETRACTABLE TRIM RECESSED LIGHTING

RTM4020



Project Name :
Project Type :
Location :
Quantity :
Contact/Phone :
Comments :

SPECIFICATIONS

Description

The RTM4020 is a die cast aluminum retractable square trim. Simply designed to allow a straight forward look while still being functionally adjustable. Adjustable aiming capability (30° from vertical) provide versatility for a wide range of accent and task application. Rear and front load for re-lamping. Available in Black, White, Brushed Nickel and Bronze.

Features

- Rear and front load lamping.
- 30° adjustable from vertical.

Trim Material

- Precision spun .040" die cast aluminum construction to reduce aperture glare.

Lamp Wattage / Type

- GU5.3 base MR16, 50W max, 12V.
- Medium base MR16, 50W max, 120V.

Housing

- Designed for use with all Liteline 4" low voltage recessed housings.

Listings



ORDERING GUIDE

Item No.

RTM4020-BK
RTM4020-WH
RTM4020-BN
RTM4020-BZ

Color

Black
White
Brushed Nickel
Bronze

DIMENSIONS

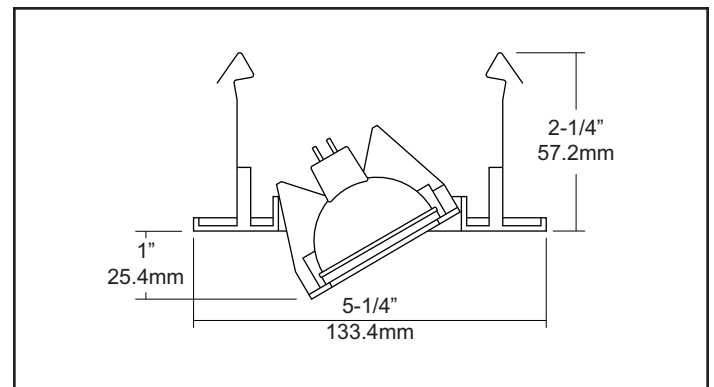

Product specifications subject to change without notice.

© Copyright 2011 Liteline Corporation.



LITELINE CORPORATION
info@liteline.com
www.liteline.com

8 Abacus Road
Brampton, Ontario
Canada L6T 5B7

PHONE | TÉLÉPHONE
416-996-1856
1-866-730-7704

FAX | TÉLÉCOPIEUR
905-794-1990
1-888-738-9736

REV018-6.10.11