

DATE:	PROJECT:	TYPE:
-------	----------	-------

CATALOG NUMBER LOGIC:



*Available for x43, x44 and x45 only.

CATALOG NUMBER LOGIC

Example: AP - LED - x43 - NFL - SAP - 12 - 11 - B

MATERIAL

Aluminum

SERIES

AP - Alpine

SOURCE

LED - Chip on Board Technology

LED TYPE

x43 - 34W LED/2700K x46 - 42W LED/2700K x49 - 57W LED/2700K

x44 - 34W LED/3000K x47 - 42W LED/3000K x50 - 57W LED/3000K

x45 - 34W LED/4000K x48 - 42W LED/4000K x51 - 57W LED/4000K

OPTICS

NSP - Narrow Spot (18°)* FL - Flood (40°)

NFL - Narrow Flood (25°) WFL - Wide Flood (60°)

FINISH (See page 2 for full-color swatches)

Standard Finishes (BZP, BZW, BLP, BLW, WHP, WHW, SAP, VER)

Premium Finish (ABP, AMG, AQW, BCM, BGE, BPP, CAP, CMG, CRI, CRM, HUG, MDS, NBP, OCP, RMG, SDS, SMG, TXF, WCP, WIR)

Also available in RAL Finishes

LENS TYPE

12 - Soft Focus

SHIELDING

11 - Honeycomb Baffle

CAP STYLE

B - 90°

C - Flush

E - 90° Less Weephole (Interior use only)

DATE:	PROJECT:	TYPE:
-------	----------	-------

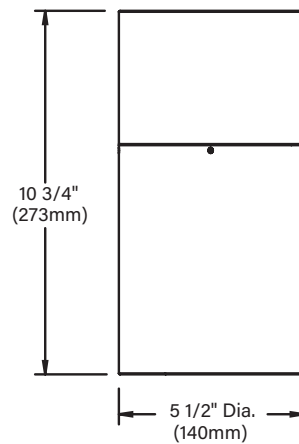
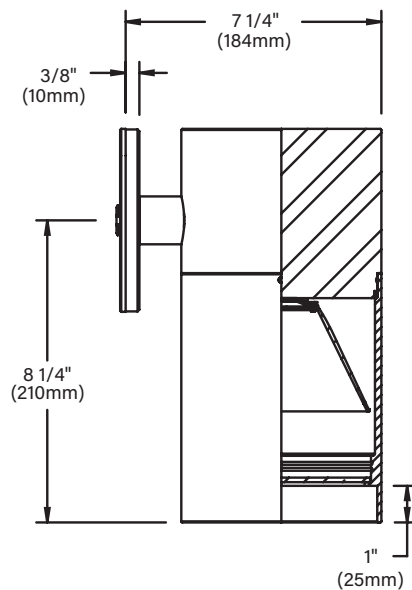
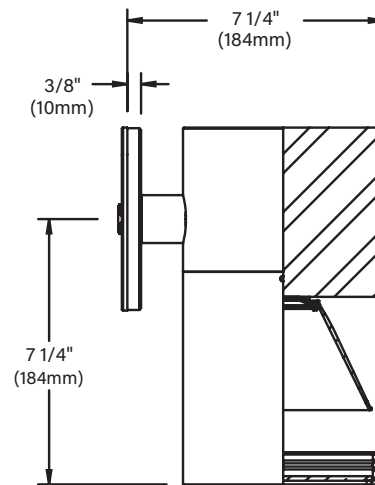
**"B/E" CAP****"C" CAP****STANDARD FINISHES**

[Click Here](#) to view larger, full-color swatches of all available finishes on our website.

PREMIUM FINISHES**B-K LIGHTING****MADE IN THE USA**559.438.5800 | INFO@BKLIGHTING.COM | BKLIGHTING.COM

DATE:	PROJECT:	TYPE:
-------	----------	-------

Accessories (Configure separately)

Drivers (Configure separately)

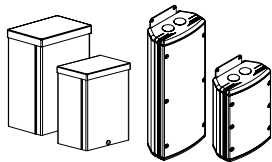

DRM & RM PM3DRM & PM3RM

SPECIFICATIONS

ELECTRICAL	WATTAGE	34W or 57W
	WIRING	PVC coated, 18AWG, 150V, 60°C rated and certified to UL 1838 standard.
	REMOTE DRIVER	For use with remote LED Driver. See remote driver submittal(s) to determine remote distance, dimming range, and wiring requirements prior to detailing field installation of any remote wiring.
PHYSICAL	MATERIALS	Furnished in copper-free aluminum (6061-T6).
	BODY	Unibody design with enclosed, water-proof wireway and integral heat sink is fully machined from solid billet.
	CAP	Fully machined and accommodates two (2) lens or louver media.
	LENS	Shock-resistant, tempered glass lens is factory adhered to fixture cap and provides hermetically sealed optical compartment.
	LED	Integrated solid state system is scalable for field upgrade, provides long life, significant energy reduction and exceptional thermal management. Modular design with electrical quick disconnects permit field maintenance. Minimum 50,000 hour rated life at 70% of initial lumens (L70).
	COLOR MANAGEMENT	Chip on board technology delivers natural white light. Exact color point conformity exceeds ANSI C78.377 standard. Module exceeds 80 CRI (RA>80, R9i6). Color point uniformity 2 SDCM color control for 2.7K-4K CCT.
	INSTALLATION	5" dia., machined canopy with machined aluminum mounting ring permits mounting to 4" octagonal junction box (by others).
	OPTICS	Interchangeable OPTIKIT modules permit field changes to optical distribution.
	HARDWARE	Tamper-resistant, stainless steel hardware. Canopy mounting screws are black oxide treated for additional corrosion resistance.
	FINISH	StarGuard, our 15-stage chromate-free process cleans and conversion coats aluminum components prior to application of Class 'A' TGIC polyester powder coating and is RoHS compliant.
	WARRANTY	5-year limited warranty.
	CERTIFICATION & LISTING	ITL tested to IESNA LM-79. UL Listed. Certified to CAN/CSA/ANSI Standards. RoHS compliant. Suitable for indoor or outdoor use, in wet locations, and for installation within 4' of the ground. IP66 Rated. Made in the USA with sustainable processes.



RoHS



B-K LIGHTING

MADE IN THE USA

559.438.5800 | INFO@BKLIGHTING.COM | BKLIGHTING.COM

LAMP & DRIVER DATA (x43, x44, x45, x46, x47, x48, x49, x50, x51)

DATE:

PROJECT:

TYPE:

LM79 DATA						L70 DATA		OPTICAL DATA				
BK No.	Lumens (Source) (Tj=25°C)	CCT (Typ.)	CRI (Ra. Typ.)	Color Consistency	Input Watts (Typ.)	Minimum Rated Life (hrs.) 70% of initial lumens (L70)		Beam Type	Angle	x45 CBCP	x48 CBCP	x51 CBCP
x43	3850	2700K	80	±60K	34	50,000		Narrow Spot	18°	20780	N/A	N/A
x44	4050	3000K	80	±60K	34	50,000		Narrow Flood	25°	5908	17560	23105
x45	4200	4000K	80	±60K	34	50,000		Flood	40°	4174	5539	7311
x46	5350	2700K	80	±60K	42	50,000		Wide Flood	60°	2931	3725	4966
x47	5700	3000K	80	±60K	42	50,000						
x48	5950	4000K	80	±60K	42	50,000						
x49	6900	2700K	80	±60K	57	50,000						
x50	7400	3000K	80	±60K	57	50,000						
x51	7725	4000K	80	±60K	57	50,000						