

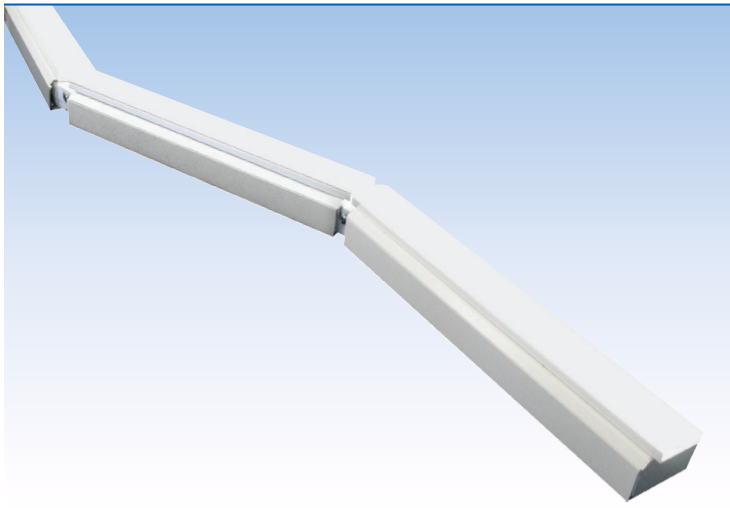

LED FIELD CURVEABLE COVE / INDIRECT LIGHTING

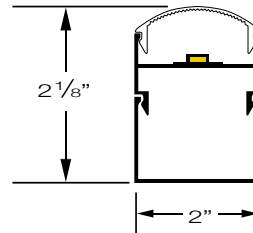

PROJECT:
TYPE:



ST

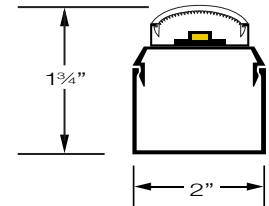

FLX

SPECIFICATIONS

HOUSING	Extruded aluminum housing up to 12' long. Continuous runs available.
FINISH	Satin anodized or white paint finish standard. Custom finish optional.
LENS	Extruded DR acrylic, snap-on frosted widespread lens.
LED DRIVER	Integral, universal voltage; 0-10V dimming standard; 1% or 10% dimming.
MOUNTING	SURFACE MOUNT: Mounting holes pre-drilled. See page 2 for details. CABLE SUSPENDED: Aircraft cable suspension kit (SK), canopy and prewired with 18/5 SVT cord.
LED's	60,000 hours. (L70), High uniformity, 85 CRI, by Nichia and Cree.
CERTIFICATION	ETL/CSA listed for damp locations. 2001431 MADE IN THE USA

LED COLOR & LUMEN OPTIONS

LED COLOR	CRI	LUMENS PER FOOT – WATTS PER FOOT – LUMENS PER WATT								
		LOW			MEDIUM			HIGH		
WHITE 2700K	85	458 L/FT	3.9 W/FT	117 L/W	850 L/FT	7.9 W/FT	107 L/W	1149 L/FT	11.5 W/FT	100 L/W
WHITE 3000K	85	474 L/FT	3.9 W/FT	121 L/W	878 L/FT	7.9 W/FT	111 L/W	1187 L/FT	11.5 W/FT	103 L/W
WHITE 3500K	85	487 L/FT	3.9 W/FT	124 L/W	903 L/FT	7.9 W/FT	114 L/W	1221 L/FT	11.5 W/FT	106 L/W
WHITE 4000K	85	497 L/FT	3.9 W/FT	126 L/W	920 L/FT	7.9 W/FT	116 L/W	1244 L/FT	11.5 W/FT	108 L/W

Values include .85 driver efficiency factor. Higher lumen packages available.

CONFIGURATION



ST - STRAIGHT

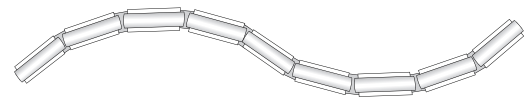

FLX - FLEXIBLE, FIELD CURVEABLE

PART NUMBER

SERIES	LUMENS	COLOR	VOLTS	CONFIGURATION	FINISH	LENGTH
ALX2-LP	L LOW	27K 2700K	120V/277V	ST STRAIGHT	S SATIN	SPECIFY
	M MEDIUM	3K 3000K	UNV 1 1% DIM	FLX FIELD CURVEABLE	W WHITE	
	H HIGH	35K 3500K	UNV 10 10% DIM		C CUSTOM	
	CP CUSTOM PROGRAMMED (Specify Lumens/FT or Watts/FT)	4K 4000K				

QUICK LIGHTING GUIDE

CEILING COVE LIGHTING

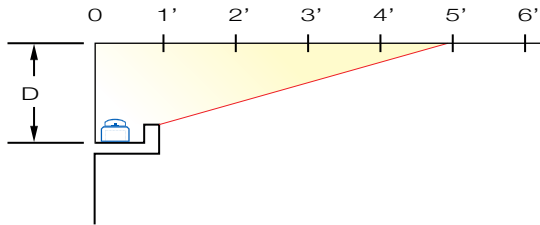

WALL LIGHTING

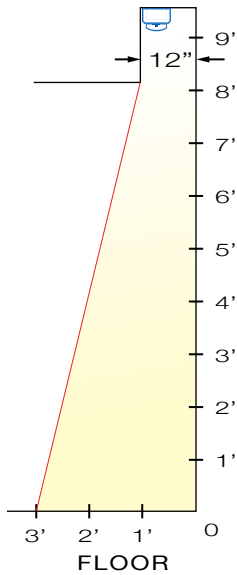

CEILING COVE FOOTCANDLES

D	1'	2'	3'	4'	5'	6'	7'	8'	9'
12"	68	13	3.5	1.9	1.0	0.8	0.7	0.6	0.6
18"	68	21	8.6	3.1	1.9	1.0	0.8	0.7	0.7
24"	63	26	11	5.9	2.5	1.7	1.2	1.0	0.7
36"	44	30	17	7.2	4.3	4.0	2.8	1.5	1.2

Calculation using "LOW" lumen board; 385L x 3500K

WALL WASH COVE FOOTCANDLES

	1'	2'	3'	4'	5'	6'	7'	8'	9'
WALL	2.1	2.4	2.9	3.8	5.3	7.8	12	27	57
FLOOR	1.5	2.1	2.2	2.1	2.1	1.8	1.6	1.0	0.8

Calculation using "LOW" lumen board; 385L x 3500K

CONVERSION CHART

LUMENS	27K	3K	35K	4K
LOW	.90	.96	1	1.06
MEDIUM	1.75	1.86	1.97	2.05
HIGH	2.05	2.11	2.57	2.64

RADIUS, COVE & FIXTURE DIMENSIONS

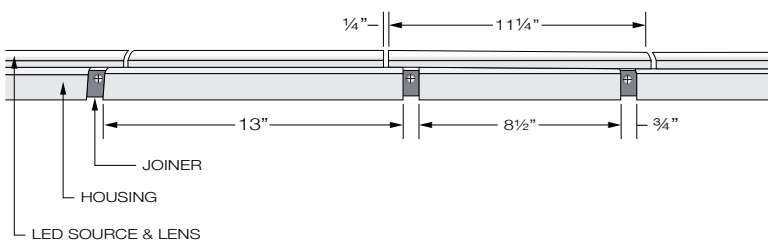
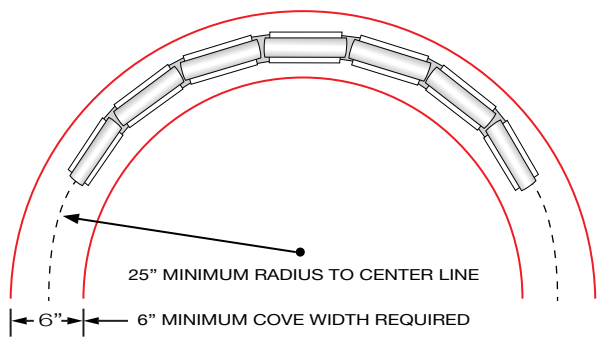

PHOTOMETRICS

FILE NAME: L10137801R01.IES

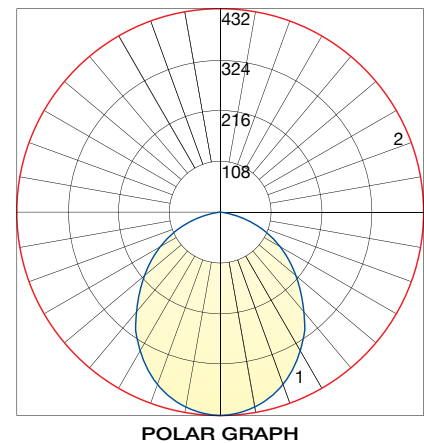

Maximum Candela = 432

Located at Horizontal Angle = 0 Vertical Angle = 0

#1 – Vertical Plane through Horizontal Angles (0–180) (Through Max. Cd.)

#2 – Horizontal Cone through Vertical Angle (0) (Through Max. Cd.)