

LINEAR CABLE SUSPENDED / SURFACE MOUNT

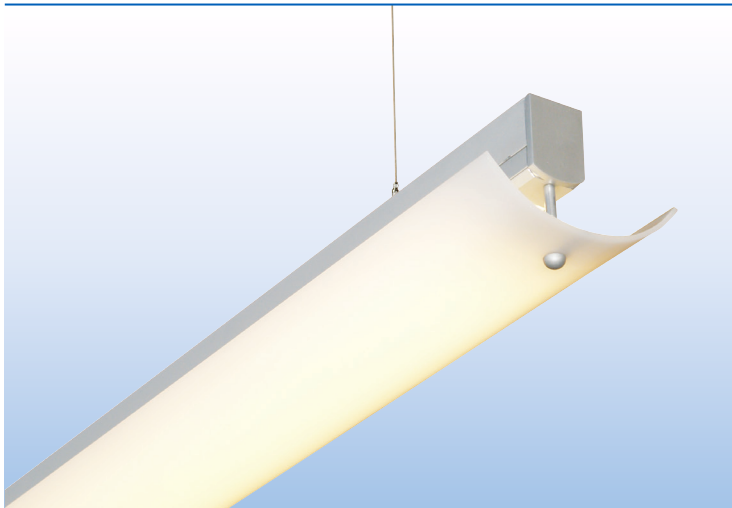

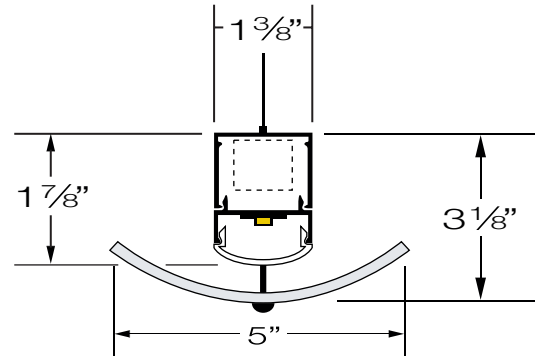

PROJECT:

TYPE:



SPECIFICATIONS

HOUSING	Extruded aluminum housing up to 12' long.
FINISH	Satin anodized or white paint finish standard. Custom finish optional.
LENS	Extruded DR acrylic, snap-on frosted widespread lens.
REFLECTOR	Decorative curved reflectors: white acrylic or perforated aluminum with acrylic overlay diffuser.
LED DRIVER	Integral, universal voltage; 0-10V dimming standard; 1% or 10% dimming.
MOUNTING	SURFACE MOUNT: Mounting holes pre-drilled. See page 2 for details. CABLE SUSPENDED: Aircraft cable suspension kit (SK), canopy and prewired with 18/5 SVT cord.
LED's	60,000 hours. (L70), High uniformity, 85 CRI, by Nichia and Cree.
CERTIFICATION	ETL/CSA listed for damp locations.  2001431  MADE IN THE USA

LED COLOR & LUMEN OPTIONS

LED COLOR	CRI	LUMENS PER FOOT – WATTS PER FOOT – LUMENS PER WATT								
		LOW			MEDIUM			HIGH		
WHITE 2700K	85	458 L/FT	3.9 W/FT	117 L/W	850 L/FT	7.9 W/FT	107 L/W	1149 L/FT	11.5 W/FT	100 L/W
WHITE 3000K	85	474 L/FT	3.9 W/FT	121 L/W	878 L/FT	7.9 W/FT	111 L/W	1187 L/FT	11.5 W/FT	103 L/W
WHITE 3500K	85	487 L/FT	3.9 W/FT	124 L/W	903 L/FT	7.9 W/FT	114 L/W	1221 L/FT	11.5 W/FT	106 L/W
WHITE 4000K	85	497 L/FT	3.9 W/FT	126 L/W	920 L/FT	7.9 W/FT	116 L/W	1244 L/FT	11.5 W/FT	108 L/W

Values include .85 driver efficiency factor. Higher lumen packages available.

PART NUMBER

SERIES	LUMENS	COLOR	VOLTS	REFLECTORS	MOUNTING	FINISH	LENGTH
ALX3-DR	L LOW	27K 2700K	UNV	WAR WHITE ACRYLIC	<u>CABLE SUSPENDED</u>	S SATIN	4'
	M MEDIUM	3K 3000K	(120/277)	PARD PERFORATED AL.	SK36 36" CABLE KIT	W WHITE	8'
	H HIGH	35K 3500K	10% DIM	W/ DIFFUSER	SK48 48" CABLE KIT	C CUSTOM	12'
	CP CUSTOM PROGRAMMED (Specify Lumens/FT or Watts/FT)	4K 4000K	UNV 1% (120/277) 1% DIM		<u>SURFACE MOUNT</u>		
					SM SURFACE MOUNT		
					JBP J BOX PLATE		

REFLECTOR OPTIONS

WAR WHITE ACRYLIC

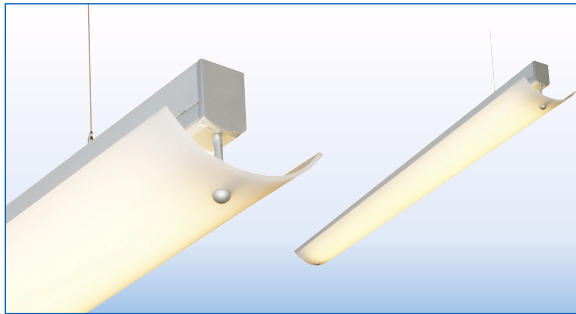

ENDVIEW

PARD PERFORATED ALUMINUM WITH DIFFUSER

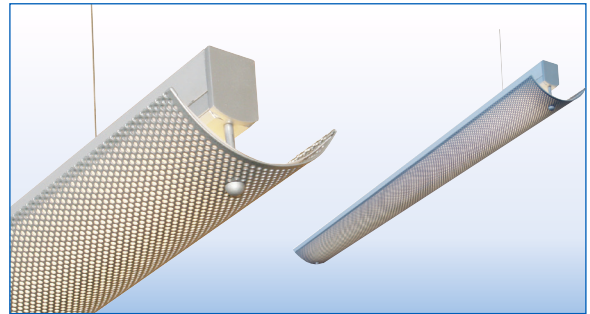

ENDVIEW

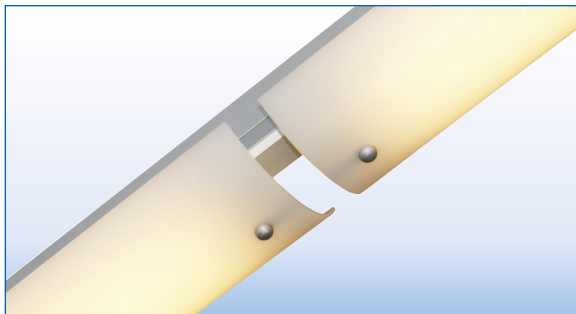

8' - 12' CENTER DETAIL VIEW 1

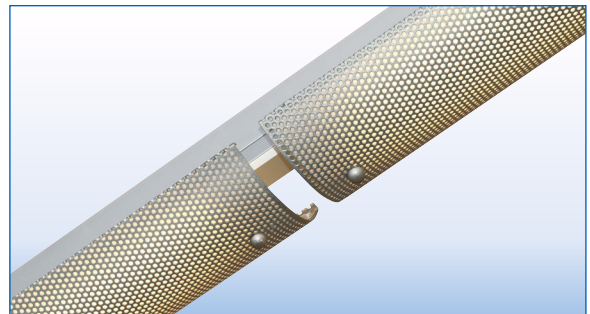

8' - 12' CENTER DETAIL VIEW 1



8' - 12' CENTER DETAIL VIEW 2



8' - 12' CENTER DETAIL VIEW 2

FIXTURE LENGTHS

NOMINAL LENGTH	4'	8'	12'
ACTUAL LENGTH	48"	97"	146"

Note: Reflector overhangs fixture 1" each end.

MOUNTING

CABLE SUSPENDED

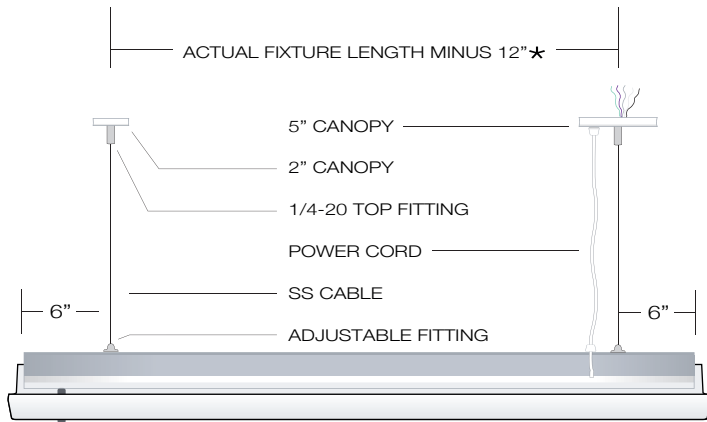

SK36 36" Suspension Kit
SK48 48" Suspension Kit
SK72 72" Suspension Kit
 Other cable lengths available.

Suspension Kit includes:
 (2) Top Fittings for 1/4-20 Rod
 (2) Adjustable Bottom Fittings
 (2) Aircraft Cables
 (1) Prewired 18/5 White SVT Cord
 (1) 5" White Canopy with Mounting Hardware
 (1) 2" White Canopy

- *Custom pendant spacing available; consult factory
- *Lengths over 8' require center cable support
- *EM option includes 18/6 cord

SURFACE MOUNT

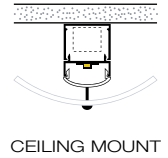
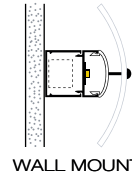

MOUNTING DETAILS

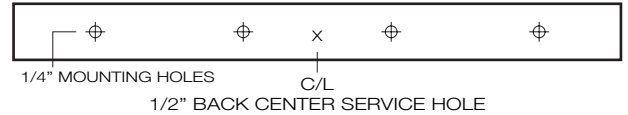

- 1/4" Mounting holes provided evenly spaced on back channel.
- 1/2" Back center service hole for snap-in connector provided for surface mount applications when using standard blank endcap or architectural endcap.
- 2' fixtures require off center service hole due to 12" driver

Note: Narrow housing will not cover recessed J Box. Whip feed recommended. Use optional "JBP" canopy plate for J-Box mount. (See Picture Below)

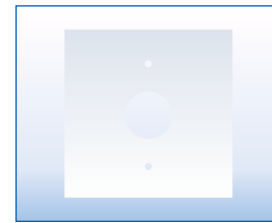

J-BOX PLATE
JBP 5" FLAT CANOPY PLATE
 TO COVER J-BOX

PHOTOMETRICS

WAR WHITE ACRYLIC

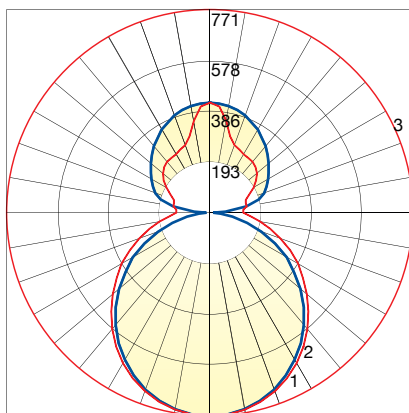

File: L041507501.IES
 Maximum Candela = 771
 High 35K
 IES Files Available By Request

PARD PERFORATED ALUMINUM WITH DIFFUSER

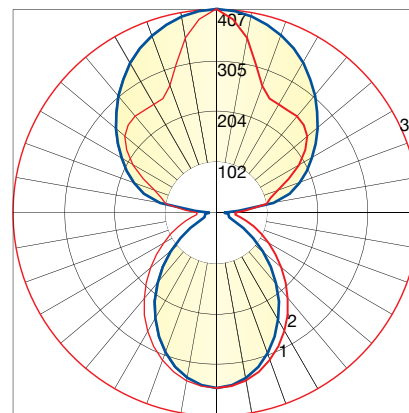

File: L041507502.IES
 Maximum Candela = 407
 High 35K
 IES Files Available By Request