



RPA4-CY-16

PRIME BI-DIRECTIONAL CYLINDER

PROJECT: _____

MODEL #: _____

LOCATION: _____

CONTACT: _____



DIMENSIONS

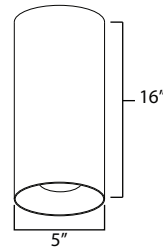

USE OF PRODUCT

PRIME Cylinder Series may be used in hospitality, commercial, retail, and residential applications. This product will reduce energy consumption, emits little heat, and reduces cooling loads for added costs savings. Approximately 75% in energy savings compared to incandescent light source

PRIME CYLINDER FEATURES

LUMEN CHART

WATTAGE	LUMENS
11W	1055 lm
16W	1250 lm
20W	1645 lm

- Color Temperature: 2700K, 3000K, 3500K, or 4000K
- SDCM: 2 Step binning
- Color Rendering Index: 93 CRI Typical
- Optical Lens on both directions: 18°, 30°, 50°, 80°
- Bevel: Die cast with knife edge look
- LED Life: 50,000 hours
- LED Type: Cree LED for maximum light output
- Versatility: Interchangeable reflector, optics and filters
- Warranty: 5 Year Limited Warranty

LED ENGINE

LED engine available with CREE LEDs in 2700K, 3000K, 3500K, or 4000K in standard 93+ CRI. 2 Step MacAdam ellipse allows for color consistency between fixtures. LED mounted to aluminum heat sink for maximum life output and thermal management.

HOUSING

Rugged aluminum housing.

LED DRIVER

Durable dimmable driver provides high power factor with optimum thermal management to prevent damage caused by high temperature.

OPTICS

Field replaceable optical lens available in 18°, 30°, 50°, and 80°. Easily achieve narrow spot to wide flood beam pattern. Option for frosted, honeycomb, or solite filter (2 Maximum).

MOUNTING

The PRIME Cylinder Series may be cable hung or wall mounted.

DIMMING

(ID) Standard all-inclusive ELV, Triac, and 0-10V dimming driver called Intelligent Drive, 120-277V.

LABELS / COMPLIANCE

- CSA Listed for US and Canada
- 5 year limited warranty.

PRIME CYLINDER

ORDERING INFO

RPA	4	CY	16	BD				
Series	Diameter	Shape	Length	Directional	Up-Light Lumens ¹	Up-Light Color Temp.	Down-Light Lumens ¹	Down-Light Color Temp.
PRIME	4 - 5"	CY - Cylinder	16 - 16"	BD - Bi-Direction	10L ¹ - 1055 lm 12L ¹ - 1250 lm 16L ¹ - 1645 lm	27 - 2700K 30 - 3000K 35 - 3500K 40 - 4000K	10L ¹ - 1055 lm 12L ¹ - 1250 lm 16L ¹ - 1645 lm	27 - 2700K 30 - 3000K 35 - 3500K 40 - 4000K

Voltage	Dimming	Up-Light Optical Lens	Up-Light Filter	Down-Light Optical Lens	Down-Light Filter
UNV - 120-277V	ID - Standard all-inclusive ELV, Triac, and 0-10V dimming driver (Intelligent Drive)	18 - 18° 30 - 30° 50 - 50° 80 - 80°	None - Leave blank F - Frosted filter H - Honey comb S - Solite filter	18 - 18° 30 - 30° 50 - 50° 80 - 80°	None - Leave blank F - Frosted filter H - Honey comb S - Solite filter

Bevel Finish	Cylinder Finish	Mounting	Option
W - White B - Black H - Haze S - Specular Clear WE - Wheat MTO - Made to order	BL - Black WH - White SL - Silver MTO - Made to order	TC - Triple Cable WM - Wall Mount	EM ² - Emergency battery

1. combine lumens must not exceed 2700 lm
2. Emergency battery only available in remote mount.

PRIME

TRIM HEIGHT

Trim Details

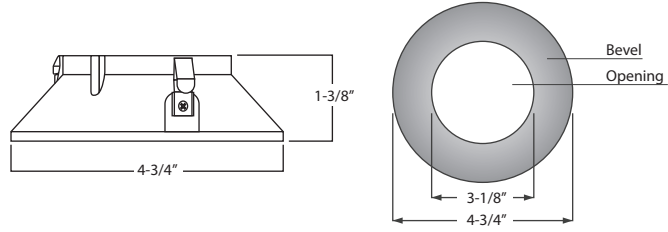
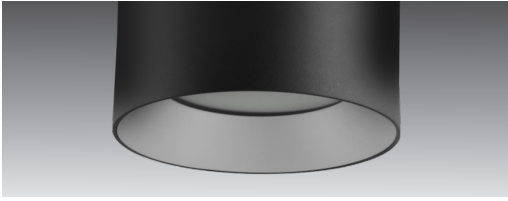

LED HOLDER & FILTER DIMENSION

LED Holder and Filter

