

RULB

COLOR TEMPERATURE SELECTABLE
LED UNDERCABINET

PROJECT: _____

MODEL #: _____

LOCATION: _____

CONTACT: _____



DIMENSIONS

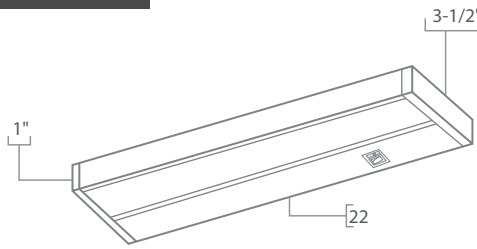

ALL-IN-ONE COLOR TEMPERATURE SELECTABLE

Allows for easy control between 2700K, 3000K, 3500K, 4000K, 5000K color temperature with a simple switch



USE OF PRODUCT

The ideal product for energy efficient lighting for retrofit or new construction applications. It is a great replacement for existing fluorescent, incandescent, halogen, or xenon undercabinet lighting. This product may be used in hospitality, health care, commercial, retail, and residential applications. The RULB series will reduce energy consumption, emits little heat, and reduces cooling loads for added costs.

RULB FEATURES

Length	Watts	Lumens
22"	11W	548Lm

Lumens base on 3000K CCT

- Voltage: 120V
- Color Temperature Selectable: 2700K,3000K,3500K
- Color Rendering Index: 90+ CRI
- LED Life: 50,000 hours
- Warranty: 5 Year Limited Warranty
- Finish: White or Black
- No LED pixelation or glare
- Dimmable
- Wide light distribution allows for continuous illumination when linked with end to end connectors

LED DRIVER

Integral 120 Volt dimmable driver

DIMMING

Please refer to dimmer list

ELECTRICAL CONNECTION

RULB Series may be connected with direct wire or duplex plug. End to end connectors allow fixtures to be linkable.

INCLUDED ACCESSORIES

Captive Screws, Plastic Washer, Wire Connector, End to End Connector, On/Off Locker Switch, 3/8" Diecast Outlet

OPTIONAL ACCESSORIES

Power Cord, Linkable Connector with wire (Available in 5 different lengths). Junction Box.

LABELS / COMPLIANCE

UL/cUL Classified
Damp Location Rated
Can be used for State of California Title 24 & JAB compliance.
Energy Star

COLOR TEMPERATURE SELECTABLE

Rayon Lighting's all-in-one Color Temp. Selectable LED undercabinet allows for easy control between 2700K, 3000K, 3500K, 4000K and 5000K color temperature with a simple switch.

ORDERING INFO

Series	Length	Color Temp.	Finish	Options
RULB	22 - 22"	5CTS - Color temperature selectable (27K,30K,35K,40K,50K) CTS - Color temperature selectable (27K,30K,35K)	W - White B - Black	LC24-W - White linkable connector with 24" lead wire LC24-BL - Black linkable connector with 24" lead wire LC12-W - White linkable connector with 12" lead wire LC12-BL - Black linkable connector with 12" lead wire LC4-W - White linkable connector with 4" lead wire LC4-BL - Black linkable connector with 4" lead wire LC3-W - White linkable connector with 3" lead wire LC3-BL - Black linkable connector with 3" lead wire LC2-W - White linkable connector with 2" lead wire LC2-BL - Black linkable connector with 2" lead wire PC120-W - White power cord PC120-BL - Black power cord JB-W - White J-Box JB-BL - Black J-Box

PROJECT: _____

MODEL #: _____

LOCATION: _____

CONTACT: _____

RULB ANATOMY

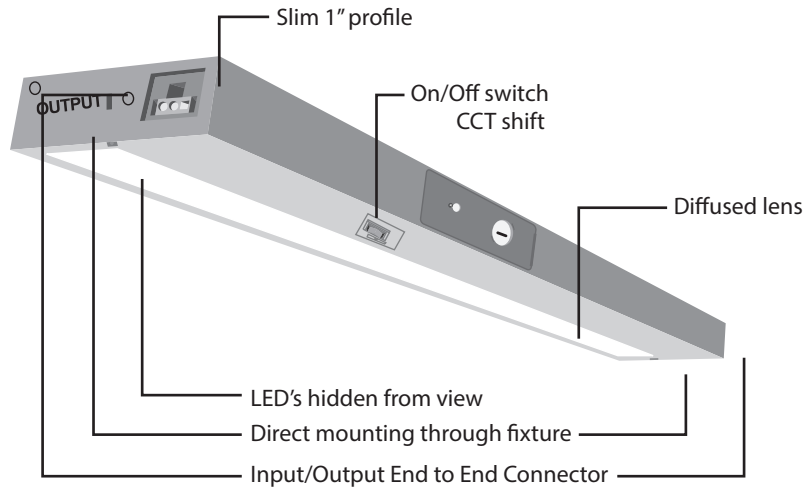

ACCESSORIES

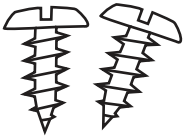

Captive Screws

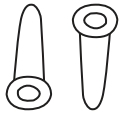

Plastic Washer

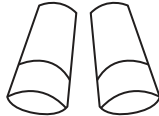

Wire Connector

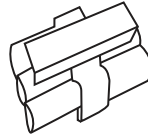

End to End Connector

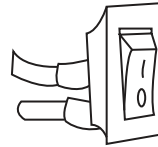

On/Off Switch

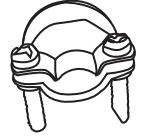

3/8" Diecast Outlet

RULB OPTIONAL ACCESSORIES



Power Cord

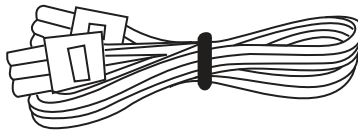

Linkable Connector with Wire
(Available in 4 different lengths)

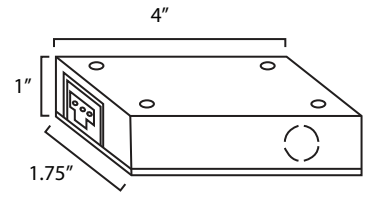

Junction Box

UNDERCABINET INSTRUCTION

MOUNTING FIXTURE

1. Remove Captive Mounting Screw Covers.
2. Place fixture in desired position and drive Mounting Screws securely. In some installations it may be desired to drill a pilot hole for the screws.
3. Replace the Captive Mounting Screw Cover.

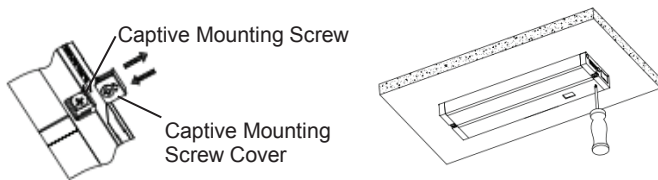

JOINING MULTIPLE FIXTURES

USING JUMPER CORD

1. Remove Electrical Port Covers.
2. Connect INPUT of Jumper cord to INPUT of electrical port.
3. Connect OUTPUT of Jumper cord to OUTPUT of electrical port.

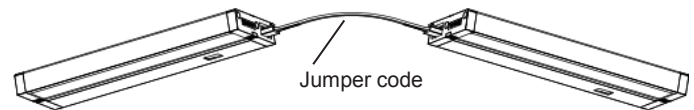

USING END-TO-END CONNECTOR

1. Remove Electrical Port Covers.
2. Connect INPUT of End-to-End connector to INPUT of electrical port.
3. Connect OUTPUT of End-to-End connector to OUTPUT of electrical port.

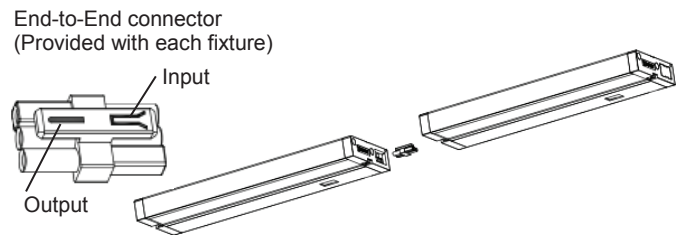

POWER CODE CONNECTION

Remove the Electrical Port Cover and insert the power cord into INPUT electrical port. (Power cord sold separately.)

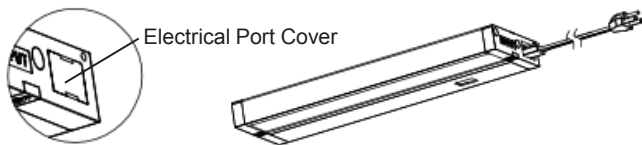

SWITCH CONNECTION

1. Remove knockout in the front of fixture by using a hammer or punch and push a switch into the square hole. (Fig.1)
2. Open a cover in the back using a flat and sharp tool. (Fig.2)
3. Unscrew a P2 connector where 4 black wires are connected. (Fig.3)
4. Use a P2 connector (provided) and connect an INPUT port wire (Black) and a wire from switch. (Fig.3)
5. Use another P2 connector (provided) and connect a wire from Switch and the rest black wires. (Fig.3)
6. Replace the cover.

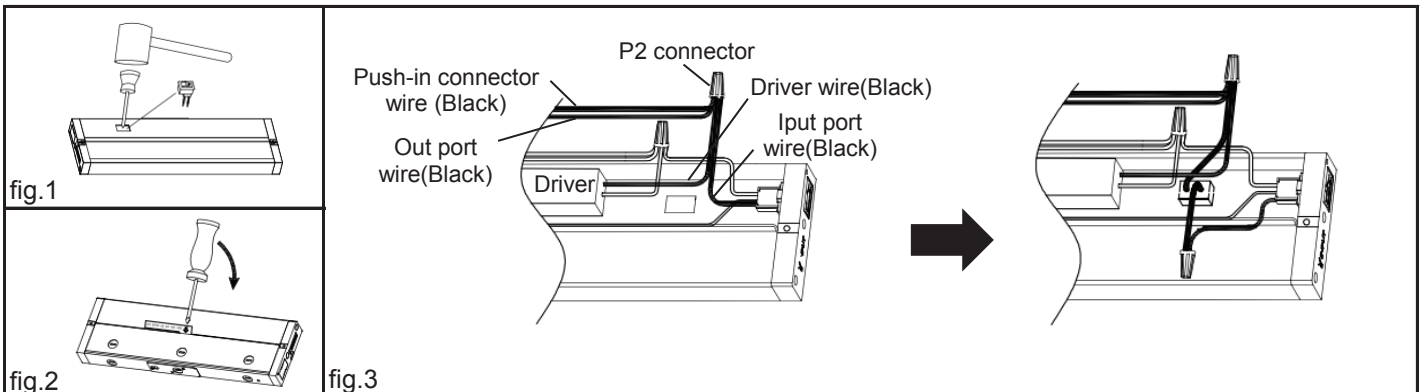

UNDERCABINET INSTRUCTION

WIRING CONNECTIONS THROUGH A REAR ACCESS DOOR

1. Loosen screw that secures rear access door and remove the door from key hole by just a slide. (Fig.4)
2. Assemble 3/8" die-cast connector into Rear Access Door (Fig.5) and push supply cable through the die-cast connector. (Fig. 6)
3. Inside fixture are three wires with Push-in connectors. Carefully pull these out of fixture. Do not pull with excessive force.
4. Insert each of the three wires from the supply cable into each of the three Push-in connectors with respective color wires. Black to Black, White to White and Green (Earth wire) to green.
5. Neatly push wires and push-in connectors into opening in back of the fixture.
6. Close the Rear Access Door and tighten screw.

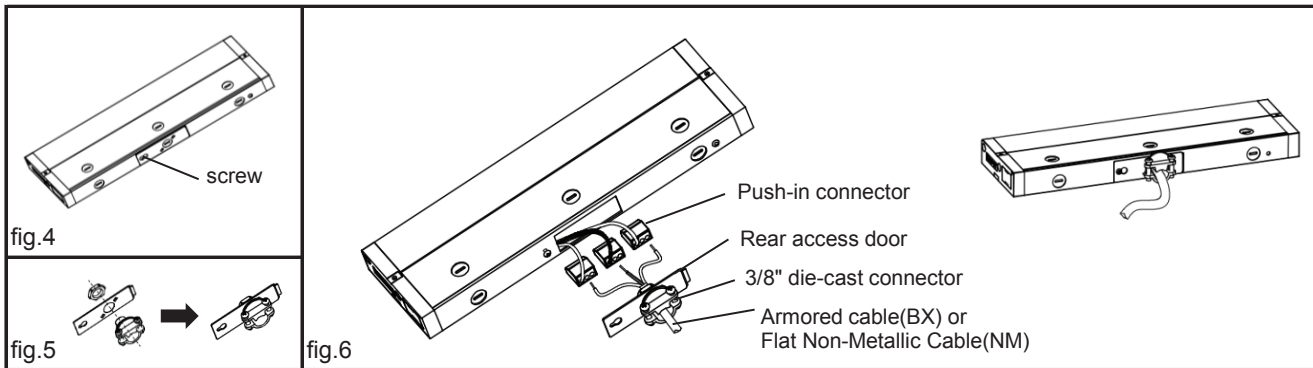

WIRING CONNECTIONS THROUGH A BACK SIDE COVER

1. Open a cover in the back using a flat and sharp tool.
2. Remove knockout and assemble 3/8" die-cast connector.
3. Push supply cable through the die-cast connector and connect wires using Push-in connector.
4. Replace the cover and close up.

DIMMER LIST

LUTRON

MANUFACTURER	MODEL NO.	DIMMING RATE
LUTRON	CT-603PG	10 % - 100 %
LUTRON	CT-600PR-LA	10 % - 100 %
LUTRON	CT-600PR-IV	10 % - 100 %
LUTRON	CT-600PR-WH	10 % - 100 %
LUTRON	DV-600PR	10 % - 100 %
LUTRON	DV603PG	10 % - 100 %
LUTRON	DVW-603PGH-WH	10 % - 100 %
LUTRON	DVCL-153P	10 % - 100 %
LUTRON	MACL-153M	10 % - 100 %
LUTRON	TGCL-153P	10 % - 100 %
LUTRON	S-600PR-WH	10 % - 100 %
LUTRON	S-2-LH	10 % - 100 %

COOPER

MANUFACTURER	MODEL NO.	DIMMING RATE
COOPER	DLC03P	10 - 100%

LEVITON

MANUFACTURER	MODEL NO.	DIMMING RATE
LEVITON	6631	10 % - 100 %
LEVITON	6633	10 % - 100 %
LEVITON	1A1505	10 % - 100 %
LEVITON	1C1605	10 % - 100 %