

PROJECT:	TYPE:	CAT. #:	SPC - - - - -
----------	-------	---------	---------------

## PROFILE

LIGHT SOURCE	HIGH PERFORMANCE LED'S
OUTPUT	7.0 W/FT, 9.0 W/FT, 10.0 W/FT, 12.5 W/FT
DISTRIBUTION	DIRECT, DIRECT/INDIRECT
CCT	2700K - 4000K, RGBW, ACTIVE WHITE
CRI	82 CRI (OPTIONAL 90 CRI)
VOLTAGE	UNIVERSAL 120-277V
POWER SUPPLY	INTEGRAL OR REMOTE
CONTROL	DMX/RDM
LENGTHS	48", 72", 96", CONTINUOUS
WEIGHT	1.4 LBS/FT
HOUSING	PRECISION EXTRUDED ALUMINUM
MOUNTING	POWERED SUSPENSION CABLES
END CAPS	MACHINED ALUMINUM
FINISH	HIGH DURABILITY POWDER COATING
WARRANTY	5-YEAR LIMITED
CERTIFICATION	ETL AND cETL FOR DRY LOCATION
PATENT	U.S. DESIGN PATENT NO. D876,700

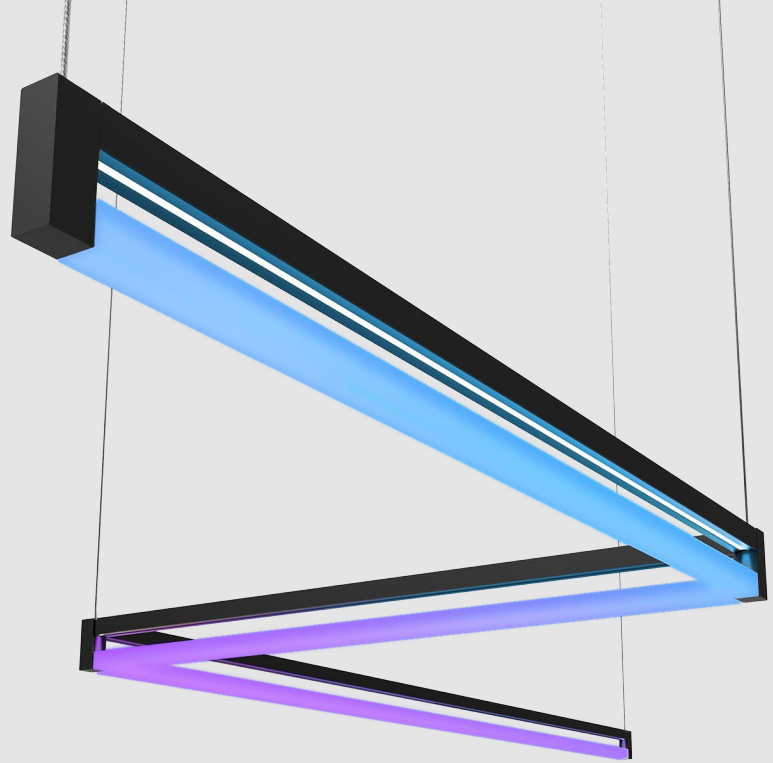

FIXTURE SHOWN: SPC-HO-RGBW-40K-192-DMX4-TBL-TW-COR

## FINISHES



## DISTRIBUTION & CCT

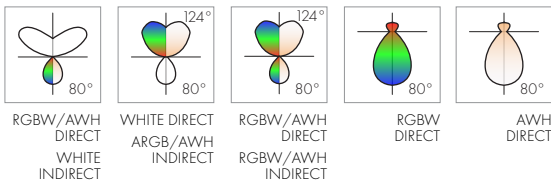

## PROFILE

[go to fixture dimensions >](#)

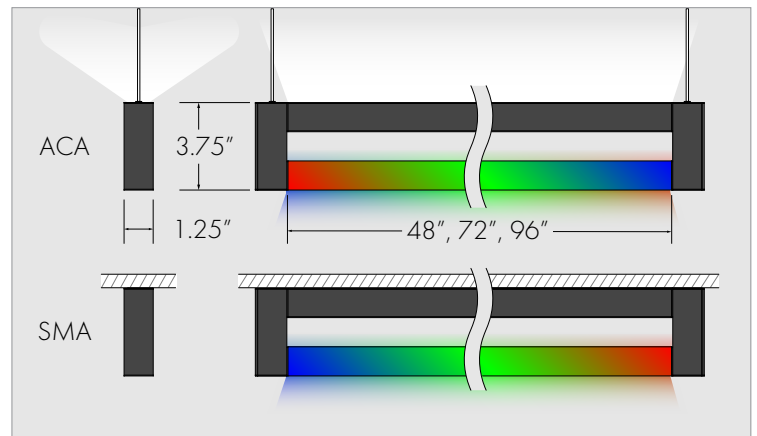

## CORNER AND SHAPE OPTIONS





PROJECT: \_\_\_\_\_ TYPE: \_\_\_\_\_ CAT. #: SPC - - - - -

**PERFORMANCE**

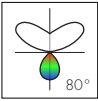
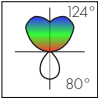
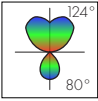
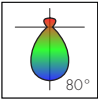
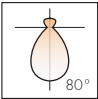
OUTPUT	LENGTH	LED COLOR TEMPERATURE	TOTAL NOMINAL WATTAGE	DIRECT WATTAGE	INDIRECT WATTAGE	LUMINAIRE EFFICACY	DELIVERED LUMEN TOTAL	DELIVERED LUMEN DIRECT	DELIVERED LUMEN INDIRECT
<b>MEDIUM OUTPUT</b>									
	48.00"	RGBW DIR.	42.0 W	4.0 W	36.0 W	- LM/W	- LM	- LM	- LM
	72.00"	4000K IND.	62.0 W	6.0 W	54.0 W	- LM/W	- LM	- LM	- LM
	96.00"		82.0 W	8.0 W	72.0 W	- LM/W	- LM	- LM	- LM
	48.00"	4000K DIR.	42.0 W	4.0 W	36.0 W	- LM/W	- LM	- LM	- LM
	72.00"	RGBW IND.	62.0 W	6.0 W	54.0 W	- LM/W	- LM	- LM	- LM
	96.00"		82.0 W	8.0 W	72.0 W	- LM/W	- LM	- LM	- LM
	48.00"	RGBW DIR.	42.0 W	4.0 W	36.0 W	- LM/W	- LM	- LM	- LM
	72.00"	RGBW IND.	62.0 W	6.0 W	54.0 W	- LM/W	- LM	- LM	- LM
	96.00"		82.0 W	8.0 W	72.0 W	- LM/W	- LM	- LM	- LM
<b>DIRECT</b>									
	48.00"	RGBW	36.0 W	36.0 W	-	178 LM/W	431 LM	431 LM	-
	72.00"		54.0 W	54.0 W	-	170 LM/W	646 LM	646 LM	-
	96.00"		72.0 W	72.0 W	-	170 LM/W	862 LM	862 LM	-
	48.00"	AWH	36.0 W	36.0 W	-	- LM/W	- LM	- LM	-
	72.00"		54.0 W	54.0 W	-	- LM/W	- LM	- LM	-
	96.00"		72.0 W	72.0 W	-	- LM/W	- LM	- LM	-

PROJECT:	TYPE:	CAT. #:	SPC	-	-	-	-	-	-	-	-	-	-	-
----------	-------	---------	-----	---	---	---	---	---	---	---	---	---	---	---

**FIXTURES PER 15A CIRCUIT (AT FULL LOAD)**

FIXTURE LENGTH	LOW		MEDIUM		HIGH		DIRECT	
	120V	277V	120V	277V	120V	277V	120V	277V
48.00"	60	120	33	66	30	60	37	74
72.00"	40	80	22	44	20	40	25	50
96.00"	30	60	16	32	8	16	18	36

**MAXIMUM RUN LENGTHS**

OUTPUT	CONTRA 0.5 (96.0 W)		CONTRA 1.0 DUAL (2x 96.0 W)		LUTRON (96.0 W)	
	LINEAR FEET		LINEAR FEET		LINEAR FEET	
LOW	16.0 FT		34.0 FT		16.0 FT	
MEDIUM	9.0 FT		18.0 FT		9.0 FT	
HIGH	N/A		8.0 FT		N/A	
DIRECT	10.0 FT		20.0 FT		10.0 FT	

**POWER SUPPLIES PER 15A CIRCUIT (AT FULL LOAD)**

	CONTRA 0.5 (96.0 W)		CONTRA 1.0 DUAL (2x 96.0 W)		LUTRON (96.0 W)	
	LINEAR FEET		LINEAR FEET		LINEAR FEET	
120V	15		8		15	
277V	30		15		30	

**REMOTE DISTANCE LIMITS (INCLUDES SUSPENSION CABLE)**

WIRE GAUGE	MAX DISTANCE	NOTE: NON-COMPLIANCE WITH RECOMMENDED REMOTE WIRING DISTANCES MAY VOID WARRANTY
20 AWG	25.0 FT	
18 AWG	30.0 FT	
16 AWG	40.0 FT	
14 AWG	60.0 FT	
12 AWG	100.0 FT	

PROJECT:	TYPE:	CAT. #:	SPC - - - - -
----------	-------	---------	---------------

## FIXTURE DIMENSIONS

DIMENSION	48"	72"	96"
DIM A	48.96"	72.46"	95.96"
DIM B	47.63"	71.13"	64.63"
DIM C	50.41"	73.91"	97.41"

## SUSPENSION ARCHITECTURAL (ACA)

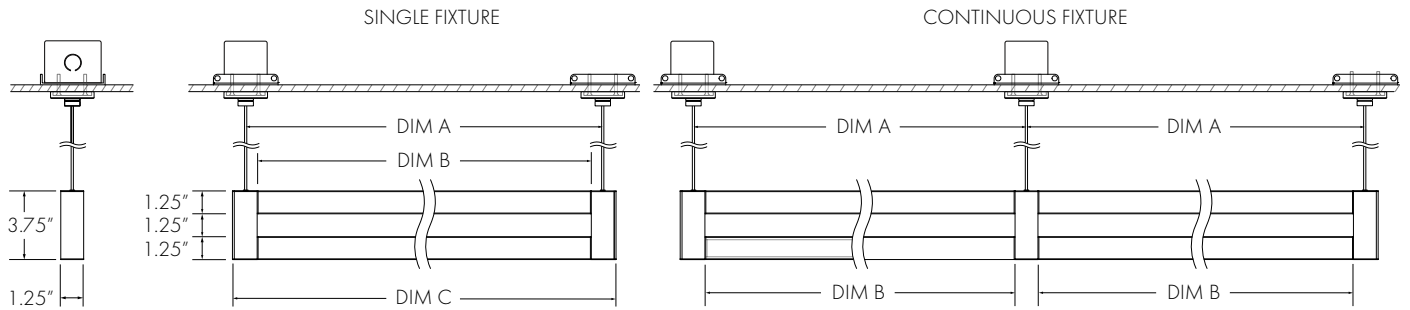

## SURFACE MOUNT (SM)

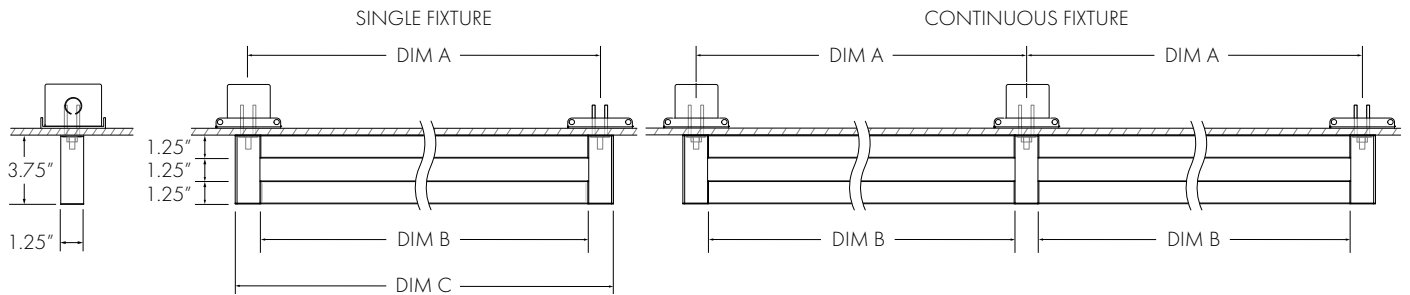

PROJECT: \_\_\_\_\_ TYPE: \_\_\_\_\_ CAT. #: SPC - - - - -

### SUSPENSION MOUNTING DETAILS (STANDARD)

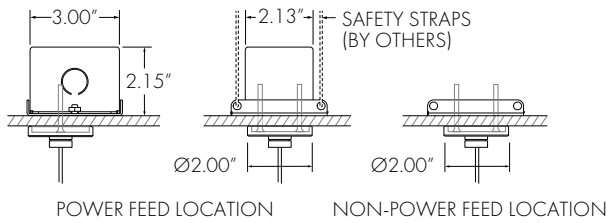

2.00" canopy and plenum rated micro-enclosure. Complete with three 0.88" knock-outs and 0.25" holes for optional suspension cables. For use with surface medium up to 1.13" in thickness. Ceiling canopy finish is SG White unless otherwise specified.

### JBOX MOUNTING KIT (JBK) - OPTION

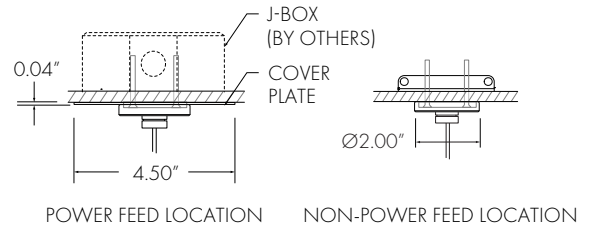

4.50" cover plate provided with standard 2.00" canopy to allow mounting to 4.00" junction boxes at power feed location. Junction box provided by others. Not available with surface mount

### INTEGRAL POWER CANOPY (ISJ) - OPTION

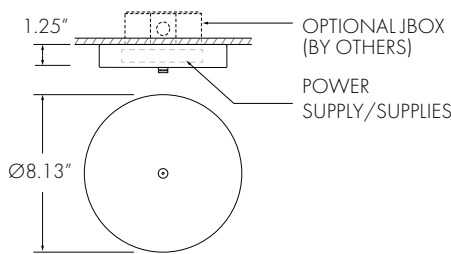

Surface mounted canopy with integrated power supply. Available with dual circuit option. 90.0 W with dimming, 96.0 W with no dimming. Dual option includes two separate drivers.

### HARD CEILING INT. POWER CANOPY (HCISJ) - OPTION

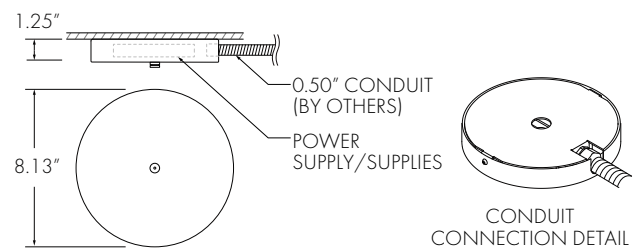

Surface mounted canopy for non-accessible ceilings with integrated 96.0 W power supply ready for 0.5" conduit. Surface mounted canopy for non-accessible ceilings with integrated 96W power supply ready for 0.5" conduit.

### CONTRA C0.5 - REMOTE POWER SUPPLY

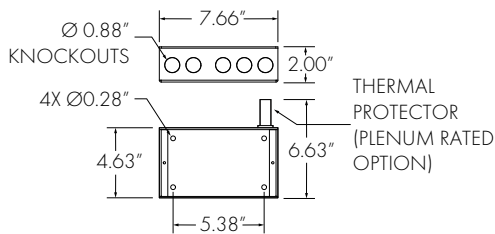

Remote power supply enclosure. 90.0 W with dimming, 96.0 W with no dimming. Plenum rated option available. (PL120 or PL277). Painted textured white.

### CONTRA C1.0 | REMOTE POWER SUPPLY

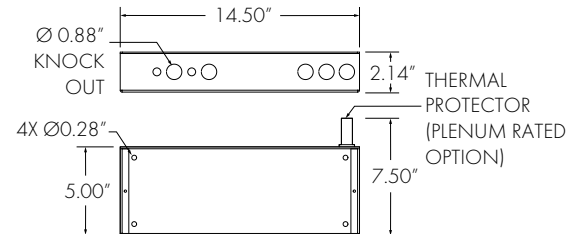

Provided with dual circuit option. 2x 90.0 W with dimming, 2x 96.0 W with no dimming. Painted textured white.

PROJECT: \_\_\_\_\_ TYPE: \_\_\_\_\_ CAT. #: SPC - - - - -

**WIRING EXAMPLES**

**REMOTE POWER CONTRA C0.5 OR C1.0 - SINGLE FIXTURE**

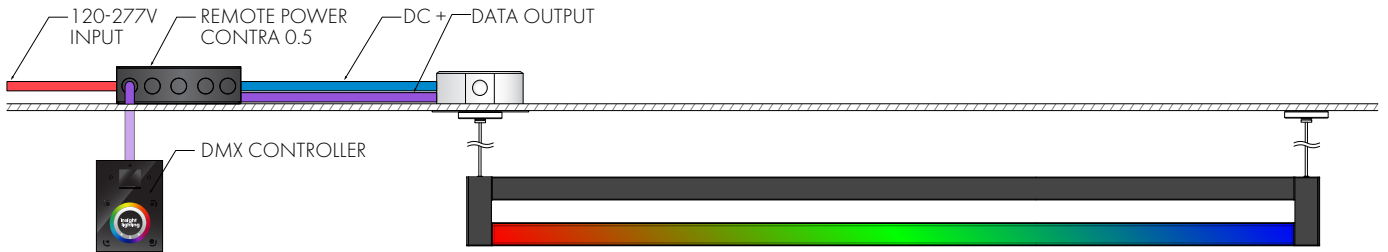

**REMOTE POWER CONTRA C1.0 - DUAL CIRCUIT 0-10V DIM - SINGLE FIXTURE**

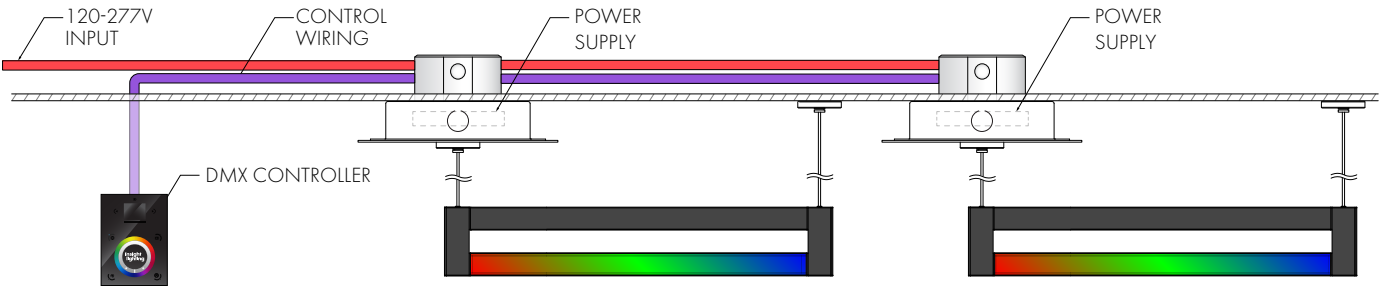

**INTEGRAL POWER CANOPY (ISJ) - CONTINUOUS RUN**

