

# INGROUND180 short (Model)



## TECHNICAL INFORMATION

[IES Files](#)

<b>Watt</b>	14W
<b>Luminaire</b>	Up to 1400lm
<b>CCT</b>	3000K – 4000K
<b>CRI</b>	>80
<b>Wiring</b>	120-277V 60Hz / 0-10V
<b>LED life time</b>	> 60000h - L80 - B20 (Ta 25°C)
<b>Color</b>	Stainless Steel - 30

## DESCRIPTION

### Construction

- Die-cast aluminium body (EN 47100).
- AISI 316L stainless steel trim.
- Double layer polyester powder paint resistant to corrosion and salt spray fog.
- Silicone rubber gaskets.
- AISI 316 stainless steel external screws.

### Electrical & Optics

- High-efficacy LEDs with standard 3000K, 4000K (2700K or other CCTs available on request).
- PMMA lenses for LEDs.
- Screen made of 13/32" thermal-shock resistant tempered glass.

### Listings

- UL certified to U.S. and Canadian standards, suitable for wet locations (cULus mark).
- Rated IP67 per EN60598.
- Luminaire rated for -30°C minimum ambient.
- 2000-3000Kg static load capacity per EN60598.
- Can be driven over at maximum speed 20Km/h per EN60598.

### Installation

- Recessed installation.
- Supplied with recessed installation box made of engineering plastic.
- Upon request fixtures can be supplied with anti-slip glass.

IP67



## VERSIONS *(Click on below link to configure your product)*



[round trim above the ground](#)

- Size:
- Ø 7" 23/32
  - 4" 13/16
  - 5" 5/16

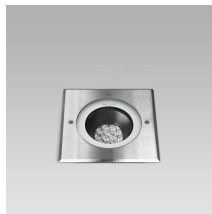

[squared trim above the ground](#)

- Size:
- 7" 23/32
  - 4" 13/16
  - 5" 5/16

## OPTICS



See accessories in the next page

## ANTI-SLIP OPAL GLASS.

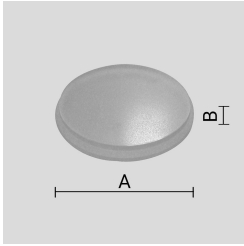
Arcluce Code **1099282X**Code Ref. **O7791**

## TECHNICAL INFORMATION

Weight	1.21 lb
--------	---------

---

## THERMOPLASTIC MATERIAL RECESSED INSTALLATION BOX.

Arcluce Code **1099208X**Code Ref. **O7795**

## TECHNICAL INFORMATION

Weight	0.44 lb
--------	---------

---

## PAINTED STEEL GLARE-CONTROL LOUVRED.

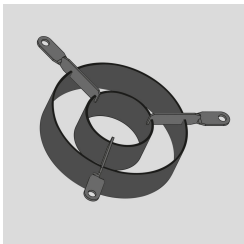
Arcluce Code **1099324X**Code Ref. **O7796**

## TECHNICAL INFORMATION

Weight	1.32 lb
--------	---------

---