



6" LED Downlight LC6SLPH

POWERHUBB™
PoE LIGHTING & CONTROL Enabled
1000/1400/1800 Lumens

APPLICATIONS:

LiteFrame Commercial LC6SL is a 6" commercial grade LED downlight with available outputs between 1000-1800 lumens. PowerHUBB™ enables Hubbell Lighting's portfolio of commercial, industrial and architectural luminaires to further reduce energy consumption and total cost of ownership for simple to complex Power over Ethernet environments. Rated for a minimum of 50,000 hours life (70% lumen maintenance) with ambient plenum temperatures up to 35°C (10L), 28°C (14L), 25°C (18L). Free Air Flow around the fixture is required for optimal life performance. This product is not recommended for use with 3rd party "FIREHAT" or insulation barriers.

HOUSING:

One-piece 22 gauge non-corrosive steel platform. Pre-wired J-box with snap-on cover for easy access. Snap-in connection from driver compartment allows easy installation of light engine/trim assembly and can be upgraded to accommodate technology improvements. Approved for 8 (4 in/4 out) No. 12 AWG conductors rated for 90°C through wiring.

REFLECTOR:

High purity aluminum, Alzak, iridescence suppressed, semi-diffuse reflector. Self-trim standard. Painted white self-trim (WT) available as option.

LED LIGHT ENGINE:

The LC6SL uses mid power Nichia LEDs, specifically mixed to provide a minimum of 80 CRI with 3 SDCM color consistency. The use of multiple mid power LEDs allows for optimal thermal management by effectively spreading the heat over a larger area and eliminating hot spots on the LEDs. A diffuse, yet highly transmissive lens obscures the view of the LEDs and creates a smooth, even look from below. The light engine is available in multiple Kelvin temperatures and the system is designed to provide optimal life and lumen maintenance (50,000 hours at 70% lumen maintenance). The reflector/light engine assembly is mechanically retained to the housing.

POWERHUBB™:

Hubbell Control Solutions' PowerHUBB™ is an enterprise-level Power over Ethernet (PoE) lighting and control platform that seamlessly integrates luminaires, sensors, user interfaces and software for a scalable intelligent building control solution. PowerHUBB™ PoE Lighting and Control options provide low-voltage wired connectivity for Power over Ethernet network system deployment.

DIMMING:

Dimming to 1% standard. See the PowerHUBB technical sheet for more details.

INSTALLATION:

Light commercial bar hangers included. Universal adjustable mounting brackets also accept 1/2" EMT conduit or 1 1/2" or 3/4" lathing channel (by others) or Prescolite 24" bar hangers (B24 or B6). Wall wash orientation may be field adjusted in 90° increments to housing.

CERTIFICATIONS:

CSA certified to US and Canadian safety standards. Suitable for wet locations (WW damp location). This product qualifies as a "designated country construction material" per FAR 52.225-11 Buy American-Construction. Materials under Trade Agreements effective 6/10/2020. See [Buy American Solutions](#).

WARRANTY:

5 year warranty. See [www.prescolite.com](#) for details.

DATE: _____ TYPE: _____

FIRM NAME: _____

PROJECT: _____

LiteFrame®



Ceiling Cutout: 6 1/4"
Maximum Ceiling Thickness 1 1/4"
For conversion to millimeters,
multiply inches by 25.4
Not to Scale

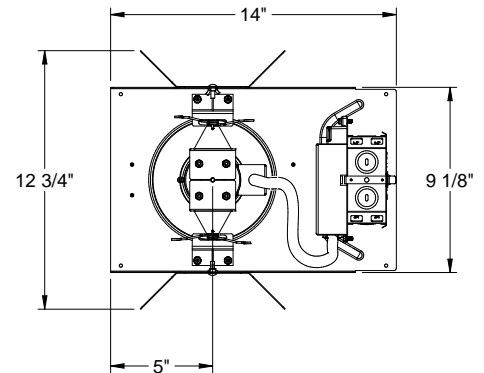
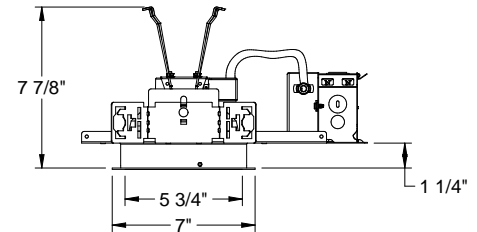

Order housing, reflector, and accessories separately

CATALOG NUMBER:

EXAMPLE: LC6SLPHPM-6LCSL14L35K9WT

HOUSING		POWERHUBB™ NODE	TRIM APERTURE	OUTPUT	KELVIN	CRI	REF. FINISH/ COLOR OPTION	REFLECTOR OPTIONS	ACCESSORIES
<input type="checkbox"/>	LC6SLPH Standard Lumen PowerHUBB™ Enabled	<input type="checkbox"/> PM PowerHUBB™, On/ Off/1% Dim, Master	<input type="checkbox"/> 6LCSL Standard Lumen Clear Alzak Reflector	<input type="checkbox"/> 10L 1000 Lumen	<input type="checkbox"/> 27K 2700 Kelvin	<input type="checkbox"/> 8 80+ CRI	<input type="checkbox"/> WH Painted Matte White Reflector and Flange	<input type="checkbox"/> WT Painted White Flange Only	<input type="checkbox"/> B24 Set of two(2) 24" bar hangers for T-bar ceilings
		<input type="checkbox"/> PMC PowerHUBB™, On/ Off/1% Dim, Control Inputs, Master		<input type="checkbox"/> 14L 1400 Lumen	<input type="checkbox"/> 30K 3000 Kelvin	<input type="checkbox"/> 9 90+ CRI		<input type="checkbox"/> WF Wide Flange	<input type="checkbox"/> B6 Set of two (2) bar hangers for ceiling joist up to 24" centers
		<input type="checkbox"/> PS PowerHUBB™, On/ Off/1% Dim, Satellite		<input type="checkbox"/> 18L 1800 Lumen	<input type="checkbox"/> 35K 3500 Kelvin			<input type="checkbox"/> WW ¹ Wall Wash	<input type="checkbox"/> SCA6D Sloped ceiling adapter (see note on page 3)
		<input type="checkbox"/> PSC PowerHUBB™, On/ Off/1% Dim, Control Inputs, Satellite			<input type="checkbox"/> 40K 4000 Kelvin			<input type="checkbox"/> IP65 ² Flush Lens, IP65/66 rated	
					<input type="checkbox"/> 50K 5000 Kelvin			<input type="checkbox"/> VR ² Vandal Resistant Flush Lens, IP65/66 rated	

¹ Damp location only

² IP65 and VR cannot be chosen together, not compatible with WT or WF.



In a continuing effort to offer the best product possible we reserve the right to change, without notice, specifications or materials that in our opinion will not alter the function of the product.
Web: [www.prescolite.com](#) • Tech Support: (888) 777-4832

LFR-LED-059

PHOTOMETRIC DATA

LiteFrame - 6" LC6SLPH Downlight

ELECTRICAL DATA	6LCSL10Lxxx	6LCSL14Lxxx	6LCSL18Lxxx
Input Power	14W	19W	23W
Constant Current Output	700mA	700mA	700mA
EMI Filtering	FCC 47CFR Part 15, Class A	FCC 47CFR Part 15, Class A	FCC 47CFR Part 15, Class A
Operating Temperature	0°C to +35°C	0°C to +28°C	0°C to +25°C
Dimming	1%	1%	1%
Over-voltage, over-current, short-circuit protected			

Lumen Multiplier Table

Photometrics for the LC6 are published below at a nominal 3500 Kelvin temperature. This table may be used to approximate the lumen values at different Kelvin temperatures. Power consumption would stay the same.

5000 Kelvin	1.09
4000 Kelvin	1.00
3500 Kelvin	1.00
3000 Kelvin	0.99
2700 Kelvin	0.96

LC6SLPHPM-6LCSL18L35K8

LED Light Engine: 3500K, 80+ CRI
System Wattage: 23W
Fixture Delivered Lumens: 1941
Fixture Efficacy: 84.4
Spacing Criteria: 1.1

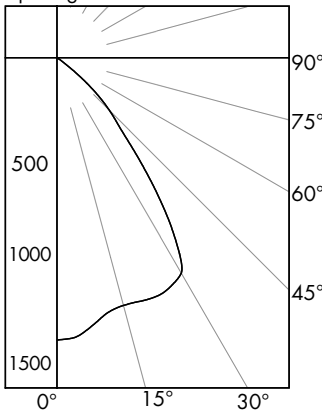

CANDELA DISTRIBUTION

DEG	CANDELA
0	1368
5	1345
15	1243
25	1247
35	923
45	357
55	27
65	5
75	1
85	0
90	0

ZONAL LUMEN SUMMARY

ZONE	LUMENS	%LUMINAIRE
0-60	1935	99.7
0-90	1941	100.0
90-180	0	0.0
0-180	1941	100.0

LUMINANCE DATA IN CANDELA/SQ. METER

Angle in Vertical	Average
45°	27667
55°	2580
65°	648
75°	212
85°	0

COEFFICIENTS OF UTILIZATION Zonal Cavity Method

Room Cavity Ratio	% Effective Ceiling Cavity Reflectance																							
	80%				70%				50%				30%				10%							
	70	50	30	10	70	50	30	10	50	30	10	50	30	10	50	30	10							
20% Effective Floor Cavity Reflectance													% Wall Reflectance											
1	113	110	107	105	110	108	105	103	104	102	100	100	98	97	96	95	94							
2	106	101	97	93	104	99	95	92	96	93	90	93	90	88	90	88	86							
3	100	93	87	83	98	92	86	82	89	85	81	86	83	80	84	81	78							
4	94	86	79	75	92	84	79	74	82	77	73	80	76	72	78	75	72							
5	89	79	73	68	87	78	72	67	76	71	67	74	70	66	73	69	66							
6	83	73	66	62	82	72	66	61	71	65	61	69	64	60	68	63	60							
7	78	68	61	56	77	67	61	56	66	60	56	64	59	55	63	59	55							
8	74	63	56	52	72	62	56	52	61	55	51	60	55	51	59	54	51							
9	70	59	52	48	68	58	52	48	57	51	47	56	51	47	55	51	47							
10	66	55	48	44	65	54	48	44	54	48	44	53	47	44	52	47	44							

LC6SLPHPM-6LCSL18L35K8

Test No. R16.03178-01

Test No. R16.03178-01

Tested at 25°C Ambient in accordance to IESNA LM-79-2008

LC6SLPHPM-6LCSL14L35K8

LED Light Engine: 3500K, 80+ CRI
System Wattage: 19W
Fixture Delivered Lumens: 1520
Fixture Efficacy: 80.0
Spacing Criteria: 1.1

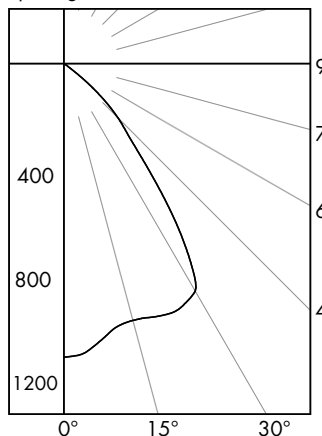

CANDELA DISTRIBUTION

DEG	CANDELA
0	1072
5	1050
15	971
25	990
35	721
45	277
55	20
65	4
75	1
85	0
90	0

ZONAL LUMEN SUMMARY

ZONE	LUMENS	%LUMINAIRE
0-60	1515	99.7
0-90	1520	100.0
90-180	0	0.0
0-180	1520	100.0

LUMINANCE DATA IN CANDELA/SQ. METER

Angle in Vertical	Average
45°	21467
55°	1911
65°	519
75°	212
85°	0

COEFFICIENTS OF UTILIZATION Zonal Cavity Method

Room Cavity Ratio	% Effective Ceiling Cavity Reflectance																							
	80%				70%				50%				30%				10%							
	70	50	30	10	70	50	30	10	50	30	10	50	30	10	50	30	10							
20% Effective Floor Cavity Reflectance													% Wall Reflectance											
1	113	110	107	105	110	108	105	103	104	102	100	100	98	97	96	95	94							
2	106	101	97	93	104	99	95	92	96	93	90	93	90	88	90	88	86							
3	100	93	87	83	98	92	86	82	89	85	81	86	83	80	84	81	78							
4	94	86	80	75	92	85	79	74	82	77	73	80	76	73	78	75	72							
5	89	79	73	68	87	78	72	67	76	71	67	74	70	66	73	69	66							
6	83	73	66	62	82	72	66	61	71	65	61	69	64	60	68	64	60							
7	78	68	61	56	77	67	61	56	66	60	56	65	59	55	63	59	55							
8	74	63	56	52	72	62	56	52	61	55	51	60	55	51	59	54	51							
9	70	59	52	48	68	58	52	48	57	51	47	56	51	47	55	51	47							
10	66	55	48	44	65	54	48	44	54	48	44	53	47	44	52	47	44							

LC6SLPHPM-6LCSL14L35K8

Test No. R16.03177-01

Test No. R16.03177-01

Tested at 25°C Ambient in accordance to IESNA LM-79-2008



Web: www.prescolite.com • Tech Support: (888) 777-4832
701 Millennium Boulevard • Greenville, SC 29607 U.S.A. • Phone (864) 678-1000
Copyright ©2018 Prescolite, Inc., a division of Hubbell Lighting, Inc. All Rights Reserved
Specifications subject to change without notice. • Printed in U.S.A. • IFRLED-059 • 01/11/21



PHOTOMETRIC DATA

LiteFrame - 6" LC6SLPH Downlight

LC6SLPHPM-6LCSL10L35K8

LED Light Engine: 3500K, 80+ CRI
 System Wattage: 14W
 Fixture Delivered Lumens: 1106
 Fixture Efficacy: 79.0
 Spacing Criteria: 1.1

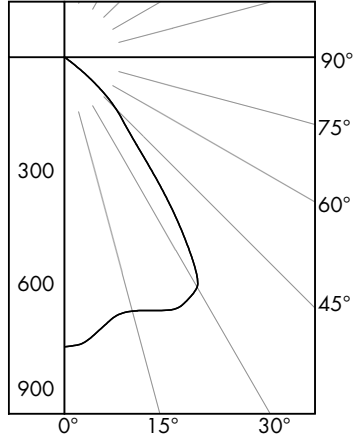

CANDELA DISTRIBUTION

DEG	CANDELA
0	780
5	762
15	708
25	740
35	518
45	196
55	15
65	3
75	1
85	0
90	0

ZONAL LUMEN SUMMARY

ZONE	LUMENS	%LUMINAIRE
0-60	1103	99.7
0-90	1106	100.0
90-180	0	0.0
0-180	1106	100.0

LUMINANCE DATA IN CANDELA/SQ. METER

Angle in Vertical	Average
45°	15190
55°	1433
65°	389
75°	212
85°	0

COEFFICIENTS OF UTILIZATION Zonal Cavity Method

Room Cavity Ratio	% Effective Ceiling Cavity Reflectance																
	80%			70%			50%			30%			10%				
	20% Effective Floor Cavity Reflectance																
	% Wall Reflectance																
	70	50	30	10	70	50	30	10	50	30	10	50	30	10			
1	113	110	107	105	110	108	105	103	104	102	100	100	98	97	96	95	94
2	107	101	97	93	104	99	95	92	96	93	90	93	90	88	90	88	86
3	100	93	88	83	98	92	87	82	89	85	81	86	83	80	84	81	79
4	94	86	80	75	92	85	79	74	82	77	74	80	76	73	78	75	72
5	89	79	73	68	87	78	72	68	76	71	67	75	70	66	73	69	66
6	83	73	67	62	82	73	66	62	71	65	61	69	65	61	68	64	60
7	78	68	61	57	77	67	61	56	66	60	56	65	60	56	64	59	55
8	74	63	57	52	73	63	56	52	61	56	52	60	55	51	59	55	51
9	70	59	52	48	69	58	52	48	57	52	48	57	51	47	56	51	47
10	66	55	49	44	65	55	48	44	54	48	44	53	48	44	52	47	44

LC6SLPHPM-6LCSL10L35K8

Test No. R16.03179-01

Test No. R16.03179-01

Tested at 25°C Ambient in accordance to IESNA LM-79-2008

LC6SLPHPM-6LCSL18L35K8 WW

LED Light Engine: 3500K, 80+ CRI
 System Wattage: 23W
 Fixture Delivered Lumens: 1938
 Fixture Efficacy: 84.3

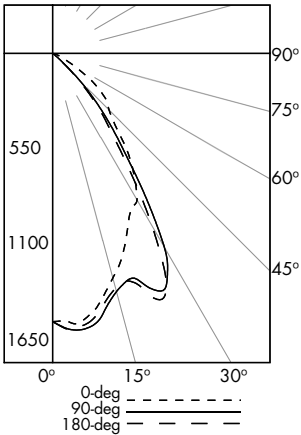

CANDELA DISTRIBUTION

DEG	0	90	180
0	1527	1527	1527
5	1545	1581	1565
15	1324	1404	1383
25	1030	1489	1517
35	792	780	670
45	454	219	189
55	273	8	8
65	64	2	2
75	9	1	1
85	0	0	0
90	0	0	0

LUMINANCE DATA IN CANDELA/SQ. METER

Angle in Vertical	0 DEG	90 DEG	180 DEG
45°	38311	18480	15949
55°	28400	832	832
65°	9036	282	282
75°	2075	231	231
85°	0	0	0



2' DISTANCE FIXTURE MOUNTED OUT FROM WALLS FOOTCANDLE DISTRIBUTION ON WALL SURFACE (DIRECT ONLY)

DISTANCE FROM CEILING IN FEET	1'				2'				3' CENTER				4' CENTER			
	15	11	6	2	1	15	5	15	15	1	15	15	15	1	15	15
1	40	36	26	13	5	41	27	41	40	10	40	40	40	40	40	40
2	36	35	28	18	11	41	36	41	36	22	36	36	36	36	36	36
3	22	22	22	19	13	33	39	33	25	27	25	25	25	25	25	25
4	14	14	14	14	13	27	30	27	20	25	20	20	20	20	20	20
5	10	10	9	9	9	24	22	24	16	19	16	16	16	16	16	16
6	7	7	6	6	6	19	18	19	14	14	14	14	14	14	14	14
7	5	5	5	4	4	15	15	15	12	11	12	12	12	12	12	12
8	4	4	3	3	3	12	13	12	10	9	10	10	10	10	10	10

LC6SLPHPM-6LCSL18L35K8 WW

Test No. R16.03309-01

Test No. R16.03309-01

Tested at 25°C Ambient in accordance to IESNA LM-79-2008

PowerHUBB™ POWERHUBB™

Hubbell Control Solutions' PowerHUBB™ is an enterprise-level Power over Ethernet (PoE) lighting and control platform that seamlessly integrates luminaires, sensors, user interfaces and software for a scalable intelligent building control solution.

See separate [PowerHUBB™ In-Fixture Solutions Guide](#) and [Hubbell Control Solutions PowerHUBB Brochure](#) for more details.

SCA8D

When ordering a sloped ceiling adapter, specify the degree of slope in 1° increments, maximum of 35°. For a more precise degree or wet ceiling applications, please contact factory. Sloped ceiling adapter and housing must be installed at the same time.



Web: www.prescolite.com • Tech Support: (888) 777-4832
 701 Millennium Boulevard • Greenville, SC 29607 U.S.A. • Phone (864) 678-1000
 Copyright ©2018 Prescolite, Inc., a division of Hubbell Lighting, Inc. All Rights Reserved
 Specifications subject to change without notice. • Printed in U.S.A. • LFR-LED-059 • 01/11/21

