

LTR-3RD (SH)

LITEISTRY 3" ROUND NON-CONDUCTIVE SHOWER DOWNLIGHT

LITEISTRY™

FEATURES

- 3" architectural LED downlight delivering 600–1500 lm
- Non-conductive dead-front trim
- Available with four regressed lens options
- Suitable for wet locations, covered ceiling
- IP65 rated (room side)
- Anti-microbial finish, optional
- 2700K - 5000K, 80+ and 90+ CRI options
- For New Construction (non-IC) applications
- Variety of dimming protocol options including 0-10V, DALI, DMX, Lutron Forward Phase and EcoSystem



RELATED PRODUCTS

- [Ø 3" LITEISTRY Family](#)
- [Ø 4" LITEISTRY Family](#)
- [Ø 6" LITEISTRY Family](#)

CONTROL TECHNOLOGY



SPECIFICATIONS

CONSTRUCTION

- New Construction (non-IC) applications
- Painted black durable steel platform with pre-installed bar hangers
- Pre-wired junction box with snap-on covers for easy access
- Snap-in connection from driver compartment allows easy installation
- Light Engine connections use plenum rated (CMP) cable

OPTICS

- Durable, non-conductive trim with 1/2" regressed lens
- Lens options include acrylic, polycarbonate, or tempered glass micro-prism, and clear acrylic
- Smooth room side lens surface for easy wipe down
- Available in white, black, or anti-microbial white trim color

ELECTRICAL

- Chip-on-board LED with 2 SDCM
- Multiple CCTs, 80+ or 90+ CRI
- Long LED life: L90 at >55,000 hours (TM-21)
- Universal voltage 120V–277V driver, 347V optional
- UL Class 2, inherent short circuit and overload protection, RoHS compliant
- Flicker free 0-10V dimming with 1% or <1% performance
- DALI, DMX, and Lutron Forward Phase and EcoSystem options
- NX or Lutron Vive control options available
- Remote emergency controller and battery pack option available

INSTALLATION

- Accommodates ceiling thickness up to 2"
- Universal adjustable mounting brackets also accept 0.5" EMT conduit or 1.5" or 0.75" lathing channel (by others) or Prescolite accessory bar hangers (B24 or B6)
- Light Engine serviceable above or below ceiling. Top access required for driver, Controls, EMR, GTD, or DTS component replacement.

CERTIFICATIONS

- cCSAus certified to UL 1598
- IP65 rated (room side) when properly installed per installation instructions
- Suitable for wet locations, covered ceiling. EMR: Suitable for damp locations.
- EMR: Certified under UL 924 standard for emergency lighting and power equipment
- Approved for 8 (4 in/4 out) No. 12AWG conductors rated for 90° through wiring

WARRANTY

- 5 year warranty
- See [HLI Standard Warranty](#) for additional information

KEY DATA	
Lumen Range	600-1500
Wattage Range	8-19
Efficacy Range (LPW)	33-35*
Reported Life (Hours)	L90 / >55,000
Input Current (mA)	67-158 (120V)

*Based on 35K, 80 CRI



LTR-3RD

LITEISTRY 3" ROUND NON-CONDUCTIVE SHOWER DOWNLIGHT

DATE: _____ LOCATION: _____
 TYPE: _____ PROJECT: _____
 CATALOG #: _____

ORDERING GUIDE

Example: LTR-3RD-H-SL10L-DM1-LTR-3RD-T-SHSL35K8-WTAML

CATALOG #

HOUSING

LTR-3RD-H		Lumen Package		Lumen Output		Driver Options		Control Options		Voltage		Housing Options									
Aperture/Shape/Function		Lumen Package		Lumen Output		Driver Options		Control Options		Voltage		Housing Options									
LTR-3RD-H	3" Round Downlight New Construction Housing	SL	Standard Lumen	06L	600	DM1	0-10V Dimming to 1%	NXE	NX Enabled, Dual SmartPorts ³	Standard	120-277V	EMR	Emergency Battery Pack with remote test switch and indicator light ⁶								
				10L	1000									DM01	0-10V Dimming to < 1%	NXWE	NX Wireless Enabled ³	34	347V ⁵	DTS	Device Transfer Switch with Dimming Bypass ^{6,7}
				15L	1500									DMX	DMX with RDM dimming to < 0.1% ²						
				2DM	Lutron Hi-Lume 2-wire Dimming to 1% (120V Forward Phase only) ²	LV	Lutron Vive Enabled, 0-10V (requires 0-10V driver)	F	Fuse ⁶												
				EDM	Lutron Hi-Lume EcoSystem Dimming to 1% ²					LVE	Lutron Vive Enabled, EcoSystem, (requires EDM)										

TRIM

LTR-3RD-T		Trim Style		Lumen Package		CCT		CRI	
Aperture/Shape/Function		Trim Style		Lumen Package		CCT		CRI	
LTR-3RD-T	3" Round Downlight Light Engine/Trim Assembly	SH	Non-Conductive Shower Trim	SL	Standard Lumen	27K	2700K	8	80+CRI
						30K	3000K	9	90+CRI
						35K	3500K		
						40K	4000K		
						50K	5000K ¹		

TRIM CONTINUED

Trim Color		Lens Options		Options	
WT	White Trim and Flange	AML	Acrylic, Micro-prism	AM	Antimicrobial ⁴
BT	Black Trim and Flange	PML	Polycarbonate, Micro-prism		
		GML	Tempered glass, Micro-prism		
		ACL	Acrylic, Clear		

Accessories

- B24** Set of two (2) 24" bar hangers for T-bar ceilings
- B6** Set of two bar hangers for ceiling joist up to 24" centers
- LiteGear** LiteGear® Inverter, 125VA–250VA
- LPS Series** LightPower Micro-Inverter, 20VA–55VA

Notes:

- 1 5000K available in 80+ CRI only.
- 2 2DM, EDM, DMX available in 10L-15L.
- 3 NX requires DM1 driver option.
- 4 AM available with White (WT) only. Consult factory for other colors.
- 5 347V requires DM1 driver option; not available in 06L or with Controls, F, DTS, GTD, EMR.
- 6 Housing options (except Fuse) not available in combination.
- 7 DTS available with DM1, DM01, DALI, or EDM; not available with LVE.



LTR-3RD

LITEISTRY 3" ROUND NON-CONDUCTIVE SHOWER DOWNLIGHT

DATE:	LOCATION:
TYPE:	PROJECT:
CATALOG #:	

CONTROLS

NX Distributed Intelligence™ Lighting Controls:

Supports applications in a variety of deployment options- wired, wireless, hybrid. Integrates with and enables a wide array of luminaires including those with SpectraSync™ Color Tuning Technology.



NX INTEGRATED CONTROLS REFERENCE								
NX Option	Sensor	Networkable	Scheduling	Occupancy	Daylight Harvesting	0-10V Dimming	On/off Control	Bluetooth® App Programming
NX Networked – Wired								
NXE	N/A	Yes	Yes	No	No	Yes	Yes	Requires NXBTC/R ¹
NX Networked – Wireless								
NXWE ²	N/A	Yes	Yes	No	No	Yes	Yes	No ³
NX Networked – Wired/Wireless								
NXWD	N/A	Yes	Yes	No	No	Yes	Yes	Requires NXBTC/R ^{1,3}

- 1 NXBTC/R needs to be plugged into an available NX SmartPort™ on the fixture network
- 2 Programming via App requires factory assistance
- 3 To program NXWE option, need to consult factory. If connected to an area controller, programming can be done from that

PERFORMANCE DATA TABLE

Performance data provided below is for 3500K, 80 CRI.

Lumen Package	Nominal Lumens	Lens Description	Delivered Lumens	Watts	LPW
06L	600	Acrylic Micro-prism	259	7.8	33
		Polycarbonate Micro-prism	248	7.8	32
		Tempered Glass Micro-prism	258	7.8	33
		Acrylic Clear	258	7.8	33
10L	1000	Acrylic Micro-prism	416	12.0	35
		Polycarbonate Micro-prism	399	12.0	33
		Tempered Glass Micro-prism	415	12.0	35
		Acrylic Clear	415	12.0	35
15L	1500	Acrylic Micro-prism	602	17.4	35
		Polycarbonate Micro-prism	578	17.4	33
		Tempered Glass Micro-prism	601	17.4	35
		Acrylic Clear	600	17.4	34

LTR-3RD

LITEISTRY 3" ROUND NON-CONDUCTIVE SHOWER DOWNLIGHT

DATE: _____ LOCATION: _____

TYPE: _____ PROJECT: _____

CATALOG #: _____

DIMENSIONS

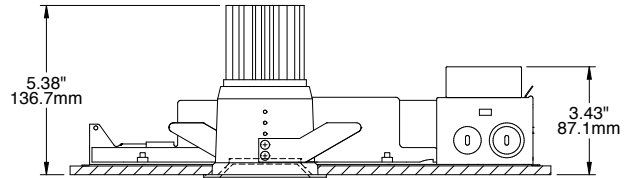
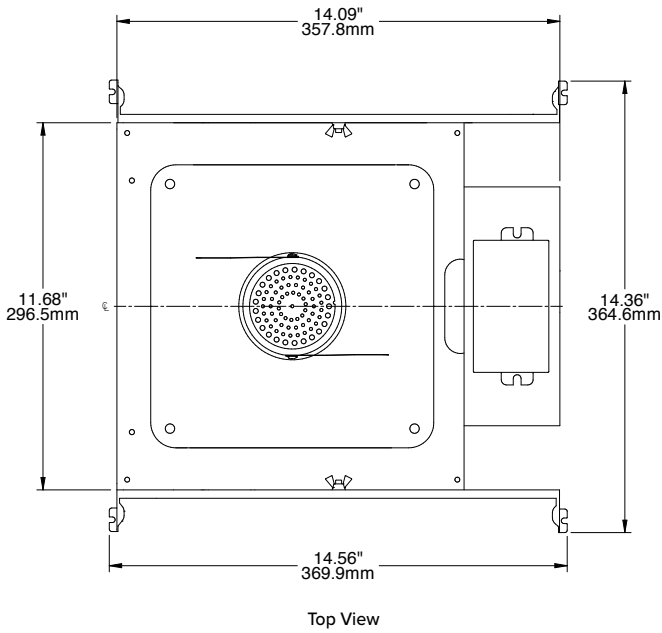

Dimensional Data		
Aperture		2.88" (73.2mm)
Flange	Standard	3.90" (99.1mm)
Ceiling Cutout	Standard	3.38" (85.9mm)
Ceiling Thickness		0.50" to 2.00" (12.7mm to 50.8mm)

LTR-3RD-H-SH

LTR-3RD

LITEISTRY 3" ROUND NON-CONDUCTIVE SHOWER DOWNLIGHT

PHOTOMETRY

LTR-3RD-H-SL15L-DM1 / LTR-3RD-T-SHSL35K8-WTAML

LUMINAIRE DATA

Test No.	20.01601
Description	1500 lm, Acrylic micro-prism lens, 3500K, 80 CRI
Delivered Lumens	602
Watts	17.4W
Efficacy	34.5
Mounting	Recessed
Spacing Criterion	0.7

ZONAL LUMEN SUMMARY

Zone	Lumens	% Luminaire
0-40	553	91.8
0-60	597	99.2
0-90	602	100.0
0-180	602	100.0

POLAR GRAPH

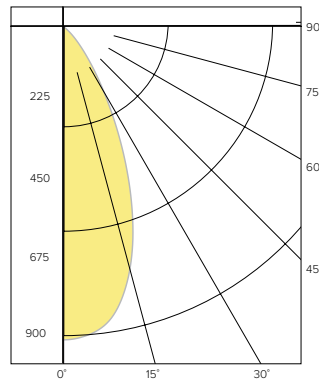

CANDELA DISTRIBUTION

Degree	Candela
0	913
5	899
15	725
25	389
35	144
45	42
55	10
65	4
75	1
85	0
90	0

LUMINANCE DATA*

Vertical Angle	Average
45°	15840
55°	4750
65°	2409
75°	560
85°	0

*Candela/Square Meter

LTR-3RD-H-SL15L-DM1 / LTR-3RD-T-SHSL35K8-WTPML

LUMINAIRE DATA

Test No.	20.01603
Description	1500 lm, Polycarbonate micro-prism lens, 3500K, 80 CRI
Delivered Lumens	578
Watts	17.4W
Efficacy	33.2
Mounting	Recessed
Spacing Criterion	0.7

ZONAL LUMEN SUMMARY

Zone	Lumens	% Luminaire
0-40	525	90.8
0-60	571	98.7
0-90	578	100.0
0-180	578	100.0

POLAR GRAPH

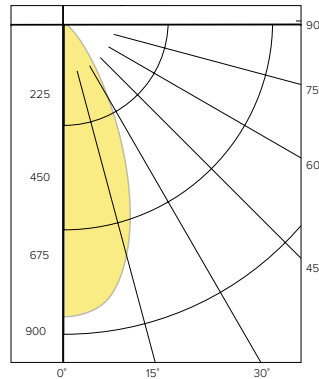

CANDELA DISTRIBUTION

Degree	Candela
0	856
5	844
15	683
25	371
35	139
45	43
55	12
65	5
75	2
85	0
90	0

LUMINANCE DATA*

Vertical Angle	Average
45°	16000
55°	5310
65°	3175
75°	1925
85°	663

*Candela/Square Meter

LTR-3RD-H-SL15L-DM1 / LTR-3RD-T-SHSL35K8-WTGML

LUMINAIRE DATA

Test No.	20.01604
Description	1500 lm, Tempered Glass micro-prism lens, 3500K, 80 CRI
Delivered Lumens	602
Watts	17.4W
Efficacy	34.5
Mounting	Recessed
Spacing Criterion	0.7

ZONAL LUMEN SUMMARY

Zone	Lumens	% Luminaire
0-40	546	90.7
0-60	594	98.7
0-90	602	100.0
0-180	602	100.0

POLAR GRAPH

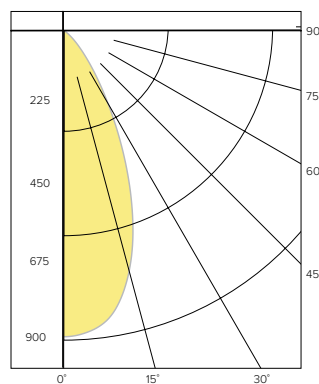

CANDELA DISTRIBUTION

Degree	Candela
0	887
5	872
15	707
25	387
35	147
45	46
55	12
65	5
75	2
85	0
90	0

LUMINANCE DATA*

Vertical Angle	Average
45°	16780
55°	5519
65°	3297
75°	1984
85°	684

*Candela/Square Meter

LTR-3RD

LITEISTRY 3" ROUND NON-CONDUCTIVE SHOWER DOWNLIGHT

PHOTOMETRY CONTINUED

LTR-3RD-H-SL15L-DM1 / LTR-3RD-T-SHSL35K8-WTACL

LUMINAIRE DATA

Test No.	20.01606
Description	1500 lm, Acrylic clear lens, 3500K, 80 CRI
Delivered Lumens	600
Watts	17.4W
Efficacy	34.4
Mounting	Recessed
Spacing Criterion	0.8

POLAR GRAPH

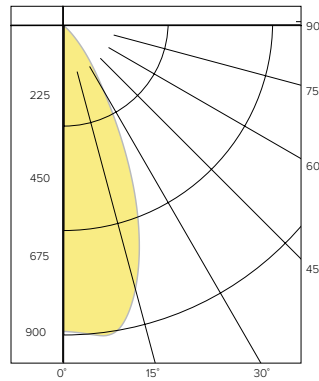

CANDELA DISTRIBUTION

Degree	Candela
0	889
5	902
15	894
25	404
35	132
45	28
55	5
65	3
75	2
85	0
90	0

LUMINANCE DATA*

Vertical Angle	Average
45°	10200
55°	2278
65°	1758
75°	1511
85°	380

*Candela/Square Meter

ZONAL LUMEN SUMMARY

Zone	Lumens	% Luminaire
0-40	568	94.6
0-60	596	99.3
0-90	600	100.0
0-180	600	100.0

LUMEN MULTIPLIER

Option	27K8	30K8	35K8	40K8	50K8	27K9	30K9	35K9	40K9
Multiplier	0.94	0.98	1.00	1.01	1.02	0.81	0.84	0.85	0.85

Photometrics are published below at a nominal 3500 Kelvin, 80+ CRI. This table may be used to approximate the lumen values at different Kelvin temperatures. Power consumption would stay the same.

TM-30 DATA

COLOR VECTOR GRAPHIC 3500K, 90 CRI

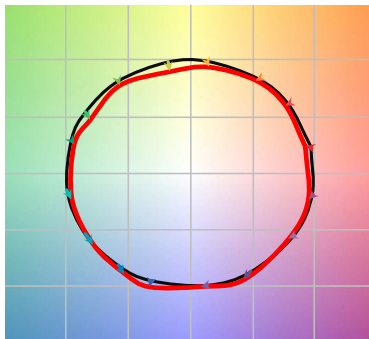

— Reference Illuminant — Test Source

COLOR DISTORTION GRAPHIC 3500K, 90 CRI



TEST RESULTS - 3500K		
Value	80+ CRI	90+ CRI
R _t	84	88
R _g	95	95
CCT (K)	3411	3419
D _{uv}	0.0015	0.0042
x	0.4120	0.4147
y	0.3974	0.4052
CIE R _a	84	93
CIE R _g	11	62

COLOR VECTOR GRAPHIC 3500K, 80 CRI

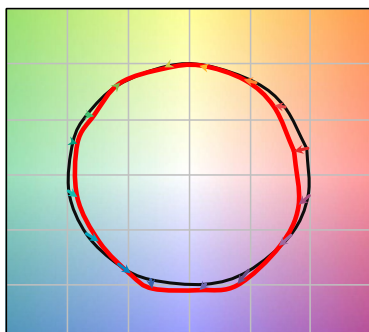

— Reference Illuminant — Test Source

COLOR DISTORTION GRAPHIC 3500K, 80 CRI

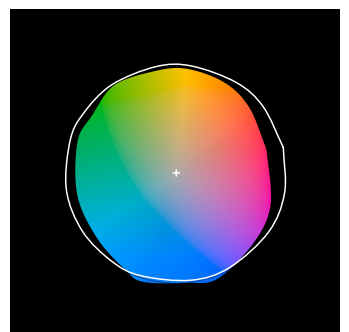



LTR-3RD

LITEISTRY 3" ROUND NON-CONDUCTIVE SHOWER DOWNLIGHT

DATE: _____ LOCATION: _____

TYPE: _____ PROJECT: _____

CATALOG #: _____

ELECTRICAL DATA

DRIVER DATA		
Input Voltage	120-277V	347V
Input Frequency	50/60 Hz	50/60 Hz
Power Factor	≥0.90	≥0.90
THD	<20%	<20%
EMI Filtering (FCC 47 CFR Part 15)	Class A	Class A

* Values for DM1 option shown, values for other dimming options may vary.

WATTAGE DATA		
Lumen Output	Nominal Lumens	Wattage
06L	600	8
10L	1000	12
15L	1500	19

* Wattage may vary based on configuration and options selected

ADDITIONAL INFORMATION

DIMMING COMPATIBILITY CHART		
Dimming Driver	Manufacturer	Web Link
DM1/DM01	Lutron DDTV	http://bit.ly/11jSvZg
DM1	Leviton AWRMG-7xx, AWSMG-7xx, AWSMT-7xx	http://bit.ly/1BjN2R9
EDM	Lutron	http://bit.ly/1vtjHAI
2DM	Lutron	http://bit.ly/1S4WjXK

DMX

See instruction sheet on www.prescolite.com for connection & installation information.

Central Inverters

For full fixture output in back-up mode, we recommend you visit www.dual-lite.com for your Central Lighting Inverter options. Please contact your local Hubbell representative for any assistance with proper sizing and loading of your inverter selection. Central lighting inverters must be ordered separately.

LiteGear: www.dual-lite.com/products/litegear_lg_series

LPS Series: www.dual-lite.com/products/lps