

# BULLETTO LINE

## Compact Adjustable Floodlight Projector

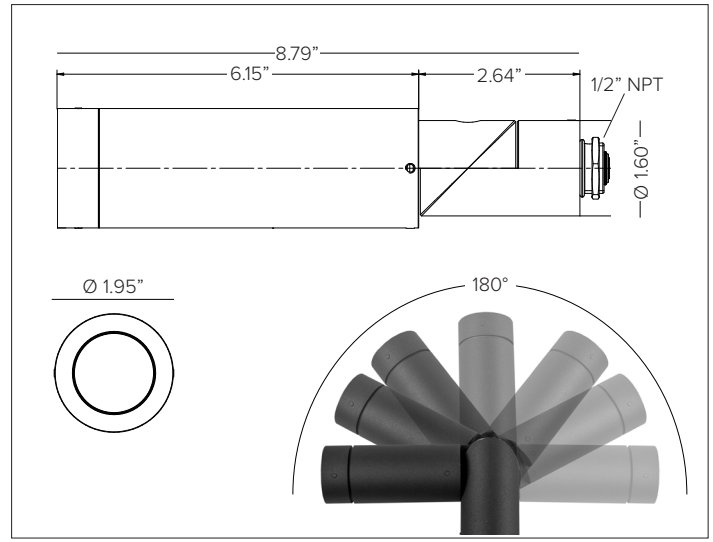

BULLETTO LINE shown in Ferrite Dark Grey finish.



### CONCEPT

Compact projector flood light for high intensity applications.

### MECHANICAL CHARACTERISTICS

<b>Housing</b>	1.95" W x 8.79"D
<b>Materials</b>	Aluminum body and joints for maximum heat dissipation.
<b>Finish</b>	Textured finish. ● Ferrite Dark Grey ● Heritage Brown ● Bronze ● Black ● White ● Sandstone Grey
<b>Power Connection</b>	Pre-cabled with 10' Belden direct burial 18-6 cable, optional 25ft length for pole mounting.
<b>Functionality</b>	Modular body for toolless maintenance. IP66 protection rated optical chamber with removable front cap for simple toolless field interchangeability of optics and accessories.
<b>Mounting</b>	Adjustable up to 180° on the vertical surface with aim lock set screw, 360° rotatable on the horizontal axis. Brass counter nut with 1/2" NPS mounting stem suitable for direct j-box mount. Optional installation accessories for additional mountings.
<b>Weight</b>	2lbs
<b>Protection</b>	IP66
<b>Impact</b>	IK08

### CERTIFICATIONS

cULus Wet Location Listed E479873.  
 Tested in accordance with LM-79-08.  
 Compliant for California installations.  
 IEC 62471  
 RoHS3 EU 215/863

### WARRANTY

5 year limited warranty  
 A Fixture suitable for use in marine grade environments. Not to be in direct contact with salt or corrosive agents for extended periods of time.

### SUSTAINABILITY

Luminaire designed for disposal/recycling at end-of-life. Replaceable LED light source and control gear by a Targetti technician.

### ELECTRICAL CHARACTERISTICS

<b>Power Supply</b>	Integral 4/1 smart driver (Non-Dimmable / 0-10V / Reverse Phase / Forward Phase).
<b>Wattage</b>	9W (NSP) / 17W (SP/FL/MFL/WFL)
<b>Voltage</b>	Universal Voltage 120-277V AC 50/60Hz

### SOURCE

High efficiency LED Emitter

TM30	CCT (Nominal)	CRI	Rf	Rg	SDCM
	2700K	90	88	95	2
	3000K	90	91	98	2
	3500K	90	89	96	2
	4000K	90	88	94	2

### OPTIC

Optical system is dependent on beam angle. NSP version PMMA lens and fixed holographic filter. SP / FL / MWFL / WFL versions equipped with PMMA lens and interchangeable optical holographic lens, factory preset per specified optic with other beams included in packaging.

Beam	NSP 9°	SP 16°	FL 25°	MWFL 3P	WFL 42°
<b>Delivered Lumens</b>	<b>2700K</b> 407Lm	1008Lm	979Lm	930Lm	764Lm
	<b>3000K</b> 430Lm	1085Lm	1054Lm	1001Lm	823Lm
	<b>3500K</b> 445Lm	1119Lm	1088Lm	1033Lm	849Lm
	<b>4000K</b> 460Lm	1153Lm	1120Lm	1063Lm	874Lm
<b>Efficacy</b>	70Lm/W max. Refer to photometric graphs for specific values.				
<b>Lifetime</b>	L96/B10 30,000hrs at max TA +25°C L95/B10 50,000hrs at max TA +25°C L94/B10 80,000hrs at max TA +25°C L93/B10 100,000hrs at max TA +25°C				

**Photobiological Classification** Low risk safety RG1

# BULLETO LINE

## SPECIFICATION INFORMATION



1 - PRODUCT CODE	2 - DRIVER	3 - FINISH	4 - WATTAGE	5 - OPTIC	6 - KELVIN
<b>BLL</b> — BULLETO LINE	<b>41</b> — 4/1 Smart Dimming (0-10V / Reverse Phase / Triac / Non-Dimming)	<b>FE</b> — Ferrite Dark Grey <b>HB</b> — Heritage Brown <b>BZ</b> — Bronze <b>WT</b> — White <b>BT</b> — Black <b>SG</b> — Sandstone Grey <b>RAL</b> — <a href="#">Custom RAL</a>	<b>L1</b> — 7W <b>L2</b> — 17W	<b>NS</b> — NSP 9° <b>SP</b> — SP 16° <b>FL</b> — FL 25° <b>MF</b> — MWFL 31° <b>WF</b> — WF 42°	<b>27</b> — 2700K <b>30</b> — 3000K <b>35</b> — 3500K <b>40</b> — 4000K

7 - OPTICAL ACCESSORIES	8 - INSTALLATION ACCESSORIES	9 - TREE INSTALLATION ACCESSORIES
<a href="#">Blade of Light Linear Spread Lens</a> See section for details <a href="#">Anti-glare Louver</a> See section for details <a href="#">Asymmetric Screen</a> See section for details <a href="#">Lumishape</a> See section for details	<a href="#">Surface Mount Bracket</a> See section for details <a href="#">Low Profile Surface Canopy</a> See section for details <a href="#">Earth Spike</a> See section for details	<a href="#">Tree Strap</a> See section for details <a href="#">Fixture Bracket</a> See section for details <a href="#">Wiring Connection Box</a> See section for details <a href="#">Mesh Protective Wiring</a> See section for details

## OPTIC DETAILS

*Fixed Optic (NSP)*



*Interchangeable Multi Optic (SP / FL / MWFL / WFL)  
 Factory preset per specified optic with other beams included in packaging.*



**BULLETTO LINE**

**8 – OPTICAL ACCESSORIES (OPTIONAL)**

MAXIMUM OF TWO ACCESSORIES PER FIXTURE.



Integral 'Blade of Light' linear spread lens PMMA holographic filter.

Part No. **1E3790**



Integral honeycomb anti-glare louver.

Finish ● Deep Black

Part No. **1E3792**

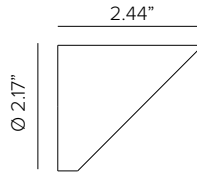
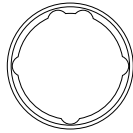
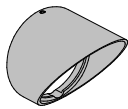

External asymmetric snoot. Powder coated stainless steel. Cutoff 20°.

Part No. **1E3788 (\*)**

- Ferrite Dark Grey (Default)
- Heritage Brown (HB)\*
- Bronze (BZ)\*
- White (WT)\*
- Black (BT)\*
- Sandstone Grey (SG)\*

**\*Add suffix to end of number to identify finish (EX. 1E3788HB)**



Water jet cut stainless steel round pinhole LUMISHAPE light shield. **Performs best with SP optic.**

Finish ● Deep Black

Part No. **LS03601**

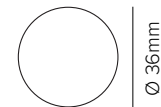

Water jet cut stainless steel round circular LUMISHAPE light shield. **Performs best with SP or FL optic.**

Finish ● Deep Black

Part No. **LS03602**



Water jet cut stainless steel square pinhole LUMISHAPE light shield. **Performs best with SP optic.**

Finish ● Deep Black

Part No. **LS03603**

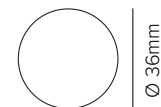
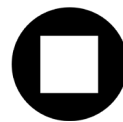

Water jet cut stainless steel regular square LUMISHAPE light shield. **Performs best with SP or FL optic.**

Finish ● Deep Black

Part No. **LS03604**

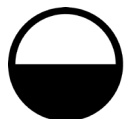

Water jet cut stainless steel half LUMISHAPE light shield. **Stackable up to 4pcs per fixture; 4pcs accounts to 1 accessory toward maximum accessory count. Performs best with FL or MFL optic**

Finish ● Deep Black

Part No. **LS03605**

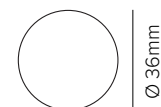

Water jet cut stainless steel quarter LUMISHAPE light shield. **Stackable up to 4pcs per fixture; 4pcs accounts to 1 accessory toward maximum accessory count. Performs best with FL or MFL optic**

Finish ● Deep Black

Part No. **LS03606**

**BULLETTO LINE**

**9 – INSTALLATION ACCESSORIES (OPTIONAL)**

MAXIMUM OF ONE ACCESSORY PER FIXTURE

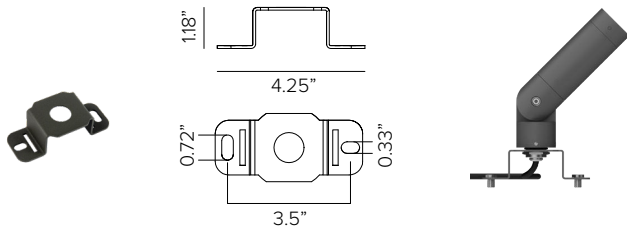

Surface mounting bracket. Powder coated stainless steel.

Part No. **1E3786** (\*)

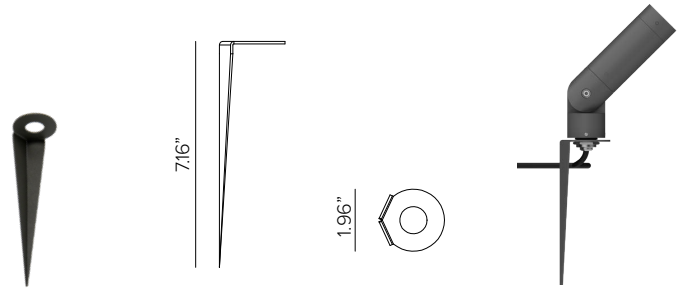

Earth spike. Powder coated stainless steel.

Part No. **1E3785** (\*)

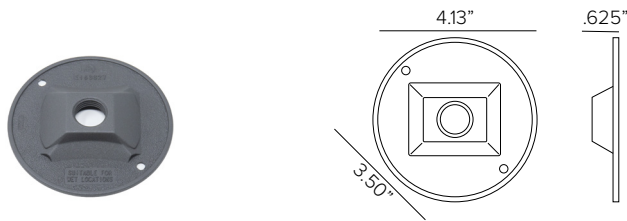

Low Profile surface canopy. Powder coated aluminum with 1/2" NPT to mount over standard 4" Dia. round outdoor j-box.

Part No. **1BLTSMCVR** (\*)

- Ferrite Dark Grey (*Default*)
- Heritage Brown (**HB**)\*
- Bronze (**BZ**)\*
- White (**WT**)\*
- Black (**BT**)\*
- Sandstone Grey (**SG**)\*

**\*Add suffix to end of number to identify finish (EX. 1E3786HB)**

# BULLETTO LINE

## 10 – TREE MOUNTING INSTALLATION (OPTIONAL)

### SINGLE STRAP FOR USE WITH OF UP TO 3 FIXTURES

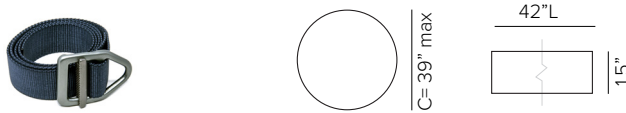

Single tree strap comprised of durable Nylon webbing flexible strap with high strength aircraft aluminum V-ring buckle in Gunmetal finish and lock-in loop to prevent slipping. **Strap is made to coordinate with up to 3 fixtures and 1 wiring connection box. Strap fits trees 39" max circumference or smaller. (REQUIRED)**

Finish ● Olive Green ● Coyote Brown ● Graphite Grey

Part No. **TTS0101** **TTS0102** **TTS0103**

### DOUBLE STRAP FOR USE WITH OF UP TO 8 FIXTURES

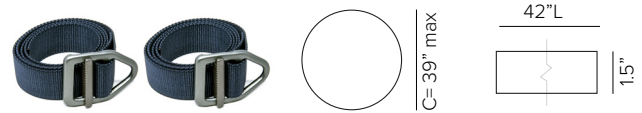

Durable 1.5 inch wide Nylon webbing Strap is flexible with High Strength Aircraft Aluminum V-ring Buckle in Gunmetal finish and lock in loop to prevent slipping. **Strap is made to coordinate with up to 8 fixtures and 2 wiring connection boxes. Strap fits trees 39" max circumference or smaller. (REQUIRED)**

Finish ● Ferrite Dark Grey ● Bronze ● Graphite Grey

Part No. **TTS0106** **TTS0104** **TTS0105**



Fixture bracket comprised of powder coated stainless steel for use with tree strap. **Maximum of 3 brackets can be per single strap. (REQUIRED)**

Finish ● Ferrite Dark Grey ● Bronze

Part No. **TTBLT0101** **TTBLT0102**



Fixture bracket comprised of powder coated stainless steel for use with tree strap. **Maximum of 3 brackets can be per double strap. (REQUIRED)**

Finish ● Ferrite Dark Grey ● Bronze

Part No. **TTBLT0201** **TTBLT0202**



Tree Strap Connection Box. Painted aluminum UL listed 9in<sup>3</sup> j-box with 3ea 3/8" cable glands and 1ea 1/2" cable gland. Mounting bracket for tree strap included. Used to connect multiple 24V DC low voltage cables for one continuous cable connection down the tree to remote driver, additional cable provided by others. **Can be used for up to 3 fixture connections per tree strap. (OPTIONAL)**

Finish ● Ferrite Dark Grey ● Bronze

Part No. **TTCB0103FG** **TTB0103BZ**



Tree Strap Connection Box. Painted aluminum UL listed 13in<sup>3</sup> j-box with 3ea 3/8" cable glands and 1ea 1/2" cable gland. Mounting bracket for tree strap included. Used to connect multiple 24V DC low voltage cables for one continuous cable connection down the tree to remote driver, additional cable provided by others. **Can be used for up to 5 fixture connections per tree strap. (OPTIONAL)**

Finish ● Ferrite Dark Grey ● Bronze

Part No. **TTCB0104FG** **TTB0104BZ**



Mesh wire protection cover sleeve comprised of braided polyethylene terephthalate (PET) monofilament webbing resistant to chemical degradation, UV radiation and abrasion. 3/8" SJO Cord Sleeve, available per foot. **(OPTIONAL)**

Finish ● Carbon Grey ● Brown ● Forest Green

Part No. **TTSJS01** **TTSJS02** **TTSJS03**



Mesh wire protection cover sleeve comprised of braided polyethylene terephthalate (PET) monofilament webbing resistant to chemical degradation, UV radiation and abrasion. 3/8" SJO Cord Sleeve, available per foot. **(OPTIONAL)**

Finish ● Carbon Grey ● Brown ● Forest Green

Part No. **TTSJS01** **TTSJS02** **TTSJS03**

### WIRING CONFIGURATION

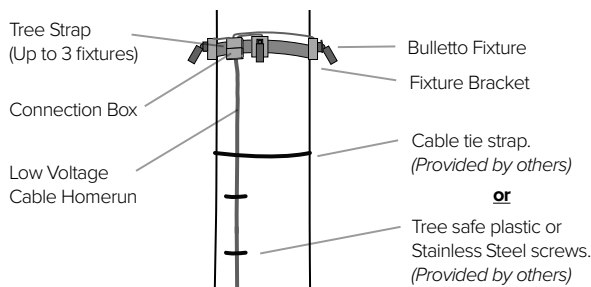

To be installed per local building code. Adjust the strap every 6 months in order to prevent tree damage.

### WIRING CONFIGURATION

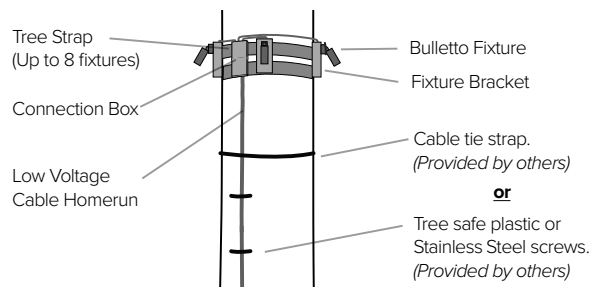

To be installed per local building code. Adjust the strap every 6 months in order to prevent tree damage.

# BULLETTO LINE

## PHOTOMETRY

### NARROW SPOT

	2700K	H(m)	D(m)	Emax(lx)		
	Ra90			9°		
	Fixture Power	7W	1	0.16	5550	
	Source Flux	500lm	2	0.31	1387	
	Fixture Flux	407lm	3	0.47	617	
	Efficacy	62lm/W	4	0.62	347	
A6338	Imax=11100cd/klm	Imax	5550cd	5	0.78	222

	3000K	H(m)	D(m)	Emax(lx)		
	Ra90			9°		
	Fixture Power	7W	1	0.16	5861	
	Source Flux	528lm	2	0.31	1465	
	Fixture Flux	430lm	3	0.47	651	
	Efficacy	65lm/W	4	0.62	366	
A6292	Imax=11100cd/klm	Imax	5861cd	5	0.78	234

	3500K	H(m)	D(m)	Emax(lx)		
	Ra90			9°		
	Fixture Power	7W	1	0.16	6072	
	Source Flux	547lm	2	0.31	1518	
	Fixture Flux	445lm	3	0.47	675	
	Efficacy	67lm/W	4	0.62	380	
A6339	Imax=11101cd/klm	Imax	6072cd	5	0.78	243

	4000K	H(m)	D(m)	Emax(lx)		
	Ra90			9°		
	Fixture Power	7W	1	0.16	6271	
	Source Flux	565lm	2	0.31	1568	
	Fixture Flux	460lm	3	0.47	697	
	Efficacy	70lm/W	4	0.62	392	
A6340	Imax=11099cd/klm	Imax	6271cd	5	0.78	251

### SPOT

	2700K	H(m)	D(m)	Emax(lx)		
	Ra90			16°		
	Fixture Power	17W	1	0.28	7804	
	Source Flux	1394lm	2	0.56	1951	
	Fixture Flux	1008lm	3	0.84	867	
	Efficacy	59lm/W	4	1.12	488	
A6341	Imax=5598cd/klm	Imax	7804cd	5	1.40	312

	3000K	H(m)	D(m)	Emax(lx)		
	Ra90			16°		
	Fixture Power	17W	1	0.28	8403	
	Source Flux	1501lm	2	0.56	2101	
	Fixture Flux	1085lm	3	0.84	934	
	Efficacy	64lm/W	4	1.12	525	
A6291	Imax=5598cd/klm	Imax	8403cd	5	1.40	336

	3500K	H(m)	D(m)	Emax(lx)		
	Ra90			16°		
	Fixture Power	17W	1	0.28	8666	
	Source Flux	1548lm	2	0.56	2166	
	Fixture Flux	1119lm	3	0.84	963	
	Efficacy	66lm/W	4	1.12	542	
A6342	Imax=5598cd/klm	Imax	8666cd	5	1.40	347

	4000K	H(m)	D(m)	Emax(lx)		
	Ra90			16°		
	Fixture Power	17W	1	0.28	8924	
	Source Flux	1594lm	2	0.56	2231	
	Fixture Flux	1153lm	3	0.84	992	
	Efficacy	68lm/W	4	1.12	558	
A6343	Imax=5598cd/klm	Imax	8924cd	5	1.40	357

### FLOOD

	2700K	H(m)	D(m)	Emax(lx)		
	Ra90			25°		
	Fixture Power	17W	1	0.45	3823	
	Source Flux	1394lm	2	0.90	956	
	Fixture Flux	979lm	3	1.35	425	
	Efficacy	58lm/W	4	1.80	239	
A6344	Imax=2742cd/klm	Imax	3823cd	5	2.25	153

	3000K	H(m)	D(m)	Emax(lx)		
	Ra90			25°		
	Fixture Power	17W	1	0.45	4116	
	Source Flux	1501lm	2	0.90	1029	
	Fixture Flux	1054lm	3	1.35	457	
	Efficacy	62lm/W	4	1.80	257	
A6288	Imax=2742cd/klm	Imax	4116cd	5	2.25	165

	3500K	H(m)	D(m)	Emax(lx)		
	Ra90			25°		
	Fixture Power	17W	1	0.45	4245	
	Source Flux	1548lm	2	0.90	1061	
	Fixture Flux	1088lm	3	1.35	472	
	Efficacy	64lm/W	4	1.80	265	
A6345	Imax=2742cd/klm	Imax	4245cd	5	2.25	170

	4000K	H(m)	D(m)	Emax(lx)		
	Ra90			25°		
	Fixture Power	17W	1	0.45	4371	
	Source Flux	1594lm	2	0.90	1093	
	Fixture Flux	1120lm	3	1.35	486	
	Efficacy	66lm/W	4	1.80	273	
A6346	Imax=2742cd/klm	Imax	4371cd	5	2.25	175

**BULLETTO LINE**

**PHOTOMETRY**

**MEDIUM WIDE FLOOD**

	2700K	H(m)	D(m)	Emax(lx)		
	Ra90			31°		
	Fixture Power	17W	1	0.55	2598	
	Source Flux	1394lm	2	1.11	650	
	Fixture Flux	930lm	3	1.66	289	
	Efficacy	55lm/W	4	2.21	162	
A6347	I <sub>max</sub> =1864cd/klm	I <sub>max</sub>	2598cd	5	2.76	104

	3000K	H(m)	D(m)	Emax(lx)		
	Ra90			31°		
	Fixture Power	17W	1	0.55	2798	
	Source Flux	1501lm	2	1.11	699	
	Fixture Flux	1001lm	3	1.66	311	
	Efficacy	59lm/W	4	2.21	175	
A6289	I <sub>max</sub> =1864cd/klm	I <sub>max</sub>	2798cd	5	2.76	112

	3500K	H(m)	D(m)	Emax(lx)		
	Ra90			31°		
	Fixture Power	17W	1	0.55	2885	
	Source Flux	1548lm	2	1.11	721	
	Fixture Flux	1033lm	3	1.66	321	
	Efficacy	61lm/W	4	2.21	180	
A6348	I <sub>max</sub> =1864cd/klm	I <sub>max</sub>	2885cd	5	2.76	115

	4000K	H(m)	D(m)	Emax(lx)		
	Ra90			31°		
	Fixture Power	17W	1	0.55	2971	
	Source Flux	1594lm	2	1.11	743	
	Fixture Flux	1063lm	3	1.66	330	
	Efficacy	63lm/W	4	2.21	186	
A6349	I <sub>max</sub> =1864cd/klm	I <sub>max</sub>	2971cd	5	2.76	119

**WIDE FLOOD**

	2700K	H(m)	D(m)	Emax(lx)		
	Ra90			42°		
	Fixture Power	17W	1	0.76	1233	
	Source Flux	1394lm	2	1.52	308	
	Fixture Flux	764lm	3	2.29	137	
	Efficacy	45lm/W	4	3.05	77	
A6350	I <sub>max</sub> =884cd/klm	I <sub>max</sub>	1233cd	5	3.81	49

	3000K	H(m)	D(m)	Emax(lx)		
	Ra90			42°		
	Fixture Power	17W	1	0.76	1328	
	Source Flux	1501lm	2	1.52	332	
	Fixture Flux	823lm	3	2.29	148	
	Efficacy	48lm/W	4	3.05	83	
A6290	I <sub>max</sub> =884cd/klm	I <sub>max</sub>	1328cd	5	3.81	53

	3500K	H(m)	D(m)	Emax(lx)		
	Ra90			42°		
	Fixture Power	17W	1	0.76	1369	
	Source Flux	1548lm	2	1.52	342	
	Fixture Flux	849lm	3	2.29	152	
	Efficacy	50lm/W	4	3.05	86	
A6351	I <sub>max</sub> =885cd/klm	I <sub>max</sub>	1369cd	5	3.81	55

	4000K	H(m)	D(m)	Emax(lx)		
	Ra90			42°		
	Fixture Power	17W	1	0.76	1410	
	Source Flux	1594lm	2	1.52	352	
	Fixture Flux	874lm	3	2.29	157	
	Efficacy	51lm/W	4	3.05	88	
A6352	I <sub>max</sub> =884cd/klm	I <sub>max</sub>	1410cd	5	3.81	56